

Price Rs. 5,000.00/-

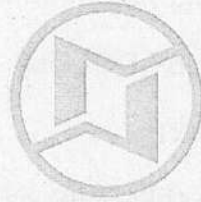

JAIPUR METRO

JAIPUR METRO RAIL CORPORATION LTD.

Open Competitive E-Bid Single Stage Two Envelope
(Technical Bid & Financial Bid) BID DOCUMENT

NIB No.:103/JMRC/O&S/Civil/Works/2023-24

"Removing of Loose Dry Sandstone Cladding and replacement with Plaster and Paint Work on exterior wall face of Civil Lines Metro Station, Downtake pipe work, Miscellaneous repair works on MSOR to BICP section of Jaipur Metro"



Jaipur Metro Rail Corporation Ltd.
Office of General Manager Civil

Room No-208, 2nd Floor, Admin Building,

Depot of Jaipur Metro, Bhriгу Path, Mansarovar, Jaipur-302020

Website: www.jmrc.co.in

TABLE OF CONTENT

SCHEDULE-A: NOTICE INVITING BID (NIB)	5
General:	5
1.0 NOTICE INVITING BID (NIB) KEY DETAILS:	5
2.0 CONTENTS OF BID DOCUMENT: -	11
SCHEDULE-B: INSTRUCTIONS TO BIDDERS (ITB)	13
1.1 GENERAL INFORMATION	13
1.2 SUBMISSION OF BIDS	14
1.3 AWARD OF CONTRACT	15
1.4 SIGNING OF AGREEMENT	15
1.5 PERFORMANCE SECURITY	15
1.6 OTHER TERMS & CONDITIONS: -	17
1.6.3 RTPP Act 2012 & RTPP Rules 2013:	19
SCHEDULE-C: - SPECIAL CONDITIONS OF CONTRACT (SCC)	20
1.0 SPECIAL ATTENTION	20
2.0 RIGHT OF WAY	20
3.0 COORDINATION WITH OTHER BIDDERS	20
4.0 SUFFICIENCY OF BID	20
5.0 NOTICES AND INSTRUCTIONS	20
6.0 SUPPLY OF MATERIALS TOOLS, AND EQUIPMENT BY THE EMPLOYER....	20
7.0 USE AND CARE OF SITE	20
8.0 DUTIES, TAXES, OCTROI, ROYALTY ETC	21
9.0 GST REGISTRATION CERTIFICATE	21
10.0 HOUSING FACILITIES:	21
11.0 ACCESS ROADS AND HAUL ROADS	21
12.0 DEDUCTIONS FROM BIDDER'S BILL	22
13.0 PROGRAM OF WORKS	22
14.0 SECURITY MEASURES	23

TABLE OF CONTENT

15.0 ECOLOGICAL BALANCE.....	23
16.0 BRIEF SCOPE OF WORK.....	24
17.0 PAYMENT	24
18.0 BIDDER'S OFFICE.....	24
19.0 NOISE AND DISTURBANCE/POLLUTION	25
20.0 ADVANCES.....	26
21.0 PRICE VARIATION CLAUSE.....	26
22.0 WATER SUPPLY AND ELECTRICITY	26
23.0 COMPLIANCES TO VARIOUS PROVISIONS OF ACTS:	26
24.0 RIGHT TO VARY QUANTITY (As per latest provisions of RTPPR, 2013).....	26
25.0 RETURNS OF SURPLUS MATERIAL.....	26
26.0 STORAGE OF DISMANTLED MATERIAL.....	26
27.0 MANDATORY REGISTRATION OF BIDDER.....	27
28.0 WORK NOT TO BE SUBLET.....	27
29.0 SCHEDULE OF INSPECTIONS.....	27
30.0 DIVIDING QUANTITIES AMONG MORE THAN ONE BIDDER AT THE TIME OF AWARD (IN CASE OF PROCUREMENT OF GOODS) (RULE-74 OF RTPPR-2013):	27
31.0 MATERIALS:.....	27
32.0 REJECTION:.....	28
33.0 WORKMANSHIP:.....	28
SCHEDULE-D: Other Relevant Document	29
1.0 General Condition of Contract:	29
2.0 Safety Health And Environment (SHE) Manual:	29
3.0 RTPP Act 2012 & RTPP Rules 2013:	29
4.0 Technical Specifications: -	29
SCHEDULE-E: - ANNEXURES	30
Annexure A: Compliance with the Code of Integrity and No Conflict of Interest.	30



TABLE OF CONTENT

Annexure B: Declaration by the Bidder regarding Qualifications	32
Annexure C: Grievance Redressal during Procurement Process	33
Annexure C1: Memorandum of Appeal under the Rajasthan Transparency in Public Procurement Act, 2012	35
Annexure D: Additional Conditions of Contract	36
Annexure E: INITIAL FILTER CRITERIA OF APPLICANT	37
Annexure F: CASE OF CONSORTIUM	38
Annexure G: CERTIFICATE/UNDERTAKING	39
Annexure X: CERTIFICATE BY CONTRACTOR ON ACCOUNT OF WORK EXECUTED FOR BILL	41
SCHEDULE-F: - FORMS	42
FORM A: FORM OF BID	42
FORM B: Certificate Of Conformity/No Deviation {to be filled by the Bidder}	45
FORM C: FORM OF PERFORMANCE SECURITY (GUARANTEE) BY BANK	46
Form D: FORM OF AGREEMENT:	48
FORM E : GENERAL INFORMATION	50
FORM F: Bidder Details: (as per Section 5.0 of of SCHEDULE-C: SCC of Bid)	52
FORM G: POWER OF ATTORNEY FOR SIGNING THE BID	53
Form-H: INDEMNITY	55
Form-I: Obligation/Compliance to be ensured by Bidder	57
SCHEDULE G: - PRICE BID / FINANCIAL BID	58
SCHEDULE-H: CHECKLIST FOR BID EVALUATION/BID SUBMISSION	59
SCHEDULE-I: Appendices	60





JAIPUR METRO

JAIPUR METRO RAIL CORPORATION LIMITED
General Manager (Civil), (Directorate of Operations & Systems)Room No-208, 2nd Floor, Admin Building,
Depot of Jaipur Metro, Bhargu Path, Mansarovar, Jaipur-302020
Tel. No. +917728895353/364 (Manager Civil), E-mail- mgrcivil@jaipurmetrorail.in**SCHEDULE-A: NOTICE INVITING BID (NIB)****General:**

- (i) Jaipur Metro Rail Corporation invites online Open competitive bids from interested and eligible agencies for "Removing of Loose Dry Sandstone Cladding and replacement with Plaster and Paint Work on exterior wall face of Civil Lines Metro Station, Downtake pipe work, Miscellaneous repair works on MSOR to BICP section of Jaipur Metro" This bid is invited under RTPPR Act-2012, and Rules, 2013.
- (ii) The complete bid document can be downloaded from the state e-procurement website <https://www.eproc.rajasthan.gov.in> and interested bidders will have to submit their offer in electronic formats both for technical and financial proposal on this website with their digital signatures. The complete bid document can also be seen on the Corporation's website <https://transport.rajasthan.gov.in/jmrc> and state public procurement portal i.e., <http://sppp.rajasthan.gov.in>.
- (iii) Bidders who wish to participate in this bidding process must register at <https://eproc.rajasthan.gov.in>. To participate in online Bids, as per the Information Technology Act, 2000, Bidders will have to obtain a Digital Signature Certificate (DSC) from any agency-approved by Controller of Certifying Authorities (CCA). Bidders who already have a Valid Digital Signature Certificate need not obtain a new Digital Signature Certificate. This DSC will be used by the bidder to digitally sign the bids before its online submission on E-Proc Portal. However, each page of the bid must be stamped and signed by the authorized signatory of the bidder firm as token of acceptance of the Bid Conditions.

1.0 NOTICE INVITING BID (NIB) KEY DETAILS:

(a)	Name & Address of the Procuring Entry	Name: - Director (O&S), Jaipur Metro Rail Corporation Ltd. Address: - Room No-208, 2nd Floor, Admin Building, Depot of Jaipur Metro, Bhargu Path, Mansarovar, Jaipur-302020. Email: dos@jaipurmetrorail.in
(b)	Subject Matter of Procurement. (Name of Work)	"Removing of Loose Dry Sandstone Cladding and replacement with Plaster and Paint Work on exterior wall face of Civil Lines Metro Station, Downtake pipe work, Miscellaneous repair works on MSOR to BICP section of Jaipur Metro"

(c)	Work completion Period	365 Days from the date of issue of LOA.
(d)	Defect Liability Period	12 Months from the date of work completion.
(e)	Bid Procedure	Single Stage Two Envelope (Technical Bid & Financial Bid)
(f)	Bid Evaluation Criteria	Technically Qualified and Lowest Rated Bidder (L-01)
(g)	Website for downloading Bidding Documents, Corrigendum, Addendums, etc.	https://www.eproc.rajabasthan.gov.in www.sppp.rajabasthan.gov.in transport.rajabasthan.gov.in/jmrc
(h)	Cost of Bid Form (Non-Refundable)	To participate in the bid, the bidder has to pay the cost of the bid form as below: - Cost of Bid Form: - Rs. 5,000.00/- Rupees. (DD/BC of scheduled bank payable in favour of Jaipur Metro Rail Corporation Limited)
(i)	Estimated procurement cost	INR ₹ 4,89,97,623.00 (Inclusive of all taxes and other charges)
(j)	Bid Security Deposit (EMD)	Amount (INR): 02% (Rs. ₹ 979,952.00/-) of Estimated Procurement Cost. (DD/BC of scheduled bank payable in favour of Jaipur Metro Rail Corporation Limited or as per RTPPR-2013).
(k)	E-Bid Processing Fee (Non-Refundable)	Rs. 2,000.00 /- by Demand Draft / Bankers Cheque, payable in favor of Managing Director, RISL . Payable at Jaipur
(l)	Venue of Physical Submission of Cost of Bid Form, Bid Security and E-Bid Processing Fee etc.	O/o General Manager (Civil), Jaipur Metro Rail Corporation Ltd. Address: - Room No-208, 2nd Floor, Admin Building, Depot of Jaipur Metro, Bhrigu Path, Mansarovar, Jaipur-302020 Mobile No:- +917728895353/364
(m)	Publishing Date on E-Proc Portal, SPPP Portal and JMRC Website.	Date: <u>12/03/2024</u> Time- <u>11:00</u> Hrs



**SCHEDULE-A: NOTICE INVITING
BID (NIB)**

103/JMRC/O&S/Civil/Works/2023-24

(n)	Document Sale/ Download/ Cost of Bid Form deposition period.	From Date: <u>12/03/24</u> Time- <u>11:00</u> Hrs
		To Date: <u>19/04/24</u> Time- <u>15:00</u> Hrs
(o)	Date and Time of Pre-bid meeting	Date: <u>19/03/24</u> Time: <u>12:00</u> Hrs
	Authority and Place for Pre-Bid Meeting.	Director (O&S), Chintan Room, Room No-206, 2nd Floor, Admin Building, Depot of Jaipur Metro, Bhriugu Path, Mansarovar, Jaipur-302020
	Last date for submission of queries to JMRC.	Date: <u>19/03/24</u> Time: <u>18:00</u> Hrs.
(p)	Date and time for issuance of Minutes of Pre-bid meeting on E-Proc Portal, SPPP Portal and JMRC Website.	Date: <u>26/03/2024</u> Time: <u>17:00 hrs</u>
(q)	Online Bid Submission Period on E-Proc Portal of Rajasthan Government.	From Date: <u>27/03/2024</u> Time- <u>11:00</u> Hrs
		To <u>19/04/2024</u> Date: Time- <u>15:00</u> Hrs
(r)	Online Technical Bid Opening Date and Time	Date: - <u>19/04/2024</u> Time: - <u>15:30</u> Hrs Venue: - O/o General Manager (Civil), Jaipur Metro Rail Corporation Ltd. Address: - Room No-208, 2nd Floor, Admin Building, Depot of Jaipur Metro, Bhriugu Path, Mansarovar, Jaipur-302020.
(s)	Bid Validity	90 days from the bid submission deadline.
(t)	PRE-QUALIFICATION CRITERIA (TECHNICAL BID)	
	Bidders Eligibility: -	Documents required to be submitted: -
	(i) Cost of Bid Form, Bid Security Deposit and E-Bid Processing Fee.	(i) As per Clause 1.0 (h), Clause 1.0 (j) and Clause 1.0 (k) in original to JMRC before the due date and time for the bid submission as per Clause 1.0 (l) & (q) of NIB of Bid Document.

<p>(ii) Similar Work: - The bidder firm should have experience of the execution of the work, "Construction/Repair and Maintenance of Civil Works" in residential or commercial buildings of 'State/Central Government Bodies' / PSU /Metro railways/Private Companies which are listed and have a turnover of more than 500 crores during the last 05 Years (reckoned from the date of last date of bid submission) and should have well-established capacity to execute the required work as per Clause 1.0 (b) of NIB of Bid Document.</p> <p>Work experience (physical requirement) shall be required as per detail given below:</p> <p>The bidder firm should have satisfactorily completed One similar works of at least 80% of the estimated cost of similar work i.e Rs 3.91 Crore /- OR Two similar works of at least 50% of the estimated cost of each costing Rs 2.45 Crore /- OR Three similar works of at least 40% of the estimated cost each costing Rs. 1.96 Crore/-. Work completion certificates are to be submitted accordingly.</p> <p>(iii) The bidder firm may be: - -Company registered under "Companies Act-1956/2013", OR - Registered Sole proprietor; OR - Registered Partnership/Joint Venture Firm. And must be in existence for the execution of similar works for a minimum period of 03 Years reckoned from the last day of the previous month to the month in which NIB was called.</p> <p>(iv) The Average Annual Turn Over of the bidder during any of the last preceding 03 audited financial years (i.e FY- 2020-21 to 2022-23) should not less than 100% of estimated cost i.e INR 4.89 Crore. In case of non-availability of audited balance sheet (Profit & Loss Account Statement)/published annual</p>	<p>(ii) For executed similar works in 'State/Central Government Bodies' /PSU/ Metro railways; self-certified copies of certificates for satisfactory work completion issued by the authorized person of the department/institution not below the rank of Executive Engineer during the last 05 Years reckoned from the date of last date of bid submission.</p> <p>OR</p> <p>For experience of work done with Private Firms, copy of work order, final paid bill and TDS certificate showing the amount credited shall also be submitted with self-certification along with Certificate/Undertaking (Annexure-G) of Schedule-E of Bid Document on Bidder's/Agency's letter head.</p> <p>(iii) Self-attested copy of registration document as proof of registered firm for the similar work.</p> <p>(Copy of Partnership deed or certificate of incorporation with memorandum of articles of association, Power of attorney/Board resolution (as applicable) in favour of bid signing authority.</p> <p>(iv) Self-Certified Certificate issued by Chartered Accountant (CA) for the "Annual Turn Over" of the Bidder. OR Self-certified Income Tax Return Documents (ITRs) & Audited Balance Sheets (Certified by a Chartered Accountant (CA)).</p>
--	--

<p>accounts of the preceding Financial Year, the audited balance sheet (P&L Statement)/published annual account of preceding FY 2019-20 to 2021-22 shall be taken into consideration.</p> <p>(v) Mandatory Registrations of the bidder such as "Goods & Service Tax (GST)" and Income Tax Registration.</p>	<p>(v) Self-Certified Copy of: - -GST Registration of Bidding Firm. -Copy of PAN Card.</p>
<p>Note:-</p> <p>(a) For Section clause t(iii) (above), in case of bidder is a consortium, the above documents shall be mandatorily submitted for all the constituent members.</p> <p>(b) The bidder is required to get its firm registered for EPF, ESI and Contract Labor license within 15 days of issuance of LOA. If the bidder does not get registered with these statutory Authorities then its 1st Running Account (R/A) payment shall not be released till it get registered with these Authorities. The firm is required to submit an undertaking in this regard on its letterhead.</p>	
<p>(u) ONLINE SUBMISSION OF BIDS: - Online bids will have to be digitally stamped and signed by the authorized signatory of the bidder firm and submitted in a time-stamped electronic sealed box on http://eproc.rajasthan.gov.in in the manner as below: The Bidder shall submit his signed and stamped bid online in two parts: -</p> <p>(i) First Part: - Technical Bid with all necessary documents in .pdf format (Self Certified/Signed by authorized Signatory of Firm) as per Clause 1.0 (t) of NIB, Scanned Copy of financial instruments such as Cost of Bid Form, E-Bid Processing Fee and Bid Security as per Clause 1.0 (h, j, k & l) of NIB, complete bid document as per Clause 1.1.1 of ITB of Bid Document (Except Schedule-G/Price Bid/BoQ).</p>	<p>(ii) Second Part: - Financial Bid in electronic format (.xls Format) to be submitted online through E-Proc Portal for Rajasthan Government to procuring entity of JMRC as per Clause 1.0 of NIB of Bid Document on or before the last date of bid submission.</p> <p>Note: -</p> <p>(i) Original Copy of DD/BC for Cost of Bid Form, E-bid Processing Fee & Bid Security as uploaded on E-Proc website is to be submitted at the office of JMRC before the due date of submission as per Clause-1.0 (l) & 1.0 (q) of NIB Document.</p> <p>(ii) The bidders have to take utmost care that the Financial Bid is to be submitted separately in the Second Part of the Bid i.e. Financial Bid on the E-Proc website only. If any details of the Financial Bid whether intentionally/ unintentionally/ by mistake are mentioned in the First Part i.e. Technical Bid by the bidder; then its bid shall not be considered by JMRC. No correspondence in such matter shall be entertained by</p>

	JMRC.
(v)	<p>POINTS TO BE NOTED:</p> <p>(i) Bidder (authorized signatory) shall submit their Two-Part Bid (First Part: -Technical Bid and Second Part: -Financial Bid) online on E-Proc website i.e. https://www.eproc.rajasthan.gov.in both for technical and financial proposals separately for each.</p> <p>(ii) In case, any of the bidders fails to pay the Cost of Bid form, E-Bid Processing Fee and Bid Security to JMRC, its Bid will not be considered and will be rejected.</p> <p>(iii) JMRC will not be responsible for the delay in Bid submission due to any reason.</p> <p>(iv) The procuring entity reserves the complete right to cancel the bid process and reject any or all the Bids.</p> <p>(v) Conditional Bid will be summarily rejected by JMRC.</p> <p>(vi) No contractual obligation whatsoever shall arise from the bidding document/ bidding process unless and until a formal contract is signed and executed between the procuring entity and the successful bidder.</p> <p>(vii) All Bidders are hereby cautioned that Bids containing any material deviation or reservation as described in Form-B and /or minor deviation without quoting the cost of withdrawal shall be considered as non-responsive and will be summarily rejected.</p> <p>(viii) Any Bid received with unattested cutting/ overwriting will be rejected.</p> <p>(ix) Procurement entity disclaims any factual/ or other errors in the bidding document (the onus is purely on the individual bidders to verify such information) and the information provided therein are intended only for the help the bidders to prepare a logical bid proposal.</p> <p>(x) The provisions of the RTPP Act 2012 and RTPPR-2013 Rules thereto shall be applicable for this procurement. Furthermore, in case of any inconsistency in any of the provisions of this bidding document with the RTPP Act 2012 and RTPPR-2013 Rules thereto, the later shall prevail. The RTPP Rules and ACT 2013 are available on the website of the finance department of Rajasthan i.e. https://finance.rajasthan.gov.in/</p> <p>(xi) Approved GCC is uploaded and available on the JMRC website i.e. https://transport.rajasthan.gov.in/jmrc, by signing the Bid Document, the firm agrees to accept the GCC. While framing the contract with the successful Bidder, the bidder shall sign the complete GCC document and submit it to the JMRC</p>

Director, (O&S) 
Jaipur Metro Rail Corporation Limited, Jaipur

2.0 CONTENTS OF BID DOCUMENT: -

Documents as listed below at SN. 2.1 to SN 2.8 (**Except SN-2.7; Schedule-G, Price Bid**) are to be attached separately with Notice Inviting Bid (NIB) in dully filled, stamped, and signed form as applicable to the bidder with the **Online Bid**.

2.1 SCHEDULE A: INFORMATION USEFUL FOR BIDDERS & SCOPE OF WORK:

The bidder should see the work site and fully understand the conditions of the work site before bidding and include all lead, lifts etc. for the material in his item rate/ percentage to be quoted on the rates as given in the SCHEDULE G: Price Bid/ Financial Bid. Then work shall be carried out to the entire satisfaction of the Engineer- In- Charge of the work.

2.2 SCHEDULE B: INSTRUCTIONS TO BIDDERS: - Attached Separately.

2.3 SCHEDULE C: SPECIAL CONDITIONS OF CONTRACT: Attached Separately.

2.4 SCHEDULE D: OTHER RELEVANT DOCUMENT

Approved GCC is uploaded and available on the JMRC website, by signing the Bid Document, the firm agrees to accept the GCC. While framing the contract with the successful Bidder, the bidder shall sign the complete GCC document and submit it to the JMRC. For detailed information, please refer to Schedule-D enclosed within the bid document.

2.5 SCHEDULE E: ANNEXURE: Attached Separately.

Annexure A: Compliance with the Code of Integrity and No Conflict of Interest.

Annexure B: Declaration by the Bidder regarding Qualifications.

Annexure C: Grievance Redressal during Procurement Process.

Annexure C1: Memorandum of Appeal under the Rajasthan Transparency in Public Procurement Act, 2012

Annexure D: Additional Conditions of Contract.

Annexure E: Initial filter criteria of the applicant.

Annexure F: Certificate by the Bidder to be appended with Annexure-E.

Annexure G: Certificate/Undertaking by the bidder as per RTPPA-2012. (On Bidder's Letter Head)

Annexure X: Certificate By Bidder with each Bill.

2.6 SCHEDULE F: FORMS: Attached Separately.

FORM-A: - Form of Bid with Appendix.

FORM-B: - Certificate of Conformity/No Deviation {to be filled by the Bidder}



FORM-C: - Form of Performance Security (Bank Guarantee) by Bank.

FORM-D: - Form of Agreement.

FORM-E: - General Information.

FORM -F: - Bidder's Bank Details.

FORM-G: - Power of Attorney.

FORM-H: - Indemnity certificate and obligation/ Compliance to be ensured by the Bidder.

2.7 SCHEDULE-G: - PRICE BID/FINANCIAL BID: -

Attached separately.

2.8 SCHEDULE-H: - Checklist for bid Evaluation/Submission:

Attached separately.

2.7 SCHEDULE-I: - appendices

Attached separately.

SIGNATURE OF CONTRACTOR

With full address & Mobile No.:

Director

Jaipur Metro Rail Corporation Ltd.,
Jaipur



SCHEDULE-B: INSTRUCTIONS TO BIDDERS (ITB)

1.1 GENERAL INFORMATION

1.1.1 Digitally Signed Online Bids are invited for the NIB No.: 103/JMRC/O&S/Civil/Works/2023-24 towards "Removing of Loose Dry Sandstone Cladding and replacement with Plaster and Paint Work on exterior wall face of Civil Lines Metro Station, Downtake pipe work, Miscellaneous repair works on MSOR to BICP section of Jaipur Metro" by Jaipur Metro Rail Corporation Limited, hereinafter called the 'Employer', for Works in accordance with this Bid Package. The Bid consists of the following documents, along with their Tables, appendices, addenda, corrigenda, and errata if any.

CONTENTS OF BID DOCUMENT: -

- (i) Notice Inviting Bid (NIB) - (Schedule-A)
- (ii) Instructions To Bidder (ITB) - (Schedule-B)
- (iii) Special Conditions of Contract (SCC) - (Schedule-C)
- (iv) General Conditions of Contract (GCC) - (Schedule-D)
- (v) Annexure (s) - (Schedule-E)
- (vi) Forms - (Schedule-F)
- (vii) Price Bid/ Financial Bid - Bill of Quantities (BOQ) - (Schedule-G)

Bids shall be prepared and submitted in accordance with the instructions given herein. This bid is under the RTPP Act 2012 & RTPP Rules, 2013.

1.1.2 The relevant address for correspondence relating to this Bid is given below:

General Manager (Civil), Jaipur Metro Rail Corporation LTD,
Room No-208, 2nd Floor, Admin Building,
Depot of Jaipur Metro, Bhriugu Path, Mansarovar, Jaipur-
302020

1.1.3 A Pre-Bid meeting shall be held on the date and location given in clause 1.0 (o) of the NIB.

1.1.3.1 The purpose of the meeting will be to clarify issues and to answer questions on any matters that may be raised at that stage.

1.1.3.2 The Bidder is requested to submit any question in writing or by facsimile, to reach the employer not later than the last date of seeking clarification as mentioned in key details of NIB.

1.1.3.3 The text of the questions raised by the Bids and the response given will be transmitted without delay to all purchasers of the Bids documents. Any modification of Bid documents, which may become necessary as a result of the Pre-Bid meeting shall be made by the employer exclusively the issue of an Addendum/clarification.

1.1.3.4 Non-attendance at the Pre-Bid/Pre-bid meeting will not be a cause for disqualification of a Bidder.

1.2 SUBMISSION OF BIDS

1.2.1 COST OF BID DOCUMENT:

1.2.1.1 The BID should be submitted in the prescribed Bid document, which may be purchased as per Clause 1.0 (h) of NIB of Bid Document.

1.2.1.2 The complete bid document can be downloaded from the website <https://www.eproc.rajasthan.gov.in>; <http://transport.rajasthan.gov.in/jmrc> or www.sppp.raj.nic.in. The cost of bid document is to be submitted in the form of DD/ Banker's Cheque etc as per Clause 1.0 (h & l) of NIB.

1.2.2 SEALING AND MARKING OF BIDS

Online bids will have to be digitally stamped and signed by the authorized signatory of bidder firm and submitted in a time stamped electronic sealed box on <http://eproc.rajasthan.gov.in> in the manner as described in Clause 1.0 (u) of NIB.

1.2.3 EVALUATION OF BID

1.2.3.1 The Employer, in accordance with Rule 63 of the RTPPR Rules 2013, will conduct a thorough technical evaluation of the submitted technical proposals to ascertain the bidder's comprehensive understanding of the contract requirements. In the event of a significant inadequacy in a Bidder's technical submission, the Bid will be deemed non-compliant and subsequently rejected. Please refer to Clause 1.0 (t) of the NIB, Clause 1.1.1 of the ITB within the Bid Document, and the relevant Forms and Annexures outlined in Schedule-E and Schedule-F of the Bid Document for further details.

1.2.3.2 All bids deemed technically acceptable will be eligible for consideration of their financial proposals. The firms that achieve technical qualification will be notified by the JMRC. The Employer, in accordance with Rule 65 of the RTPPR 2013, will conduct a comprehensive financial evaluation of the submitted financial proposals to ascertain the lowest bidder. Please refer to the relevant sections in the Bid Document for detailed information.

1.2.3.3 For price evaluation of Bid, the Total Overall Cost as quoted for the work of "Removing of Loose Dry Sandstone Cladding and replacement with Plaster and Paint Work on exterior wall face of Civil Lines Metro Station, Downtake pipe work, Miscellaneous repair works on MSOR to BICP section of Jaipur Metro" will be considered.

1.2.3.4 All offers shall be evaluated and marked L1, L2, L3 etc., L1 being the offer which is the least expensive offer.

1.2.4 NEGOTIATIONS

Subjected to Section 15 of RTPP Act and Rule 69 of RTPP Rules the procuring entity reserves the right to negotiate with the lowest and most advantageous bidder.

1.2.5 CORRECTION OF ERRORS: -

1.2.5.1 Bids determined to be technically acceptable after technical evaluation will be checked by the Engineer/ Employer for any arithmetical errors in computation and summation during financial evaluation. Errors will be corrected by the Employer.

1.2.5.2 If a Bidder does not accept the correction of errors as outlined above, his Bid may be rejected, and the Bid security shall be forfeited.

1.3 AWARD OF CONTRACT

1.3.1 AWARD CRITERIA

1.3.1.1 Employer will award, the Contract to the Bidder, whose Bid has been determined to be substantially responsive, technically & financially suitable, complete and in accordance with the Bid documents and whose evaluated bid price is determined to be lowest.

1.3.1.2 The "Letter of acceptance" will be uploaded on websites as per Clause 1.0 (g) of NIB, sent through E-Mail/Speed Post to the successful Bidder, who will return one copy to the Employer duly acknowledged and signed by the authorized signatory, within seven days of receipt of the same by him. No correspondence will be entertained by the Employer from the unsuccessful Bidder.

1.4 SIGNING OF AGREEMENT

1.4.1 The contractor shall prepare the Agreement on the non-judicial stamp as per the Rajasthan Stamp Act, in the Performa (Form D of Schedule-F) included in this Document, duly incorporating all the terms of agreement between the two parties. Within 15 days from the date of issue of the letter of acceptance, the successful Bidder will be required to execute the Contract Agreement. The performance security should be submitted immediately after the issue of the letter of acceptance but not later than the agreement is signed between the parties. One copy of the Agreement duly signed by the Employer and the contractor through their authorized signatories will be supplied by the Employer to the Contractor.

1.4.2 Prior to signing of the Contract Agreement, the successful bidder shall submit the following documents within a period of 15 days from the date of issue of the Letter of Acceptance:

- (a) Performance Security as per Clause 1.5 of ITB.
- (b) Power of Attorney (If required)
- (c) Detailed Consortium or Joint Venture Agreement (duly signed and executed) incorporating:
 - i. Percentage Participation of each member/partner.
 - ii. Joint and several liability of the partners.

1.5 PERFORMANCE SECURITY

1.5.1 The successful bidder shall furnish to the Employer a performance security in the form of a BG/BC or DD in the name of JMRC for an

amount equal to 10.0% of the total Contract Price, in accordance with Clause 4.2 of the General Conditions of Contract and rule 75 of RTPPR-2013. The validity of BG (If submitted) shall be beyond 60 days after the expiry of all contractual obligations. The Bank Guarantee has to be from a scheduled Commercial Bank based in India and the Form of Performance Security (Form C- Schedule-F) provided in this document shall be used. The Performance Security shall be furnished within the time limit specified in Clause 1.4.2 of ITB.

1.5.2 Alternatively, upon the successful bidder's request for the deduction of performance security, the Employer, in accordance with Rule 75 (3) (f) of the RTPPR, may permit the Bidder to submit the performance security amount (equivalent to 10.0% of the total contract price) through deductions from each running and final bill, calculated at a rate of 10.0% of the bill amount. This deduction will continue until the entire performance security amount is deposited. In the event that the total performance security has not been received by the submission of the final bill, any outstanding balance of the performance security will be deducted from the final bill to ensure full compliance with the performance security requirement.

1.5.3 In case of the successful bidder, the amount of bid security may be adjusted in arriving at the amount of the performance security, or refunded if the successful bidder furnishes the full amount of performance security.

1.5.4 The Performance Security shall be refunded to the contractor after satisfactory completion of the entire work. The Performance Security shall be forfeited by the Procuring Entity when work is not completed within stipulated period by the contractor.

1.5.5 Additional Performance Security: -

1.5.5.1 In addition to Performance Security as specified in rule 75 of RTPPR-2013, an Additional Performance Security shall also be taken from the successful bidder in case of unbalanced bid. The Additional Performance Security shall be equal to fifty percent of Unbalanced Bid Amount. The Additional Performance Security shall be deposited in lump sum by the successful bidder before execution of Agreement. The Additional Performance Security shall be deposited through Demand Draft, Banker's Cheque, or Bank Guarantee in favour of "Jaipur Metro Rail Corporation Limited".

Explanation: For the purpose of this rule: -

- (i) Unbalanced Bid means any bid below more than fifteen percent of Estimated Bid Value.
- (ii) Estimated Bid Value means value of subject matter of procurement mention in bidding documents by the Procuring Entity.
- (iii) Unbalanced Bid Amount means positive difference of eighty five percent of Estimated Bid Value minus Bid Amount Quoted by the bidder.

1.5.5.2 The Additional Performance security amount shall be refunded to the contractor after satisfactory completion of the entire work. The Additional Performance shall be forfeited by the Procuring Entity when work is not completed within stipulated period by the contractor.

1.5.6 Should the successful bidder fail to furnish both the required Performance Security and any additional performance security (if applicable), such failure shall serve as adequate grounds for the annulment of the Contract award and the forfeiture of the bid security. Furthermore, in the event that the successful bidder does not commence the contracted work for any reason following the issuance of the Letter of Award (LOA) in accordance with the terms and conditions outlined in the Bid, the LOA shall be revoked. As a consequence, the Performance Security and any additional performance security (if applicable), or the Bid Security equivalent to the sum of the Performance Security and any additional performance security (if applicable), shall be subject to forfeiture.

1.5.7 Performance security shall be furnished in any one of the following forms:

- (a) Bank Draft or Banker's Cheque of a scheduled bank;
- (b) Bank guarantee or electronic bank guarantee (e-BG) of a scheduled bank. It shall be got verified from the issuing bank. Other conditions regarding bank guarantee shall be same as mentioned in the bidding document for Bid Security. Government of Rajasthan amended the Rajasthan Stamp Act, 1998 vide finance bill 2015 and inserted Article 13-A, which provides that bank guarantee executed by a bank as a surety to secure the due performance of a contract or due discharge of a liability for this stamp duty is payable @ 0.25% of the amount secured subjected to a maximum of Rs. 25000/-.
- (c) Fixed Deposit Receipt (FDR) of a scheduled bank. It shall be in the name of procuring entity on account of Bidder and discharged by the Bidder in advance. The procuring entity shall ensure before accepting the FDR that the Bidder furnishes an undertaking from the bank to make payment/ premature payment of the FDR on demand to the procuring entity without requirement of consent of the Bidder concerned. In the event of forfeiture of the performance security, the Fixed Deposit shall be forfeited along with interest earned on such Fixed Deposit.

1.6 OTHER TERMS & CONDITIONS: -

1.6.1 PAYMENT:

1.6.1.1 Payment will be made on actual work executed after satisfactory completion of works as per the issued work orders by JMRC under this works contract. the submitted GST-Invoice/Bills shall be accepted after certification by the JE Works In-Charge on face of bill, confirming the actual work's compliance with BOQ specifications and amount of bill is

as per recorded measurement in Measurement Book mentioning with MB Number and Page Number.

1.6.1.2 Upon submission of each bill, 80% of the bill amount shall be disbursed. In standard circumstances, the remaining 20% of the amount will be released promptly. However, in the event that the JE Works In-Charge identifies pending aspects, such as the need for verification of works through Material Testing Certificates, Testing Certificates (if required) by an NABL accredited testing lab, obtaining NOC from other concerned wings of JMRC (if required), comprehensive site cleaning to ensure the absence of personnel, materials, and equipment, and successful testing and commissioning of the works in accordance with the details submitted by the contractor to JMRC, the release of the 20% balance amount will be at the discretion of the JE Works In-Charge. Importantly, *if the 20% amount is withheld, it will only be released upon further clearance certification by the JE Works In-Charge, signifying satisfactory resolution of the identified pending aspects.*

1.6.1.3 No advance is payable.

1.6.1.4 GST-Invoice/Bills, correct in all respect, shall be submitted in the favor of Jaipur Metro Rail Corporation Limited, Jaipur with bank details in duplicate along with the acceptance certificate and relevant documents, if any, for arranging payment.

1.6.1.5 Necessary and applicable statutory deductions from the bill/invoice amount shall be done by JMRC on account of Labour Welfare Cess as per BOCW Welfare Cess Act-1996 (Minimum 01% on bill amount and maximum up to 02% of bill amount as per latest guidelines issued by Govt. of Rajasthan) and TDS etc.

1.6.2 OTHER CONDITIONS:

1.6.2.1 Prices are inclusive of Manpower, Material, Tools, Transportation, all taxes & duties etc.

1.6.2.2 No tools and Plants shall be issued to contractor by JMRC.

1.6.2.3 Only authorized staff of contractor having proper identity card issued by the contractor/firm shall be permitted to enter in JMRC Site Premises.

1.6.2.4 The work should be carried out without causing any hindrance to the users.

1.6.2.5 If the contractor fails to perform/executed the work satisfactorily, the contract may be terminated at any time without assigning any reason to the contractor.

1.6.2.6 The JMRC shall have the right to make minor alterations/additions/substitution in the scope of work or issue instructions that may be deemed necessary during the period of the contract and contractor shall carry out the work in accordance with the instructions which may be given to him by authorized JMRC's representative.

1.6.2.7 JMRC's General conditions of contract shall be applicable.

1.6.3 RTPP Act 2012 & RTPP Rules 2013:

"The Rajasthan Transparency in Public Procurement Act, 2012 and the "The Rajasthan Transparency Public Procurement Rules, 2013" under the said act have come into force which are available on the website of State Public Procurement Portal <http://sppp.rajasthan.gov.in>. The Bidders are advised to acquaint themselves with the provisions of the Act and the rules before participating in the Bidding process. If there is any discrepancy between the provisions of the Act and the Rules and this Bidding document, the provisions of the Act and the Rules shall prevail".



SCHEDULE-C: - SPECIAL CONDITIONS OF CONTRACT (SCC)

1.0 SPECIAL ATTENTION

The Contract will be awarded as per RTPP Act-2012 and RTPP Rules, 2013, to the Bidder whose responsive bid is determined to be eligible and lowest rated as per the terms and conditions of bid document.

2.0 RIGHT OF WAY

Right of way (within JMRC land) to the work site will be provided to the Bidder by the Engineer-In-Charge.

3.0 COORDINATION WITH OTHER BIDDERS

The bidder for this package shall plan and execute work in coordination and in Co-operation with other bidders working for adjacent/other packages, under intimation to the Engineer-In-Charge.

4.0 SUFFICIENCY OF BID

- 4.1 The Bidder shall be entirely responsible for sufficiency of rates quoted by him in his bid.
- 4.2 The Bidder (Successful Bidder) shall be paid for only at quoted/accepted rates.

5.0 NOTICES AND INSTRUCTIONS

The Bidder shall furnish to the Employer/Engineer the postal address of his office at Jaipur and working E-Mail address. Any notice or instructions to be given to the Bidder under the terms of the contract shall be deemed to have been served on him if it has been delivered to his authorized agent or representative at site or if it has been sent by registered post to the office, or to the address of the firm last furnished by the Bidder or if conveyed by the E-Mail from the authorized email.

6.0 SUPPLY OF MATERIALS TOOLS, AND EQUIPMENT BY THE EMPLOYER

No material, tools, and equipment shall be supplied by the Employer. The Bidder has to arrange all tools, equipment, materials etc. required for the work. The Bidder shall have to identify sources for supply of all materials and get them approved by the Engineer-In-Charge before the use. The Bidder shall submit the sample to the Engineer-In-Charge and shall use only after the sample is approved. Nothing extra shall be payable to the Bidder on this account.

7.0 USE AND CARE OF SITE

- 7.1 The Bidder shall not demolish, remove or alter structures or other facilities on the site without prior approval of the Engineer-In-Charge.

- 7.2 All garbage/debris shall be removed from site daily or as they accumulate. All garbage/debris shall be disposed to the approved locations in covered position. The necessary materials required i.e. cartoons/ dustbins etc to be provided by the bidder at his cost. The transportation for disposing the debris shall also be arranged by the bidder.
- 7.3 All surrounding surface and sub-soil drains shall be maintained in a clean, sound and satisfactory state of performance.
- 7.4 Necessary permissions/approval of the Employer's representative shall be obtained before carryout the work.
- 7.5 **ACCIDENTS: -**
It shall be the entire responsibility of the bidder to adopt all the safety measures and deploy the personnel who are adequately trained in safety. If any accident occurs within the JMRC jurisdiction while carrying out the works or due to negligence on the part of the bidder's personnel, it shall be the full responsibility of the bidder.

8.0 DUTIES, TAXES, OCTROI, ROYALTY ETC

- 8.1 The rates quoted by the Bidder for all materials, required to be purchased for the satisfactory performance of this contract, shall be deemed to be inclusive of all duties, taxes, octroi, royalties, rentals etc.
- 8.2 The Bidder shall ensure full compliance with tax laws of India with regard to this contract and shall be solely responsible for the same. He shall submit copies of acknowledgements evidencing filing of returns every year and shall keep the Employer fully indemnified against liability of tax, interest, penalty etc, of the Bidder's in respect thereof, which may arise.

9.0 GST REGISTRATION CERTIFICATE

If the Bidder is a GST assessee, he should produce a valid GST Registration Certificate; otherwise, payment to the Bidder may be withheld.

10.0 HOUSING FACILITIES:

(Supplemental to Clause 6.6 of "General Conditions of Contract")

The Bidder shall have to make his own arrangements for housing facilities for his staff.

11.0 ACCESS ROADS AND HAUL ROADS

- 11.1 Existing roads and other public roads may be used by the Bidder to carry out works with prior approval of the competent authority. The Bidder shall pay the statutory vehicle license and permit fees for use of public roads.



- 11.2 The Bidder shall repair any damage to the road or bear the cost thereof due to movement of bidder's plants and equipment, vehicles etc. to the specifications and satisfaction of road authorities as well as of Engineer.

12.0 DEDUCTIONS FROM BIDDER'S BILL

- 12.1 **Tax Deduction at Source (TDS):** The Employer shall deduct Tax at Source (TDS) from each on-account progress bill in accordance with the provisions of relevant statutes, acts of statutory bodies, and local authorities.
- 12.2 **Statutory Deductions for Labour Welfare Cess:** JMRCL shall make necessary deductions from the bill/invoice amount on account of Labour Welfare Cess as per the provisions of the Building and Other Construction Workers Welfare Cess Act-1996. The deduction shall range from a minimum of 01% to a maximum of 02% of the bill amount, subjected to the latest guidelines issued by the Government of Rajasthan.
- 12.3 **Other Deductions:** Any other deductions, if applicable, shall be made in accordance with the provisions outlined in Section 1.6.1.2 of Instructions To Bidders (ITB) and Section 13.3 of Schedule-C: Special Conditions of Contract (SCC).

13.0 PROGRAM OF WORKS

- 13.1 The period of contract is as per Clause 1.0 (c.) of NIB. However, the work should be started immediately after the issue of LOA or as per the directions contained in LOA.
- 13.2 The bidder should work round the clock if required. The major activities which are affecting the traffic are to be done at non-operational hours i.e. in night shift.

13.3 PENALTY

- 13.3.1 Penalty for non-attending the works within the minimum specified time as mentioned for the different works after issue of instructions by the competent authority or incomplete work or for the poor quality of works will be levied up to the rate of 10% of the following:
- 13.3.1.1 In Case of Item Rate Contract, Total Cost of work as per Work order
- 13.3.1.2 In Case of contract other than Item rate contract, the total Contract Price.
- 13.3.1.3 In Case of Termination of Works Contract/ item rate contract, the total Contract Price.
- 13.3.2 Repeated failure by the bidder to attend to the works within specified time period may lead to termination of contract. The penalty shall be preceded with proper show cause notice. The penalty once levied may be reviewed by the authority next higher to the authority who has levied penalty on written submission by the bidder within 15 days of levy of penalty.

- 13.3.3 This penalty shall not relieve the bidder from his obligation to execute the works or from any other of his obligations and liabilities under the contract.
- 13.3.4 The Bidder shall co-ordinate his programme to the extent feasible with the programmers of other bidders to be engaged at the site or in the vicinity of the site, as furnished by the Engineer so that the works can be carryout as per the overall program.
- 13.3.5 0.015% of contract price per day of delay in completion of work as per time period of completion mentioned in work orders.
- 13.3.6 In cases where the entire bid security, performance security, or any substitute thereof is forfeited by the procuring entity in relation to a procurement process or contract termination, the bidder may face debarment from participating in any future procurement processes conducted by the procuring entity. The duration of this debarment period shall not exceed three years.

14.0 SECURITY MEASURES

- 14.1 Security arrangements for the work shall be in accordance with general requirements and the Bidder shall confirm to such requirements and shall be held responsible for the action or inaction on the part of his staff, employees.
- 14.2 Bidders' employees and representatives shall wear Identification Badges/ ID Cards, helmets, gum boots, approved uniform and other safety/protection wear as directed by incharge, and to be provided by the Bidder. Badges shall identify the Bidder and show the employee's name and number and shall be worn at all times while at site.
- 14.3 All vehicles used by the Bidder shall be clearly marked with the Bidder's name or identification mark.

15.0 ECOLOGICAL BALANCE

- 15.1 The Bidder shall maintain ecological balance by preventing deforestation, water pollution and defacing of natural landscape. The Bidder shall, so conduct his works activities, as to prevent any avoidable destruction, scarring or defacing of natural surroundings in the vicinity of work. In respect of ecological balance, the Bidder shall observe the following instructions.
- 15.2 Where destruction, scarring, damage or defacing may occur as a result of operations relating to works activities, the same shall be repaired, replanted or otherwise corrected at Bidder's expenses. All work areas shall be smoothened and graded in a manner to conform to natural appearance of the landscape as directed by the Engineer.

- (a) All trees/plants and shrubbery, which are not specifically required to be cleared or removed for works purposes,

shall be preserved and shall be protected from any damage that may be caused by Bidder's maintenance activities. The removal of trees/plants or shrubs may be permitted only after prior approval by the Engineer-In-Charge. Trees/plants shall not be used for anchorage. The Bidder shall be responsible for injuries to trees/plants and shrubs caused by his operations. The term "injury" shall include, without limitation, bruising, scarring, tearing and breaking of roots, trunks or branches etc. All injured trees and shrubs shall be restored as nearly as practicable, without delay, to their original condition at Bidder's expenses.

- (b) In the conduct of works activities and operation of equipment, the Bidder shall utilize such practicable methods and devices as are reasonably available to control prevent and otherwise minimize air/noise pollution.

- 15.3 Separate payment shall not be made for complying with provisions of this clause and all cost shall be deemed to have been included in the price in the Bill of Quantities.

16.0 BRIEF SCOPE OF WORK

Brief scope of work is included in Schedule-G of Bid document.

17.0 PAYMENT

- 17.1 For the purpose of On-account payment, the bidder shall submit detailed activities carried out as per Work orders recorded in Measurement sheets, Abstract sheets along with recorded bill for the item actually executed for checking and payment. Payment will be based on unit rates as approved in the Bill of Quantities.
- 17.2 The bidder ~~has to submit~~ self-certified copies of vouchers showing quantity of materials brought to site for in charge's record.
- 17.3 If any activities not carried out as per the work order the applicable amount may be deducted from the payable bill amount or performance security/bid security etc. If the work carried out through other agency under the intimation to the bidder and the charges incurred on it may be deducted from the bidder's bill. In addition, the applicable penalty may be levied as per Clause 13.3 of SCC.
- 17.4 The payment shall be made on actual work done basis for the activities carried out as per the work orders. At the time of billing, the bidder shall submit necessary documents and Bill in the standard format for payment.

18.0 BIDDER'S OFFICE

- 18.1 The Bidder shall establish an office in Jaipur in consultation with the in charge for planning, co-ordination and monitoring the progress of the Work and intimate the same in writing to incharge.

18.2 In addition, the Bidder shall also set up field offices at convenient and approved locations for co-ordination and for monitoring the progress of work at his own cost. The office shall be manned by bidder staff consisting of one supervisor (graduate Civil Engineer with 3 years' experience/Recognized Diploma Holder in Civil Engineering with 05 years' experience). The contractor has to submit the details/certificates of his supervisor to Manager (Civil) immediately after award of LOA. The contact numbers of contractor's representative shall be intimated in writing to GM Civil/O&S or his authorized representative.

18.3 One "Site Order Book / Progress Monitoring register" shall be maintained at field office.

18.4 Monthly Progress Report:

18.4.1 The Bidder shall maintain a Monthly Progress Report throughout the duration of the project. This report shall be duly verified by a representative of JMRC (Jaipur Metro Rail Corporation) and submitted as and when required.

18.4.2 The Monthly Progress Report should provide a comprehensive overview of the work progress during the specified time period. It should include details on milestones achieved, work completed, resources utilized, and any challenges or delays encountered.

18.4.3 JMRC reserves the right to request the Monthly Progress Report at any time to assess the work status and ensure compliance with the agreed-upon timelines and deliverables. The report should be submitted promptly upon request, allowing sufficient time for verification and assessment by JMRC.

18.4.4 The Bidder is responsible for ensuring the accuracy and transparency of the Monthly Progress Report. It should be prepared in a clear and concise manner, utilizing appropriate formats and standardized templates specified by JMRC.

18.4.5 Failure to maintain and submit the Monthly Progress Report as required may result in penalties, contract termination, or other appropriate actions as deemed fit by JMRC.

18.4.6 It is important for the Bidder to keep accurate records, collaborate with JMRC representatives, and facilitate the verification process in relation to the Monthly Progress Report.

18.4.7 This provision regarding the Monthly Progress Report shall remain in effect throughout the duration of the contract, unless otherwise specified by JMRC in writing.

19.0 NOISE AND DISTURBANCE/POLLUTION

19.1 All works shall be carried out without unreasonable noise and disturbance. The Bidder shall indemnify and keep indemnified the Employer from and against any liability for damages on account of noise or other disturbance created while carrying out the work, and from and

against all claims, demands, proceedings, damages, costs, charges, and expenses, whatsoever, in regard or in relation to such liability.

- 19.2 Subject and without prejudice to any other provision of the Contract and the law of the land and its obligation as applicable, the Bidder shall take all reasonable precautions.

20.0 ADVANCES

No advances shall be paid to the Bidder.

21.0 PRICE VARIATION CLAUSE

Price variations clause is not applicable in this contract.

22.0 WATER SUPPLY AND ELECTRICITY

Water supply and electricity may be provided by JMRC if possible, as per site condition only after the approval of authority of JMRC.

23.0 COMPLIANCES TO VARIOUS PROVISIONS OF ACTS:

The bidder shall comply with all the provisions of the Minimum Wages Act, 1948, The Building and Other Construction Workers (Regulation of Employment and Condition of Service) Act 1996 and Contract Labour (Regulation and Abolition) Act, 1970, EPF act, ESI Act etc as applicable and amended from time to time and rules framed there-under and other labour laws affecting contract labour that may be brought into force from time to time.

24.0 RIGHT TO VARY QUANTITY (As per latest provisions of RTPPR, 2013)

Bidder is to carry out their self-assessment in respect of their capacity in terms of manpower, machinery, materials and finance. He is to indicate separate set of manpower, machinery, materials in different bids. Once a bid is accepted, resources required for its execution shall not be considered for assessment of other bid. **The bidder is required to consider right of JMRC to vary quantities as per latest provisions of RTPPR 2013 (Rule-73) as amended from time to time.**

25.0 RETURNS OF SURPLUS MATERIAL

Surplus material provided by the bidder at the start of this contract for maintaining inventory will be the property of bidder and is to be removed within 07 days after completion of work. After expiry of 07 days, charges for the space occupancy may be charged from bidder @ 500 /- per day per inventory.

26.0 STORAGE OF DISMANTLED MATERIAL

Storage of dismantled materials will be the responsibility of bidder. Dismantled material so accumulated is to be submitted to **STORES** of JMRC at DCOS Building at Metro Train Depot of JMRC at Bhriugu Path

Mansarovar, Jaipur on the risk and cost of bidder after getting written permission from O/o Engineer-in-charge.

27.0 MANDATORY REGISTRATION OF BIDDER

The bidder should be registered for "Goods and Service Tax" (GST).

28.0 WORK NOT TO BE SUBLET

The work should not be sublet, the written approval of Procuring Entity (PE) is required.

29.0 SCHEDULE OF INSPECTIONS

The work site shall be inspected jointly by bidders and JMRC representative and inspection note shall be issued jointly. All the defects appearing in inspection note shall be rectified within specified time or DLP. The Performa of Inspection shall be provided by Engineer-In-Charge.

30.0 DIVIDING QUANTITIES AMONG MORE THAN ONE BIDDER AT THE TIME OF AWARD (IN CASE OF PROCUREMENT OF GOODS) (RULE-74 OF RTPPR-2013):

As a general rule all the quantities of the subject matter of procurement shall be procured from the Bidder, whose Bid is accepted. However, when it is considered that the quantity of the subject matter of procurement to be procured is very large and it may not be in the capacity of the Bidder, whose Bid is accepted, to deliver the entire quantity or when it is considered that the subject matter of procurement to be procured is of critical and vital nature, in such cases, the quantity may be divided between the Bidder, whose Bid is accepted and the second lowest Bidder or even more Bidders in that order, in a fair, transparent and equitable manner at the rates of the Bidder, whose Bid is accepted.

31.0 MATERIALS:**31.1 Quality:**

31.1.1 All materials used in the works shall be of the quality of their respective kinds as specified in RPWD specifications/Equivalent to approved list of material, obtained from sources and suppliers approved by the Engineer and shall comply strictly with the tests prescribed in the Technical Specifications/Codes of Practice (RPWD/CPWD/IRC/IS Codes etc) as per the directions of Engineer-In-Charge.

31.1.2 All materials used in JAIPUR METRO RAIL CORPORATION LTD. stations premises and mainline viaduct and underground tunnel section during construction stage are approved materials. In addition, to materials used to construct JAIPUR METRO RAIL CORPORATION LTD. Bidders are advised to refer list of additional approved sources/ vendors of material attached as Appendix-01. Of this Bid Document.

31.2 SAMPLING AND TESTING:

- 31.2.1 In addition to Test certificates, samples of all materials proposed to be employed in permanent works shall be submitted to the Engineer when called for. In such cases, materials will not be brought to the site without prior approval of the Engineer.
- 31.2.2 Samples provided to the Engineer are to be labelled in boxes suitable for storage. Materials or workmanship, not corresponding in character and quality with approved samples, will be rejected by the Engineer.
- 31.2.3 Samples required for approval and testing must be supplied at least 45 days in advance to allow for testing and approval. Delay to the works arising from the late submission of samples will not be acceptable as a reason for delay in completion of the works.
- 31.2.4 The bidder shall bear all expenses for sampling and testing, whether at the manufacturer's premises, at the source, on-site, or at any testing laboratory or institution as directed by the Engineer. It is explicitly stated that JAIPUR METRO RAIL CORPORATION LTD will not bear any costs associated with these activities in any case, the bidder shall solely be responsible for covering all associated testing charges.

32.0 REJECTION:

Any materials that have been found not to conform to the specifications will be rejected forthwith and shall be removed from the site by the bidder at its own cost within 15 days.

33.0 WORKMANSHIP:

All works shall be true to level, plumb and square and the corner, edges and arises in all cases shall be unbroken and neat and shall be as per provisions in the relevant Technical Specifications / Standard Codes of Practices. Bidder shall also submit Quality Assurance Programme and Methods Statements for special works to be done within 07 days before the start of work for approval of Engineer-in-Charge.



SCHEDULE-D: Other Relevant Document

1.0 General Condition of Contract:

Approved GCC is uploaded and available on the JMRC website i.e. <https://transport.rajasthan.gov.in/jmrc>, by signing the Bid Document, firm agrees to accept the GCC. While framing the contract with the successful Bidder, the bidder shall sign the complete GCC document and submit it to the JMRC.

2.0 Safety Health And Environment (SHE) Manual:

Approved **Safety Health and Environment (SHE) Manual** is uploaded and available on the JMRC website i.e. <https://transport.rajasthan.gov.in/jmrc>, by signing the Bid Document, firm agrees to accept the GCC.

3.0 RTPP Act 2012 & RTPP Rules 2013:

The provisions of RTPP Act 2012 and RTPPR-2013 Rules thereto shall be applicable for this procurement. Furthermore, in case of any inconsistency in any of the provisions of this bidding document with the RTPP Act 2012 and RTPPR-2013 Rules thereto, the later shall prevail. The RTPP Rules and ACT 2013 is available on the website of finance department of Rajasthan i.e. <https://finance.rajasthan.gov.in/>

4.0 Technical Specifications: -

RPWD Specifications/CPWD Specifications/IRC/IS Code/RUIDP ISOR etc. and provisions of Codes/Specifications/ Manual are applicable for these works and work should be carried out as per these specifications and manual. Crane or Hydra if required to be used for various works at height in JMRC premises shall be of 1st Generation or equivalent category as per the directions of Engineer-In-Charge. Relevant document is available to concern department website.



SCHEDULE-E: - ANNEXURES**Annexure A: Compliance with the Code of Integrity and No Conflict of Interest**

Any person participating in a procurement process shall -

- a. Not offer any bribe, reward or gift or any material benefit either directly or indirectly in exchange for an unfair advantage in procurement process or to otherwise influence the procurement process;
- b. Not misrepresent or omit that misleads or attempts to mislead so as to obtain a financial or other benefit or avoid an obligation;
- c. Not indulge in any collusion, Bid rigging or anti-competitive behavior to impair the transparency, fairness and progress of the procurement process;
- d. Not misuse any information shared between the procuring Entity and the Bidders with an intent to gain unfair advantage in the procurement process;
- e. Not indulge in any coercion including impairing or harming or threatening to do the same, directly or indirectly, to any party or to its property to influence the procurement process;
- f. Not obstruct any investigation or audit of a procurement process;
- g. Disclose conflict of interest, if any; and
- h. Disclose any previous transgressions with any Entity in India or any other country during the last three years or any debarment by any other procuring entity.

Conflict of Interest: -

The Bidder participating in a bidding process must not have a Conflict of Interest. A Conflict of Interest is considered to be a situation in which a party has interests that could improperly influence that party's performance of official duties or responsibilities, contractual obligations, or compliance with applicable laws and regulations.

- i. A Bidder may be considered to be in Conflict of Interest with one or more parties in a bidding process if, including but not limited to:
 - a. have controlling partners/ shareholders in common; or
 - b. receive or have received any direct or indirect subsidy from any of them; or
 - c. have the same legal representative for purposes of the Bid; or
 - d. have a relationship with each other, directly or through common third parties, that puts them in a position to have access to information about or influence on the Bid of another Bidder, or influence the decisions of the Procuring Entity regarding the bidding process; or
 - e. the Bidder participates in more than one Bid in a bidding process. Participation by a Bidder in more than one Bid will result in the disqualification of all Bids in which the Bidder is involved. However, this does not limit the inclusion of the same subcontractor, not otherwise participating as a Bidder, in more than one Bid; or
 - f. the Bidder or any of its affiliates participated as a consultant in the preparation of the design or technical

- specifications of the Goods, Works or Services that are the subject of the Bid; or
- g. Bidder or any of its affiliates has been hired (or is proposed to be hired) by the Procuring Entity as engineer-in-charge/consultant for the contract.

Annexure B: Declaration by the Bidder regarding Qualifications**Declaration by the Bidder**

In relation to my/our Bid submitted to for procurement of in response to their Notice Inviting Bids No..... Dated I/we hereby declare under Section 7 of Rajasthan Transparency in Public Procurement Act, 2012, that:

I/we possess the necessary professional, technical, financial and managerial resources and competence required by the Bidding Document issued by the Procuring Entity;

I/we have fulfilled my/our obligation to pay such of the taxes payable to the Union and the State Government or any local authority as specified in the Bidding Document;

3. I/we are not insolvent, in receivership, bankrupt or being wound up, not have my/our affairs administered by a court or a judicial officer, not have my/our business activities suspended and not the subject of legal proceedings for any of the foregoing reasons;
4. I/we do not have, and our directors and officers not have, been convicted of any criminal offence related to my/our professional conduct or the making of false statements or misrepresentations as to my/our qualifications to enter into a procurement contract within a period of three years preceding the commencement of this procurement process, or not have been otherwise disqualified pursuant to debarment proceedings.
5. I/we do not have a conflict of interest as specified in the Act, Rules and the Bidding Document, which materially affects fair competition;

Date:

Place:

Signature of bidder

Name

Designation: _____

Address:



Annexure C: Grievance Redressal during Procurement Process

The designation and address of the First Appellate Authority is MD/CMD, JMRC, JMRC.

The designation and address of the Second Appellate Authority is Chairman/Board, JMRC.

(1) Filing an appeal:

If any Bidder or prospective bidder is aggrieved that any decision, action or omission of the Procuring Entity is in contravention to the provisions of the Act or the Rules or the Guidelines issued there under, he may file an appeal to First Appellate Authority, as specified in the Bidding Document within a period of ten days from the date of such decision or action, omission, as the case may be, clearly giving the specific ground or grounds on which he feels aggrieved:

Provided that after the declaration of a Bidder as successful the appeal may be filed only by a Bidder who has participated in procurement proceedings:

Provided further that in case a Procuring Entity evaluates the Technical Bids before the opening of the Financial Bids, an appeal related to the matter of Financial Bids may be filed only by a Bidder whose Technical Bid is found to be acceptable.

- (2) The officer to whom an appeal is filed under para (1) shall deal with the appeal as expeditiously as possible and shall endeavor to dispose it of within thirty days from the date of the appeal.
- (3) If the officer designated under para (1) fails to dispose of the appeal filed within the period specified in para (2), or if the Bidder or prospective bidder or the Procuring Entity is aggrieved by the order passed by the First Appellate Authority, the Bidder or prospective bidder or the Procuring Entity, as the case may be, may file a second appeal to Second Appellate Authority specified in the Bidding Document in this behalf within fifteen days from the expiry of the period specified in para (2) or of the date of receipt of the order passed by the First Appellate Authority, as the case may be.

(4) Appeal not to be in certain cases

No appeal shall lie against any decision of the Procuring Entity relating to the following matters, namely: -

- (a) determination of need of procurement;
- (b) provisions limiting participation of Bidders in the Bid process;
- (c) the decision of whether or not to enter into negotiations;
- (d) cancellation of a procurement process;
- (e) Applicability of the provisions of confidentiality.



Form of Appeal

- (a) An appeal under para (1) or (3) above shall be in the annexed Form along with as many copies as there are respondents in the appeal.
 - (b) Every appeal shall be accompanied by an order appealed against, if any, affidavit verifying the facts stated in the appeal and proof of payment of fee.
 - (c) Every appeal may be presented to First Appellate Authority or Second Appellate Authority, as the case may be, in person or through registered post or authorized representative.
- (6) Fee for filing appeal**
- (a) Fee for first appeal shall be rupees two thousand five hundred and for second appeal shall be rupees ten thousand, which shall be non-refundable.
 - (b) The fee shall be paid in the form of bank demand draft or banker's cheque of a Scheduled Bank in India payable in the name of Appellate Authority concerned.
- (7) Procedure for disposal of appeal**
- (a) The First Appellate Authority or Second Appellate Authority, as the case may be, upon filing of appeal, shall issue notice accompanied by copy of appeal, affidavit and documents, if any, to the respondents and fix date of hearing.
 - (b) On the date fixed for hearing, the First Appellate Authority or Second Appellate Authority, as the case may be, shall, -
 - (i) Hear all the parties to appeal present before him; and
 - (ii) Peruse or inspect documents, relevant records or copies thereof relating to the matter.
 - (c) After hearing the parties, perusal or inspection of documents and relevant records or copies thereof relating to the matter, the Appellate Authority concerned shall pass an order in writing and provide the copy of order to the parties to appeal free of cost.
 - (d) The order passed under sub-clause (c) above shall also be placed on the State Public Procurement Portal.



FORM No. 1

[See rule 83]

**Annexure C1: Memorandum of Appeal under the Rajasthan Transparency in
Public Procurement Act, 2012**

Appeal No..... of.....

Before the..... (First / Second Appellate Authority)

1. Particulars of appellant:

- (i) Name of the appellant
- (ii) Official address, if any:
- (iii) Residential address:

2. Name and address of the respondent

- (i)
- (ii)
- (iii)

Number and date of the order appealed against and name and designation of the officer / authority who passed the order (enclose copy), or a statement of a decision, action or omission of the Procuring Entity in contravention to the provisions of the Act by which the appellant is aggrieved:

- 4. If the Appellant proposes to be represented by a representative, the name and postal address of the representative:
- 5. Number of affidavits and documents enclosed with the appeal:
- 6. Grounds of appeal:

.....
..... (Supported by an affidavit).

7. Prayer.....

..... Place.....

Date

Appellant's Signature



Annexure D: Additional Conditions of Contract**1. Correction of arithmetical errors (Rule-64 of RTPPR-2013)**

Provided that the Financial Bid is substantially responsive, the Procuring Entity will correct arithmetical errors during evaluation of Financial Bids on the following basis:

- i. If there is a discrepancy between the unit price and the total price that is obtained by multiplying the unit price and quantity, the unit price shall prevail and the total price shall be corrected, unless in the option of the Procuring Entity there is an obvious misplacement of the decimal point in the unit price, in which case the total price as quoted shall govern and the unit price shall be corrected;
- ii. If there is an error in total corresponding to the addition or subtraction of subtotals, the subtotals shall prevail and the total shall be corrected; and
- iii. If there is a discrepancy between words and figures, the amount in words shall prevail, unless the amount expressed in words is related to an arithmetic error, in which case the amount in figures shall prevail subjected to (i) and (ii) above

If the Bidder that submitted the lowest evaluated Bid does not accepted the correction of errors, its Bid shall be disqualified and its Bid Security shall be forfeited or its Bid Securing Declaration shall be executed.

2. Deleted**3. Dividing quantities among more than one Bidder at the time of award (In case of procurement of Goods) (Rule-74 of RTPPR-2013)**

As a general rule all the quantities of the subject matter of procurement shall be procured from the Bidder, whose Bid is accepted. However, when it is considered that the quantity of the subject matter of procurement to be procured is very large and it may not be in the capacity of the Bidder, whose Bid is accepted, to deliver the entire quantity or when it is considered that the subject matter of procurement to be procured is of critical and vital nature, in such cases, the quantity may be divided between the Bidder, whose Bid is accepted and the second lowest Bidder or even more Bidders in that order, in a fair, transparent and equitable manner at the rates of the Bidder, whose Bid is accepted.



Annexure E: INITIAL FILTER CRITERIA OF APPLICANT

[ON COMPANY'S LETTER HEAD (EACH MEMBER IN CASE OF CONSORTIUM)]

Name of the Applicant: _____

S/N	Criteria	Yes	No
1.	Has the Applicant abandoned any work in the last 03 years?		
2.	Has the Bidder contract with any organization ever been terminated due to poor performance?		
3.	Has the Bidder Security Deposit for any contract ever been forfeited by any Govt./ Semi Govt./ PSU/ MRTS/ Corporate houses?		
4.	Has the Applicant been involved in frequent litigations in the last three years?		
5.	Has the Applicant suffered bankruptcy / insolvency in the last three years?		
6.	Has the Applicant been blacklisted by any organization?		
7.	Has any misleading information been given in the application?		
8.	Is the Applicant financially not sound to perform the work?		
9.	Is the Applicant's Net Worth negative?		
10.*	Has the applicant failed to certify that no agent / middleman has been or will be engaged or that any agency or commission has been or will be paid?		
11.*	Do the documents submitted by the applicant reveal that agency commission has been or will be paid?		

NOTE: -

"YES" answer to any of the questions from 1 to 11 will disqualify the Applicant.

* Blank Pro-forma of the Certificate is there at Annexure-F. The same should be completed and submitted along with the bid submission.

Dated _____

Signature of the Bidder
or his Authorized signatory
with seal of the Firm



Annexure F: CASE OF CONSORTIUM

[ON COMPANY'S LETTER HEAD (EACH MEMBER IN CASE OF CONSORTIUM)]

I, Mr./Ms. _____ (Authorized Signatory)* on behalf of _____ (Company's Name) having its registered office at _____, hereby confirm and declare that no agent, middleman or any intermediary has been, or will be engaged by me to provide any services, or any other item or work related to the award and performance of this contract. I further confirm and declare that no agency commission or any payment which may be construed as an agency commission has been, or will be paid by me and that the bid price will not include any such amount.

(Signature) _____

Name of signatory _____

Capacity of signatory _____

* Should be supported by authorized Power of Attorney in favour of authorized signatory along with their copy of Board Resolution.



Annexure G: CERTIFICATE/UNDERTAKING**G1.0 CERTIFICATE/UNDERTAKING****CERTIFICATE/UNDERTAKING**

(As per RTPP Act-2012; Section-07 (2) ((a) to (e))

(On Bidder's/Firm's Letter Head)

We certify that our organization: -

- (a) possess the necessary professional, technical, financial and managerial resources and competence required as per the bidding documents, pre-qualification documents or bidder registration documents, as the case may be, issued by the procuring entity;
- (b) have fulfilled his obligation to pay such of the taxes payable to the Central Government or the State Government or any local authority as may be specified in the bidding documents, pre-qualification documents or bidder registration documents;
- (c) not be insolvent, in receivership, bankrupt or being wound up, not have its affairs administered by a court or a judicial officer, not have its business activities suspended and must not be the subject of legal proceedings for any of the foregoing reasons;
- (d) not have, and their directors and officers not have, been convicted of any criminal offence related to their professional conduct or the making of false statements or misrepresentations as to their qualifications to enter into a procurement contract within a period of three years preceding the commencement of the procurement process, or not have been otherwise disqualified pursuant to debarment proceedings;
- (e) Not have a conflict of interest as may be prescribed and specified in the pre-qualification documents, bidder registration documents or bidding documents, which materially affects fair competition.

We undertake that we shall open our office in Jaipur before issue of LOA/NTP.

Date

Signature

Place

Name

Designation

Seal of Authorized Signatory

Signature of Authorized Signatory with Seal



G2.0 CERTIFICATE/UNDERTAKING :**UNDERTAKING**

(As per clause 1.0 (u) Note (b) of NIB)

1. I/we M/s..... hereby submit that presently my/ our firm is not registered with any or all of the authorities as mentioned below: -

S. No	Registration For	Registered or Not registered
(a)	GST Registration	
(b)	Employees Provident Fund	
(c)	Employee State Insurance	
(d)	Contract Labor License under contract Labor Regulation and Abolition Act 1970	

2. I hereby undertake that within 15 days of issuance of LOA by JMRC, we shall get registered with the authorities concerned for above mentioned registrations please.

Signature of Authorized Signatory with Seal



Annexure X: CERTIFICATE BY CONTRACTOR ON ACCOUNT OF WORK EXECUTED FOR BILL

Name of Work:- "Removing of Loose Dry Sandstone Cladding and replacement with Plaster and Paint Work on exterior wall face of Civil Lines Metro Station, Downtake pipe work, Miscellaneous repair works on MSOR to BICP section of Jaipur Metro"

NIB No.103/JMRC/O&S/Civil/Works/2023-24

Dated: _____

Agreement No.:- _____

ON ACCOUNT OF WORK EXECUTED FOR _____ BILL

CERTIFICATE BY CONTRACTOR

1. In compliance of latest provision of the Minimum Wages Act, 1948 and rules made there under in respect of any employee engaged by us, I/We declare that laborer engaged by me/us have been fully paid for. In the event of any outstanding due to be payable to any labor/laborers the corporation is entitled to recover the same from any money due to or occurring to the contractor in consideration payment to such laborer.
2. Certified that all valid insurance policies as per GCC Clause are available.
3. Certified that EPF, Payment of Wages Act, 1948, Workman Compensation Act-1923, contract Labor Act-1938, BOCW Welfare Cess Act 1996 and Factories Act-1948 have been given compliance.
4. Certified that we accept the measurement recorded at site as per Measurement Sheets MB No-_____ at Page No-_____ enclosed are correct and final under the work order and shall have no claim whatsoever later against the work done so far.

Name of Contractor _____

Full Postal Address: _____

Date: _____

Place: _____

SIGNATURE & STAMP OF THE CONTRACTOR



SCHEDULE-F: - FORMS

FORM A: FORM OF BID

A.1

Note: i. The Appendix and forms are part of the Bid

ii. Bidders are required to fill up all the blank spaces in this Form of Bid and Appendix.

Name of Work: - "Removing of Loose Dry Sandstone Cladding and replacement with Plaster and Paint Work on exterior wall face of Civil Lines Metro Station, Downtake pipe work, Miscellaneous repair works on MSOR to BICP section of Jaipur Metro"

To

Director, Jaipur Metro Rail Corporation Ltd.
Room No-208, 2nd Floor, Admin Building,
Depot of Jaipur Metro, Bhriгу Path, Mansarovar, Jaipur-302020

Having visited the site and examined the General Conditions of Contract (Available on JMRC's Website) as well as Special Conditions of Contract, Specifications, Instructions to Bidders, for the execution of above named works, we the undersigned, offer to execute and complete such works and remedy defects therein in conformity with the said Conditions of Contract, Specifications, and Addenda.

1. We acknowledge that the Appendix forms an integral part of the Bid.
2. We undertake, if our Bid is accepted, to commence the works within as per Letter of Acceptance to complete the whole of the Works comprised in the Contract.
3. If our Bid is accepted, we will furnish at our option a Bank Guarantee for Performance as security for the due performance of the Contract. The amount and form of such guarantee or bond will be in accordance with Clause 4.2 of the General Conditions of the Contract and as indicated in the Appendix.
4. We have independently considered the amount shown Clause 8.5 of the General Conditions of Contract as liquidated damages and agree that they represent a fair estimate of the damages likely to be suffered by you in the event of the work not being completed in time.
5. We agree to abide by this Bid for a minimum period of 90 days from the date fixed for receiving the same and it shall remain binding upon us and may be accepted at any time before the expiry of that period or any extended period mutually agreed to.
6. Unless and until a formal Agreement is prepared and executed, this Bid, together with your written acceptance thereof, shall constitute a binding contract between us.
7. We declare that the submission of this Bid confirms that no agent, middleman or any intermediary has been, or will be engaged to provide any services, or any other item of work related to the award and performance of this Contract. We further confirm and declare that no agency commission or

any payment, which may be construed as an agency commission has been, or will be, paid and that the bid price does not include any such amount.

8. We acknowledge the right of the Employer, if he finds to the contrary, to declare our Bid to be non-compliant and if the Contract has been awarded to declare the Contract null and void.
9. We understand that you are not bound to accept the lowest or any bid you may receive.
10. If our Bid is accepted, we understand that we are to be held solely responsible for the due performance of the Contract.

Dated this.....day of..... 202__

Signature

Name..... in the capacity of

Duly authorized to sign Bids for and on behalf of.....

Address

Witness – Signature

Name

Address

Occupation



A2.

S.No	Details	Clause/Section	Condition of Contract
I	Amount of Performance Security	Section 1.5 of SCHEDULE-B: Instructions to Bidders (ITB) of Bid.	10.0% percent of the Contract Price
II	Liquidated Damages	(i) Section 13.3 of SCHEDULE-C: SCC of Bid. (ii) Clause 8.5 of the GCC	As per the directions contained in respective clause/section.
III	Minimum amount of Third-Party Insurance	15.3 of General Conditions of Contract	As per the directions contained in respective clause/section.
IV	Period for commencement of work from the date of issue of work orders	1.0 (c) of Notice Inviting Bid	As per the directions contained in LOA.
V	Contract Period from the date of commencement of work	1.0 (c) of Notice Inviting Bid	365 Days
VI	Penalty for Non completion of work or poor quality or work as decided by the engineer.	Applicable Clauses of General Conditions of Contract (GCC) and Special Conditions of Work (SCC).	As per Applicable Clauses of General Conditions of Contract (GCC) and Special Conditions of Work (SCC).
VI	Penalty for violating the safety norms or for causing any accident or causing any interference in Train operation due to his work		Shall be levied as worked out by the JMRC. In addition to these necessary legal actions can be also taken as per the statutory Rules & Laws applicable.

Signature of authorized _____

Signatory on behalf of Bidder

Date

Name

Place

Address



FORM B: Certificate Of Conformity/No Deviation {to be filled by the Bidder}

Director
Jaipur Metro Rail Corporation
Room No-208, 2nd Floor, Admin Building,
Depot of Jaipur Metro, Bhrigu Path,
Mansarovar, Jaipur-302020

To,

CERTIFICATE

This is to certify that, the specifications of Services / Items which I/ We have mentioned in the Technical bid, and which I/ We shall supply if I/ We am/ are awarded with the work, are in conformity with the minimum specifications of the bidding document and that there are no deviations of any kind from the requirement specifications.

Also, I/ we have thoroughly read the bidding document and by signing this certificate, we hereby submit our token of unconditional acceptance to all the terms & conditions of the bidding document without any deviations.

I/ We also certify that the price I/ we have quoted is inclusive of all the cost factors involved in the end-to-end implementation and execution of the project, to meet the desired Standards set out in the bidding Document.

Thanking you,

Name of the Bidder: -

Authorized Signatory: -

Seal of the Organization: -

Date: _____

Place: _____



FORM C: FORM OF PERFORMANCE SECURITY (GUARANTEE) BY BANK

*(On stamp Value as per latest Fees Master available at
<https://igrs.rajasthan.gov.in/>)

1. This deed of Guarantee made this day of _____ between Bank of _____ (hereinafter called the "Bank") of the one part, and Jaipur Metro Rail Corporation Limited (hereinafter called "the Employer") of the other part.
2. Whereas Jaipur Metro Rail Corporation limited has awarded the contract for "Removing of Loose Dry Sandstone Cladding and replacement with Plaster and Paint Work on exterior wall face of Civil Lines Metro Station, Downtake pipe work, Miscellaneous repair works on MSOR to BICP section of Jaipur Metro" of JAIPUR METRO RAIL CORPORATION at Jaipur. Contract for ----- Rail Corridor of Jaipur Metro Rail Corporation (hereinafter called "the contract") to M/s _____ (Name of the Bidder) _____ (hereinafter called "the Bidder").
3. AND WHEREAS the Bidder is bound by the said Contract to submit to the Employer a Performance Security for a total amount of Rs. _____ (Amount in figures and words).
4. Now we the Undersigned _____ (Name of the Bank) being fully authorized to sign and to incur obligations for and on behalf of and in the name of _____ (Full name of Bank), hereby declare that the said Bank will guarantee the Employer the full amount of Rs. _____ (Amount in figures and Words) as stated above.
5. After the Bidder has signed the aforementioned Contract with the Employer, the Bank is engaged to pay the Employer, any amount up to and inclusive of the aforementioned full amount upon written order from the Employer without assigning any reason. The Bank will deliver the money required by the Employer immediately on demand without delay without reference to the Bidder and without the necessity of a previous notice or of judicial or administrative procedures and without it being necessary to prove to the Bank the liability or damages resulting from any defects or shortcomings or debts of the Bidder. The Bank shall pay to the Employer any money so demanded notwithstanding any dispute/disputes raised by the Bidder in any suit or proceedings pending before any Court, Tribunal or Arbitrator/s relating thereto and the liability under this guarantee shall be absolute and unequivocal.
6. This Guarantee is valid for a period of 60 Days beyond the completion of all contractual obligations.
7. At any time during the period in which this Guarantee is still valid, if the Employer agrees to grant a time extension to the Bidder or if the Bidder fails to complete the Works within the time of completion as stated in the Contract, or fails to discharge himself of the liability or damages or debts as stated under Para 5, above, it is understood that the Bank will extend

this Guarantee under the same conditions for the required time on demand by the Employer and at the cost of the Bidder.

8. The Guarantee hereinbefore contained shall not be affected by any change in the Constitution of the Bank or of the Bidder.
9. The neglect or forbearance of the Employer in enforcement of payment of any moneys, the payment whereof is intended to be hereby secured or the giving of time by the Employer for the payment hereof shall in no way relieve the bank of their liability under this deed.
10. The expressions "the Employer", "the Bank" and "the Bidder" hereinbefore used shall include their respective successors and assigns.

In witness whereof I/We of the bank have signed and sealed this guarantee on the _____ day of _____ (Month) 2023-24 being herewith duly authorized.

For and on behalf of
the _____ Bank.

Signature of authorized Bank official

Name:

Designation:

I.D. No.:

Stamp/Seal of the Bank:

Signed, sealed and delivered _____

for and on behalf of the Bank

by the above named _____

In the presence of:

Witness 1.

Signature

Name

Address

Witness 2.

Signature

Name

Address

Note: * To be deleted on Final Print



Form D: FORM OF AGREEMENT:

This Agreement is made on the _____ day of _____ 202__ Between Jaipur Metro Rail Corporation Limited, Administrative Building, Depot of Jaipur Metro, Bhriku Path, Mansarovar, Jaipur-302020 hereinafter called "the Employer" of the one part and _____ (Name and Address of Bidder) _____ hereinafter called "the Bidder" of the other part.

Whereas the Employer is desirous that (***) certain Goods and Services should be provided and) certain Works should be executed, viz **"Removing of Loose Dry Sandstone Cladding and replacement with Plaster and Paint Work on exterior wall face of Civil Lines Metro Station, Downtake pipe work, Miscellaneous repair works on MSOR to BICP section of Jaipur Metro"** of JAIPUR METRO RAIL CORPORATION at Jaipur, hereinafter called "the Works" and has accepted a Bid by the Bidder for the execution and completion of such works (***) as well as guarantee of such works) and the remedying of defects therein.

This agreement is signed between Mr. _____ (for and on behalf of the employer) and Mr. _____ (for and on behalf of the contractor)

NOW THIS AGREEMENT WITNESS as follows:

1. In this Agreement words and expression shall have the same meanings as are respectively assigned to them in the Conditions of Contract hereinafter referred to.
2. The following documents shall be deemed to form and be read and construed as part of this Agreement, viz:
 - (a) Letter of acceptance.
 - (b) Bill of Quantities.
 - (c) Addendums, if any
 - (d) Bid Document.
 - (e) Form of Bid with Appendix.
 - (f) General Conditions of Contract
 - (g) Other Conditions agreed to and documented as listed below:
 - i. Bidder's Work Schedule as amended if required.
 - ii. Statement of deviations (If applicable)
 - iii. Any other item as applicable.
3. In consideration of the payments to be made by the Employer to the Bidder as hereinafter mentioned, the Bidder hereby covenants with the Employer to execute and complete the works by or extended work/DLP completion date, if any, and remedy any defects therein in conformity in all respects with the provisions of the Contract.
4. The Employer hereby covenants to pay the Bidder in consideration of the execution and completion of the works and the remedying of defects therein, the Contract Price of **Rs_____ being the sum stated in the letter of acceptance subject to such additions thereto or deductions there from as may be made under the provisions of the Contract at the times and in the manner prescribed by the Contract.



5. OBLIGATION OF THE BIDDER

The Bidder shall ensure full compliance with tax laws of India with regard to this contract and shall be solely responsible for the same. The Bidder shall submit copies of acknowledgements evidencing filing of returns every year and shall keep the Employer fully indemnified against liability of tax, interest, penalty etc. of the Bidder in respect thereof, which may arise.

The staff/labour recruited by the Bidder for "Removing of Loose Dry Sandstone Cladding and replacement with Plaster and Paint Work on exterior wall face of Civil Lines Metro Station, Downtake pipe work, Miscellaneous repair works on MSOR to BICP section of Jaipur Metro" of JAIPUR METRO RAIL CORPORATION at Jaipur will be the sole responsibility of the Bidder and JMRC will not be involved in it in any way. The staff / labour so recruited by the Bidder will not have any right whatsoever at any stage to claim employment in JMRC.

6. JURISDICTION OF COURT

The Courts at Jaipur shall have the exclusive jurisdiction to try all disputes arising out of this agreement between the parties.

IN WITNESS WHEREOF the parties hereto have caused their respective Common Seals to be hereunto affixed / (or have hereunto set their respective hands and seals) the day and year first above written.

For and on behalf of the
Bidder

For and on behalf of the
Employer

Signature of the authorized
official

Signature of the authorized
official

Name of the official

Name of the official

Stamp/Seal of the Bidder

Stamp/Seal of the Employer

SIGNED, SEALED AND DELIVERED

By the said _____
Name _____
on behalf of the Bidder in the
presence of:
Witness _____
Name _____
Address _____

By the said _____
Name _____
on behalf of the Employer
in the presence of:
Witness _____
Name _____
Address _____

Note :

- * To be made out by the Employer at the time of finalization of the Form of Agreement.
- ** Blanks to be filled by the Employer at the time of finalization of the Form of Agreement.
- *** to be deleted if not applicable

FORM E : GENERAL INFORMATION**GENERAL INFORMATION****Notes:**

Attach an attested photocopy of Certificate of Registration and ownership as well as of Constitution and legal status.

- I. *In case of Joint Venture / Consortium, attach an attested photocopy of Agreement indicating inter alia distribution of responsibilities among the members / constituents.*

1 Bidder Company details (in case of consortium, details of Lead Partner)

- (a) Name of Bidder Company:
- (b) Address of the corporate headquarters and its branch office(s), if any, in India:
- (c) Date of incorporation and/ or commencement of business:

2 Particulars of the Authorised Signatory of the Applicant:

- (a) Name:
- (b) Designation:
- (c) Address:
- (d) Phone Number:
- (e) Fax Number:

3 PAN Number (Attach photocopy):

4 GST Registration No. (attach copy of the registration certificate):

5 In the case of a consortium:

a. Names of participating members / constituents

- (a)
- (b)
- (c)

b. Address, telephone, Tele-fax and email of each members / constituent.

Registered Office

Office for correspondence

- (a) _____
- (b) _____
- (c) _____

c. Distribution of responsibilities among partners / constituents. (Among other details, specify the sub-items of works for which each of the partners / constituents would be responsible).

d. Date and place of joint Venture/ Consortium Agreement.

- e. Names and Addresses of Bankers to the Joint Venture/ Consortium.
- f. Names and Addresses of Associated Companies to be involved in the Project and whether Parent / subsidiary/ others.
- g. If the company is subsidiary, what involvement, if any, will the Parent Company have in the Project?



FORM F: Bidder Details: (as per Section 5.0 of of SCHEDULE-C: SCC of Bid)**1. Postal Address:**

Line-1:	
Line-2:	
District/City:	State:
Pin Code:	Tele/Fax:
Mobile No.:	

2. Email-Mail Address:

--

3. BANK DETAILS FOR E-PAYMENT

Beneficiary name :

Beneficiary Address :

Line-1:	
Line-2:	
District/City:	State:
Pin Code:	Tele/Fax:
Mobile alert:	

Bank Details:

Bank Name:	
Branch Name and Address:	
Beneficiary A/C No.	Beneficiary A/C Type (Saving/Current):
Beneficiary A/c Name:	
Nine - Digit branch MICR Code:	
IFSC Code of the branch:	

Note: - Bidders may also enclose self-certified copy of cancelled cheque in name of bidding firm.



FORM G: POWER OF ATTORNEY FOR SIGNING THE BID**POWER OF ATTORNEY FOR SIGNING THE BID**

Know all men by these presents, we..... (name of the firm and address of the registered office) do here by irrevocably constitute, nominate, appoint and authorize Mr./Ms.(name)..... Son/daughter/wife of..... and presently residing at....., who is presently employed with us and holding the position of.....as our true and lawful attorney (hereinafter referred to as the "Attorney")to do in our name and on our behalf, all such acts, deeds and things as are necessary or required in connection with or incidental to submission of our NIB No.: **103/JMRC/O&S/Civil/Works/2023-24** for qualification and submission of our Bid for the works **"Removing of Loose Dry Sandstone Cladding and replacement with Plaster and Paint Work on exterior wall face of Civil Lines Metro Station, Downtake pipe work, Miscellaneous repair works on MSOR to BICP section of Jaipur Metro"**, including but not limited to signing and submission of all Bids, bids and other documents and writings, and other conferences and providing information/ responses to JMRC, representing us in all matters before JMRC, signing and execution of all contracts including the Contract and undertakings consequent to acceptance of our bids, and generally dealing with the JMRC in all matters in connection with or relating to or arising out of our Bid for the said Projects and/or upon award thereof thousand /or till the entering into of the Contracts with JMRC.

AND we hereby agree to ratify and confirm and do hereby ratify and confirm all acts, deeds and things lawfully done or caused to be done by our said Attorney pursuant to and in exercise of the powers conferred by this Power of Attorney and that all acts, deeds and things done by our said Attorney in exercise of the powers hereby conferred shall and shall always be deemed to have been done us. IN WITNESS WHEREOF WE,THE ABOVE-NAMED PRINCIPAL HAVE EXECUTED THIS POWER OF ATTORNEY ON THISDAY OF.....,202__.

For (Signature)

(Name, Title and Address) Witnesses:

Accepted

.....Signature)

(Name, Title and Address of the Attorney)

(Notarized)

Notes:

The mode of execution of the Power of Attorney should be in accordance with the procedure, if any, laid down by the applicable law and the charter documents of the executants and when it is so required, the same should be under common

seal affixed in accordance with the required procedure. Also, wherever required, the Applicant should submit for verification the extract of the charter documents and documents such as a resolution/power of attorney in favors of the person executing this Power of Attorney for the delegation of power hereunder on behalf of the Applicant.



Form-H: INDEMNITY

INDEMNITY

(To be filled by Bidder)

I on behalf of M/shereby agree and undertake that I have understood all the safety rules and procedures and all staff working on behalf of M/swill abide by all safety rules and procedures. I declare that I M/s will be responsible for any safety violation/accident etc. and JMRC will not be responsible in case of any accident and will not compensate financially or otherwise. I M/s.....declare that all the claim raised by staff deputed by me, shall be borne by me only.

I hereby declare that I am sole responsible on behalf of M/s..... for giving such declaration.

.....
Name of Indemnifier.....
Signature of Indemnifier

Stamp/seal of the Indemnifier/Bidder

INDEMNITY

(To be filled by Bidder staff individually)

I hereby agree and undertake that I have understood all the safety rules and procedures and I will abide by all safety rules and procedures. I declare that I will be responsible for any safety violations/accident etc. and JMRC will not be responsible in case of any accident/incident and will not compensate financially or otherwise. I shall not raise any claim against JMRC.

.....

Name of Indemnifier

.....

Signature of Indemnifier

.....

NAME OF BIDDER

.....

SIGNATURE OF BIDDER

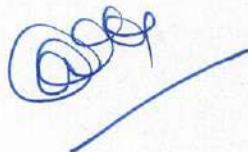

Form-I: Obligation/Compliance to be ensured by Bidder

S.No.	Items	Compliance of Bidder (To be filled by Bidder)	
		Yes	No
1	License for employing contract labour		
2	Compliance of minimum wages Act by payment of wage on 7 th of every month through Bank or in the presence of nominated representative of employer (JMRC Supervisor/manager)		
3 (a)	Compliance of provision of ESI & EPF.		
3 (b)	Ensure treatment in ESI hospital in case of accident/injuries suffered in performance of work and compensation under ESI Act.		
4	In case of accident occurs then, send Accident report to Regional Labour Commissioner (RLC) & ESI authorities.		
5	Observance of working hours, weekly rest and overtime payments as per minimum wages Act-1948.		
6	Other statutory requirement pertaining to this bid.		

Note: - "If any section is filled with 'No' and is determined by the procuring entity to be related to the scope of work, the procuring entity may, at its discretion, declare the bidder non-eligible for further participation in the bidding process."

Signature with seal of Bidder/Proprietor



SCHEDULE G: - PRICE BID/FINANCIAL BID

1. The bidders have to take utmost care that the Financial Bid is to be submitted separately in Second Part of Bid i.e Financial Bid on E-Proc website only. If any details of Financial Bid whether intentionally/ unintentionally/ by mistake are mentioned in First Part i.e Technical Bid by the bidder; then its bid shall not be considered by JMRC. No correspondence in such matter shall be entertained by JMRC.
2. However, the illustrative BoQ Sample has been enclosed herewith as Appendix-02.
3. Certain items listed in the Bill of Quantities (BoQ) are subject to fabrication requirements outlined in specific drawings. The details of these fabrication drawings are provided in Appendix-03, which is attached herewith. Bidders are strongly encouraged to thoroughly review all included drawings to gain a comprehensive understanding and clarity regarding the fabrication specifications outlined therein.



SCHEDULE-H: CHECKLIST FOR BID EVALUATION/BID SUBMISSION

S/N	Item	Bid Stipulations (if any)	Submission/ Compliance Requirement	Remarks
1.0	Details of (i) Cost of Bid Form/Document (ii) Bid Security/EMD (iii) E-Bid Processing Fee			
1.1	Bid Document Cost in the form of DD/BC.	1.0 (h, j, k) of the NIB		
1.2	Name of Issuing Bank and Branch			
1.3	DD/BC No.			
1.4	DD/BC Date			
1.5	Value of DD/BC			
2.0	TECHNICAL SUITABILITY: - Eligibility and Qualification of Bidder: -			
2.1	Bid is from a Company: Firm registration certificate in Govt. departments for Civil Works.	Clause 1.0 (t) of (NIB)		
2.2	Whether registration with GST is enclosed by Bidder.	Clause 1.0 (t) of (NIB)		
2.3	Complete Bid Document, NIB, ITB, SCC etc.	Complete Bid Document. (Clause 1.1.1 of ITB)		
2.4	Various Annexure (s) under Schedule-E	As per Bid Document- SCHEDULE -E		
2.5	Various Forms under Schedule-F	As per Bid Document- SCHEDULE-F		
3.0	PRICE BID: Whether Online Commercial Bid/BOQ submitted by the bidder.	SCHEDULE-G		
4.0	Check List of submitted documents in Technical and Financial Bid.	Schedule-H		

Note: -

- (i) Original Copy of DD/BC for Cost of Bid Form, E-bid Processing Fee & Bid Security along with Hard Copy of the same signed and stamped Technical Bid Documents (First Part) as uploaded on E-Proc website may also be submitted at the office of JMRC before the due date of submission as per Clause-1.0 (l) of NIB Document.
- (ii) The bidders have to take utmost care that the Financial Bid is to be submitted separately in Second Part of Bid i.e Financial Bid on E-Proc website only. If any details of Financial Bid whether intentionally/ unintentionally/ by mistake are mentioned in First Part i.e Technical Bid by the bidder; then its bid shall not be considered by JMRC. No correspondence in such matter shall be entertained by JMRC.

SCHEDULE-I: Appendices

Appendix No.	Particulars	Page No.	
		From	To
Appendix-01	Approved Manufacturers List/Suppliers List	1	11
Appendix-02	Illustrative BoQ Sample	1	29
Appendix-03	Approved Fabrication Drawings	1	12

****Note: ****

All appendices listed above are integral parts of the bid document. Bidders are advised to thoroughly review and understand the content presented in these appendices as it may be directly contributing to the bid requirements and evaluation process.

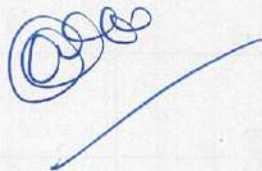

000372

EMPLOYER'S REQUIREMENTS

APPENDIX 10

APPROVED MANUFACTURERS/SUPPLIERS LIST



ICB No.-JP/EW/1B/C1: Design and Construction of Tunnel between Chandpole and Badi Chouper and reversal line by Shield TBM, Underground Metro Stations at Choti Chouper and Badi Chouper by Cut & Cover Method on East-West Corridor of Jaipur Metro (Phase 1B) at Jaipur, Rajasthan, India

A handwritten signature in blue ink is located at the bottom right of the page, below the stamps.

6-101

000373

EMPLOYER'S REQUIREMENTS-
APPROVED MANUFACTURERS/SUPPLIERS

All materials and products shall conform to the relevant standard specification, BIS codes and other relevant codes etc and shall be of make as approved by Engineer.

The list of approved makes for products and materials is given below. Other equivalent manufacturers may also be considered with prior approval of the Engineer, if found conforming to all standards. Such requests should be made with all documents to the Engineer at least 45 days before the material is required and any order shall be placed only after receiving the written approval of the Engineer.

S.No.	Details of Materials / Products	Manufacturer's Name
1	Cement	ACC, Ultratech, Gujarat, Ambuja, Grasim, JK Lakshmi.
2	Reinforcement Bars	SAIL Plants, Rashtriya Ispat Nigam Ltd. (Vizag Steel Plant, Andhra Pradesh), Tata Steel (Jharkhand), Ispat Industries (Maharashtra), JSW Steel (Karnataka), JSP, Essar Steel (Gujarat), Shyam Steel (Durgapur) and any other integrated steel plant as per Ministry of Steel's definition.
3	Epoxy	FOSROC, Sika, QUALCRETE, Aradite, BASF, Kunal Conchem, SWC, Don Chemicals, STP, Cleantech SA, TAM, CICO
4	Expansion Joints	Prequalified Manufacturers as per RDSO's latest approved list or as approved by DMRC.
5	Admixtures	FOSROC, MBT, MC Bauchemie, Sika, APEX, Frutite, Polygon, SWC, Choksey, STP, MYK Schomburg, BASF, MAPEI, Kund Conchem, Durabuild, Conproof, CACH & R Johnson, Asian Lab, TAM, Adoadditives, STP, CICO, Fairmate
6	Pile Integrity Testing Agency	CBRI, FUGRO- KND, Pile Dynamic, AIMIL, Geo dynamic, CEG Test House
7	Anchor Fastener	HILLI, FISHER, Canon, Pooja Forge, AXEL Industries, Panchsteel, Koneer Nuts and Bolts (TUFF Brand), BOUN Group
8	Structural Steel	TATA, SAIL, ESSAR, Maharashtra Pipes, Jindal Steel & Power Ltd, JSW
9	Stainless Steel	Jindal, SAIL or equivalent
10	Pre-stressing Strand (LRPC)	TATA SSL Ltd, USHA Martin, (DP wires, Ramsarup Nirman only if first two supplies are short)
11	Welding Electrodes	ESAB, Advani - Orlikon Weld Alloy, Modi, ArcWeld, Excel India, GEE, Honavar, KM. Crown Welding Consumables, Victor, Sch Weissste chik, Owekam Electrodes, L&T Eutech
12	Pot/Elastomeric Bearings	Prequalified Manufacturers as per RDSO's latest approved list, or as approved by DMRC.

000374 6-102

	Horizontal Tie Bars/Shear Bars	BB Bars System, BBV Systems or equivalent
14	HDPE Sheathing	Rex Polyextrusion, Gwalior Polypipes Ltd, Kataria Sheathing, M/s Tirupati, M/s Dynamic Prestress
15	Formwork Release Agent	FOSROC, MBT, MC Bauchemie, Ado Conmat, CICO, SWC, Choksey, BASF, Adoadditives, STP
16	Prestressing System	Freyssinet, BBR, VSL, Dynamic, Killick Nixon, Tensacciai (India Ltd.), JK Prestressing, Usha Martin, Posten, VSL
17	Reinforcement Couplers	Dextra, Moment or equivalent
18	Hollow Sections, Pipes	Surya Pipes, Hi-Tech Pipes, JSW, JSPL, Bihar, Ravindra Tubes
19	Drainage Pipes	Tirupati Plastomatics, Duraline, REX, STIPL
20	Acrylic Textured Coatings	Spectrum, Renova, Walz, Surfa Nova, Jotun, Asian Paints
21	Non shrink Grout	Fosroc Chemical (India), Sika BASF, ELCHEM, MBT, Sika, SWC, Don, Choksey, Cleantech IR, Adoadditives, TAM, STP, CICO
22	Bonding Coat	CICO, FOSROC, Sunanda specialty coating Pvt. Ltd., BASF, SWC, TAM
23	Polysulphide Sealant	CICO, Pidilite, BASF, FOSROC, SWC, STP, Sika, Fairmate
24	Steel Structural Fasteners	Pooja Forge, Sundram Fasteners, Unbrako, Nelson, Panchsheel
25	Paints	Berger, Johnson Nicholson, Nerolac, Asian, Akzo Nobel, PPG, Jotun
26	Micro Silica	Sika, Elkem, FOSROC, MAPEI, Comiche, Star Silica, TAM, CALPAR, CICO
27	Fire Resistant Paints	Akzo Noble, PPG or equivalent, Jotun
28	External Acrylic Emulsion	Berger, Apex, Asian, Nerolac, Jenson & Nickson
29	Integral Crystalline Waterproofing Method	Krytox Buildmat Co. (Pvt) Ltd., Penetron, Vandex International Ltd., BASF, Chryso, XYPEX
30	Water stopper/Bar	Kanta Rubber, Greenstreak, Maruti, Duron
31	Liquid polymer membrane waterproofing	INTEGRITANK, BASF, MAPEI, PIDILITE, DAVCO, CICO
32	Curing Compound	Cleantech concure, SIKAK, FOSROC, Adoadditives, TAM, STP, SWC, CICO
33	Polycarbonate Sheets	M/s Galina Acropolis, Coxwell, Poly U, Fabic, SABIC, DANPALON
34	Fly Ash	Thermal Plants, Ashcrete, Ultra Pozz, Star Pozz (the Fly Ash shall be as per our specifications)

19/5

RAJAN KATARI
Chief Engineer (Construction)
National Metro Corporation Ltd.
Metro Bhawan, Fire Brigade Lane
Laxmi Nagar, New Delhi-110021



[Handwritten signature]

Tender copy file

6-103

AM/T

143
000375

DMRC/12/CA/187/032

11th March' 2013NOTE

Subject:- Revised Approved Vendor List.

Please find attached herewith the Revised Vendor list Approved by the competent authority for your reference/record.

Encl. As Above.

Tripta Khurana
(Tripta Khurana)
CGM/ Arch.

CE/Tender

Dy. CE/Tender

Per the new tender.

CPM-1

CPM-2

CPM-3

CPM-4

CPM-5

CPM-6

CPM-7

CPM-8

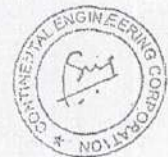

[Handwritten signature]

ANNEXURE: C

DATE: 07.03.2013

6-104

000376

Finishing works Vendor List			
S. No.	Work Category	Items/ Products	Approved Manufacturers/ Vendors
1	VITRIFIED TILES		Kajaria HSR Johnson (India) Naveen Somany Orient R.K. Ceramics Restile Ceramics Limited Asian Granito India Ltd. Oasis (Marbomax Group) Euro Tiles Orade Granito Limited ('Marbito' Vitrified Tiles) Nico
	CERAMIC TILES/ PORCELAIN TILES		Kajaria Bel Ceramics HSR Johnson (India) Nico Regency Ceramics Ltd. Somany Orient Kajaria Ceramic Raja Tiles Modul Enterprises Italia Euro Tiles Hindustan Tiles Nico
	TERRAZZO TILES		Hindustan Tiles
	TACTILE		Pelican Ceramic Industries Pvt. Limited UniStone Products (India) Pvt. Ltd. Nimco Prefab Ltd.
	PVC Floors		Amstrong World Industries (India) Pvt. Ltd. Gerflor India Tarket VedKay Polycoats Limited Hewitson/ Kinspan Access Floors United Access Floors/ United Insulation Unifair Unifloor Acons
	RAISED FLOORS		Amstrong World Industries (India) Pvt. Ltd. Action Tesa (Action Buildwell) Parco Cipri Polyurethanes H.C. Associates Pdlite Shalimar Paints Sika
	WOODEN FLOORS		Unistone Nimco Prefab Hindustan Tiles
	PU COATED FLOORS		UniStone Products (India) Pvt. Ltd. CCC Builders Merchant Delhi Pvt. Ltd. Nimco Prefab Hindustan Tiles
	GRO PAVING TILES		Terra Firma (Now TERRA FIRMA GRC & CONCRETE INDUSTRIES) Nico Hindustan Tiles Ultra Tiles Orade Granito Limited ('Marbito' Vitrified Tiles)
	PAVERS & CHEQUERED TILES		



7/3/13

[Handwritten signature]

203
6-105

000377

S. No.	Work Category	Items/ Products	Approved Manufacturers/ Vendors
2	FINISHING	MOSAIC TILES	Bisazza (Glass Mosaic Tiles) Mindul Enterprises Italia Kenzai Cpio Eon Ceramics
		EMULSION PAINTS	ICI Dulux Modi Industries Acro Paints Asian Berger Nerolac Jenson & Nicholson Kamdhenu Paints Shalimar Paints Sherwin Williams Paints
		SYNTHETIC ENAMELS	ICI Dulux Acro Paints Asian Berger Nerolac Jenson & Nicholson
		TEXTURE PAINTS	Kamdhenu Paints Shalimar Paints Sherwin Williams Paints Spectrum Unitile Bakelite Hytan (Surface Texture Division) "Heritage" Paints Texin Products (M/s M&C) Acro Paints Birta ICI Dulux NCL ALTEK Kamdhenu Paints Bizzar Sherwin Williams Paints
		POLYURETHANE PAINTS	MRF paints Nerolac H.C. Associates
		WALL CARE PUTTY	Modi Industries Ltd. (Paint Section) J.K. White Unistone Birta (Aditya Birla Group) Shalimar Paints
		GLASS (Float / Toughened)	Gyproc wall Putty (Saint Gobain) Float Glass India Ltd. (Asahi float) Asahi Float (AIS) Modigaurd Glaverbel Saint Gobain Sejal
		STRUCTURAL GLAZING FABRICATORS	PERMASTEELISA (INDIA) PRIVATE LIMITED Alufit (INDIA) Pvt. Ltd. SP-fabricators pvt. Ltd. Apro India Ashod Decore (India) Pvt. Ltd. Innovators Fa çade India Testing Inc.



7/3/13

6-106

000378

S. No.	Work Category	Items/ Products	Approved Manufacturers/ Vendors
3	CLADDING	ALUMINIUM COMPOSITE PANEL	AlucoBond
			Reynobond
			(Marketed through Kawneer India; Stockists HECTAFINE CONSTECH INDIA PVT. LTD.)
			ALPOLIC (A Mitsubishi product)
			Alstrong
			Alex Panels
			ALSTONE INTERNATIONAL
			Aludecor Lamination Pvt. Ltd.
			Alupan Composite Panels Pvt. Ltd.
			UniStone Products (India) Pvt. Ltd.
4	CEILINGS	GRC PRODUCTS (GRC Screen, Panels etc.)	Hindustan
			TERRAFIRMA GRC & CONCRETE Industries
		WAX PLASTER	Unifite
			Okos India Pvt. Ltd.
		GYPSBOARD CEILINGS	Acro Paints
			Gyproc (Saint Gobain)
		CALCIUM SILICATE BOARD	Lafarge Boral Gypsum India Pvt. Ltd.
			Promat
		SS, MS/GI POWDER COATED CEILINGS	Hilux
			Acron Pan
5	ADHESIVES, FILLERS & SEALANTS	ALUMINIUM CEILINGS	Aeroflex
			Hunter Douglas
		ADHESIVES FOR TILES	Armstrong
			Durlum
		TILE JOINT FILLER	Famaline
			Canon Ceiling System
		POLY SULPHIDE SEALANTS	Hunter Douglas
			Armstrong
		SILICONE SEALANTS	Durlum
			Pidilite



7/3/18

[Signature]

201

6-107

000379

S. No.	Work Category	Items/ Products	Approved Manufacturers/ Vendors
6	JOINERY/ WOODWORK PRODUCTS	SILICON WATER REPELLANT SOLUTION	GE Bayer Silicones
			Metroark
		POLYURETHANE SEALANTS	STP Limited
			MC Bauchemie
		PLYWOOD	Choksey Chemicals
			3M
		BLOCKBOARD	SIKA
			McCoy Soudal
		LAMINATE	Duroply- Sharda Ply wood Industries
			Century Ply
		PRE-LAMINATED PARTICLE BOARD	Kiply
			Green Ply wood
		FLUSH DOORS	Virgo Lam
			(M/s Virgo Industries -> Virgo Plywoods Ltd.)
		COMPACT LAMINATED DOORS	Swastik Plyboard Ltd. (Swati Plyboard)
			Merino
		PRESSED STEEL DOOR FRAMES	Duroply- Sharda Ply wood Industries
			Century Ply
		FIRE DOORS	Kiply
			Green Ply wood
7	PLUMBING	SANITARYWARE	Virgo Lam
			(M/s Virgo Industries)
		FIRE DOORS	Novopan (GVK Group)
			Ecoboard
		SANITARYWARE	Adion Tesa (Adion Buildwell)
			Bhutan Board
		FIRE DOORS	Kanchan Ply
			Swastik Ply
		SANITARYWARE	Kutti's
			Diamond Flush Doors/Star Metal Forms p. Ltd.
		SANITARYWARE	Raa Veela
			Alpro Panels
		FIRE DOORS	Merino
			Greenlam Asia Pacific Pte Ltd sturdy rest rooms and cubicals
		SANITARYWARE	GreenPly
			AGEW STEEL MANUFACTURES PVT LTD
		FIRE DOORS	Sen-Harvic Windows Private Limited
			Raymus
		SANITARYWARE	Signum Fire Protection (I) Pvt. Ltd.
			Godrej & Boyce Manufacturing Company Limited.
		SANITARYWARE	RADIANT FIRE PROTECTION ENGINEERS PVT. LTD.
			NAVAIR INTERNATIONAL LTD.
		FIRE DOORS	Sehgal & Sehgal
			ShaktiMet
		SANITARYWARE	Hindware
			Cera
		FIRE DOORS	Roca
			Paryware
		SANITARYWARE	Euro
			Somany



7/3/13

6-108

000380

S. No.	Work Category	Items/ Products	Approved Manufacturers/ Vendors
		SANITARY & BATH FITTINGS	Mayur/Othello Jaquar and Company Pvt. Ltd. Kohler Kansoon (Plastocraft Sanitary India Pvt Ltd) Lafrel Marc Domna Hafele Dorset Oline India Hardware Hardwyn Ozone Kich D'unex Tulne Hilti India Pvt. Ltd. BOSCH FISCHER Canon Fasteners Axel Boun Group Hilti India Pvt. Ltd. BOSCH FISCHER Canon Fasteners BOUN Group Domna Hafele Dorset Oline Hardwyn Ozone Hettich India Pvt Ltd
8	HARDWARES	FRAMELESS GLASS PARTITION FIXTURES	
		SPIGOT FITTINGS/ PATCH FITTINGS	
		ANCHOR FASTENERS	
		STONE CLADDING CLAMPS	
		DOOR HARDWARE	
9	PIPES & FITTINGS	DRAINAGE PIPES	Tirupati Plastics Durafine Rex
		DUCTILE IRON PIPES	Electro Steel Jindal (Hissar)
		CAST IRON (L.A.) S/S PIPES & FITTINGS (IS:1535)	Kesaram KOPL NECCO
		GI & M S P IPES (IS:1239 PART I & II, IS:3589)	Surya Swastik Prakash Zoloto
		UPVC PIPES & FITTINGS (IS:4985-1987)	Ur. Vik R KS KOPAL Prince Polypack Jindal Plast (India) Flowguard - Astral Ajay Ashirwad Perfect Anand R.K. Praya
		CPVC PIPES & FITTINGS	
		STONEWARE PIPES & GULLY TRAPS (IS:651)	



7/3/15

[Handwritten signature]

6-189

000381

S. No.	Work Category	Items/ Products	Approved Manufacturers/ Vendors
		RCC PIPES (IS-458)	Pragati Jain Spun Daya Spun Usha
		COPPER PIPES & FITTINGS	Mahla Tubes Rajco Maxflow Gebreti
		HDPE PIPES & FITTINGS	Reliance (Hasti) Nosil
		STAINLESS STEEL PIPES	Remi Jyoti Apex Kandhenu
		PPR PIPES & FITTINGS	Supreme Prince Uro-Alwin
		POLYBUTYLENE (PB) PIPES & FITTINGS	Georg Fischer Flexalon
10	WATERPROOFING/ REPELLANTS COMPOUND	MODIFIED BITUMINOUS MEMBRANE ROOF WATERPROOFING	Multiplas Standard of Integrated Waterproofing Membrane Limited / SUPER THERMOLAY / POLYFLEX of STP Limited LOTUS-31 of the Structural Waterproofing Co. Limited Sika Kemco Krylon Buildmat MBT FOSROC
		INTEGRAL CRYSTALLINE WATERPROOFING METHOD	Krylon Buildmat Pantatron Mapei Vandex International Ltd.
11	POWDER COATINGS		Berger Nerocoat Jenson & Nicholson Jatun
12	METALS	ALUMINIUM SECTIONS	Radiant Anodisers Pvt. Ltd. Hindustan Aluminium Jindal Aluminium Ltd. Bhokra Bharat Aluminium Company Limited/Vedanta BALCO Hindalco
		HOLLOW SECTIONS, PIPES	Surya Pipes Hi-Tech pipes JSW JSPL Bihar (Bihar Tubes Ltd.)
		M.S. TUBES/ SECTIONS	Tata Metal Udyod Metal NSL Limited Bihar Tube Ltd. Swastik Pipes Ltd. JSW ISPAT Rana
		SS WORKS	Dharam Industries (FABRINOX) Ozone Jindal Stainless (JSJ)



7/3/18

S. No.	Work Category	Items/Products	Approved Manufacturers/ Vendors
13	ROOFING/METAL SHEETING	ROOFING SHEETS	Roofit (Fibre Glass Roofing, Metal Roofing, galvalume Sheets) Wonder Sheets (3 layer uPVC - Wonder Sheets-Pro) Lloyd Insulations India United
		METAL ROOFS	"TRACDEK" Interarch Building Products Pvt. Ltd. (Metal Roofing Sheet) TATA Bluescope (Metal coated and Pre-painted Sheets - "Zincalume", "Colorbond")
		POLYCARBONATE SHEETS	"Lexan" (SABIC Innovative Plastics) Dampalon
		TENSILE FABRIC	Ferrari Mahler

6-110

6.77

000382

R. Asen 7/3/13



[Handwritten signature]

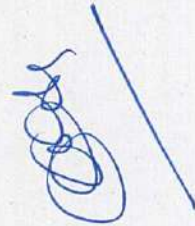
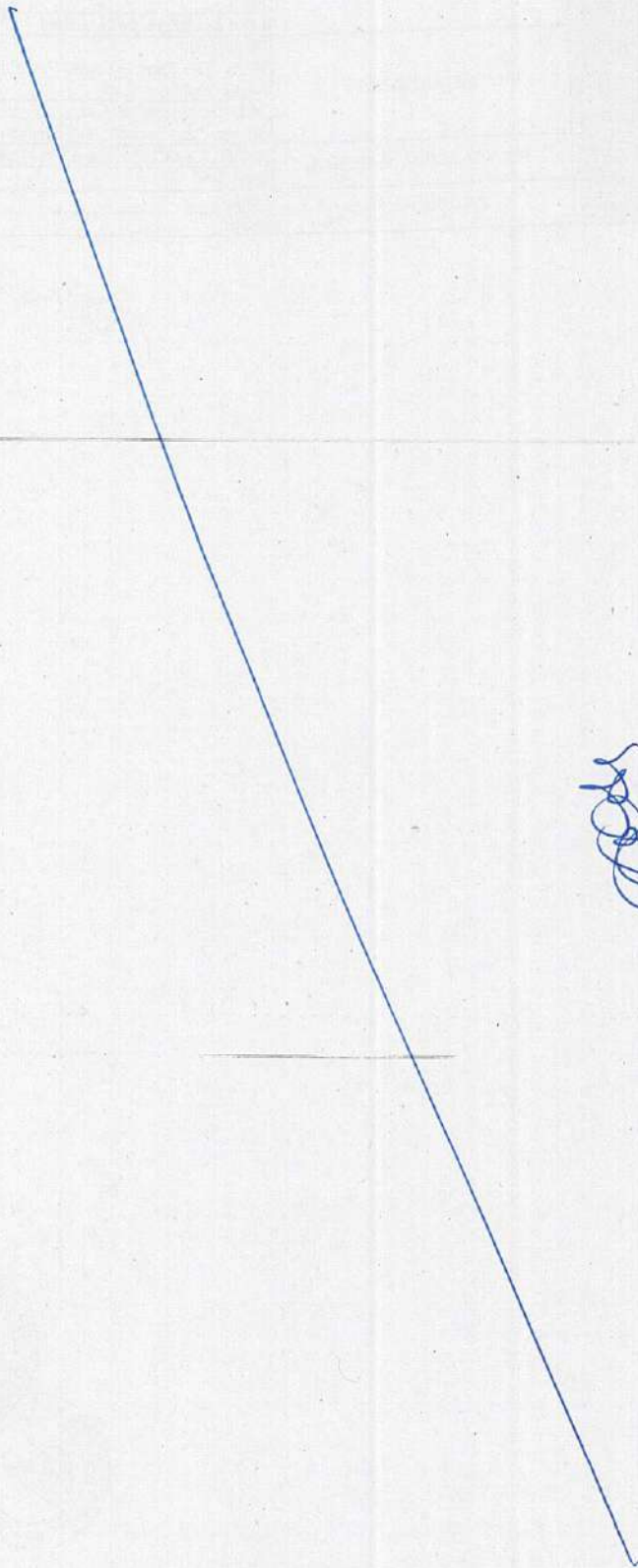

Item Rate BoQ

Tender Inviting Authority:

Name of Work: Removing of Dry Sandstone Cladding, doing Plaster on removed surface and Painting Work on exterior wall face of Civil Lines Metro Station, fixing of down take pipe work from viaduct to ground level, Construction of boundary wall at NAAIT metro station and other miscellaneous repair works from ISOR to BICP of Jaipur Metro.
Contract No: 103/JMRC/O&S/Civil/Works/2023-24

Name of the Bidder / Bidding Firm / Company:		PRICE SCHEDULE					
NUMBER #	TEXT #	NUMBER #	TEXT #	NUMBER #	NUMBER #	TEXT #	TEXT #
Sl. No.	Item Description	Quantity	Units	BASIC RATE Inclusive All Taxes in Figures To be entered by the Bidder in	TOTAL AMOUNT Without Taxes in Rs. P	TOTAL AMOUNT Inclusive All Taxes In Words	
1.00	2	4	5	13	53		55
1.01	Part A: Miscellaneous Civil Works like leakage treatment (RC Gutter and Track Slab Joint) at metro stations ISOR-SICP Providing and applying integral crystalline slurry of hydrophilic in nature for water proofing for water proofing treatment to the RCC structures like retaining walls of the basement, water tanks, roof slabs, podiums, reservoirs, sewage and water treatment plants, tunnels/subways and bridge deck etc., prepared by mixing in the ratio of 5:2 (5 parts integral crystalline slurry; 2 parts water) for vertical surface and 3:1 (3 parts integral crystalline slurry; 1 part water) for horizontal surfaces and applying the same from negative (internal) side with the help of synthetic fibre brush. The material shall meet the requirements as specified in ACI-212-3R-2010 i.e by reducing permeability of concrete by more than 90% compared with control concrete as per DIN-1048 and resistant to 16 Bar hydrostatic pressure on negative side. The crystalline slurry shall be capable of self-healing of cracks upto a width of 0.50mm. The works shall be carried out all complete as per specifications and fabrications of the Engineer-in-Charge. The product performance shall carry guaranteed for 10 Years against any leakage. (For horizontal surface 1.1 coat @ 110 Kg/Sqm)	4326.400	Sqm		0.00	INR Zero Only	

Sl. No.	Item Description	Quantity	Units	BASIC RATE In Figures To be entered by the Bidder in	TOTAL AMOUNT Without Taxes In Rs. P	TOTAL AMOUNT inclusive All Taxes In Words
1.02	Supplying and installation of OMEGA seal joint for repair of expansion joint with all tools and plants provided for the full width of the track bed and leak tightness of all joints. Works shall be carried out as per instructions of Engineer-In-Charge. Work shall be carried out only during black period. Expansion joint type described here after is the "OMEGA TYPE EXPANSION JOINT" as per IRC 63 Part-II (Refer: Technical specification of contract)	80,000	RM			0.00 INR Zero Only
1.03	Designing, Providing, fabricating and erecting hot dipped galvanized "RAIN WATER GUTTER" using mild sheet including all accessories connections sleeves for connecting rain water pipes to gutter placed at roof along all valley and edges of building including site welding at all joints to make water tight including painting as per specifications.	18,000	MT			0.00 INR Zero Only
2.00	Part C: Manufacture, supply, installation, testing, and commissioning of signage and graphics for six elevated metro station (Mansarovar, New Atish Market, Vivek Vihar, Shyam Nagar, Ram Nagar, civil line) for corridor Mansarovar to Chandpole of Jaipur metro Phase-1A.					
2.01	Grouting of railing base plate at viaduct with Corbextra GP-2 or other similar material complete as per directions of Engineer-In-Charge	1500,000	Nos.			0.00 INR Zero Only
2.02	Grouting of Check rail bracket at Curves of track with grouting material Sikadur 53 UF make complete as per directions of Engineer-In-Charge	150,000	Nos.			0.00 INR Zero Only
2.03	Providing and prestressing of shear key bars of 36 mm of approved make complete as per directions of Engineer-In-Charge	8,000	Nos.			0.00 INR Zero Only
2.04	Providing and prestressing of shear key bars of 42 mm of approved make complete as per directions of Engineer-In-Charge	11,000	Nos.			0.00 INR Zero Only
2.05	Non-Illuminated Signs Providing and fixing Non-Illuminated signs including all operations from fabrication to installation all complete as per relevant drawings, technical specifications, signage schedule and to the satisfaction of the Engineer-In-Charge.					

Sl. No.	Item Description	Quantity	Units	BASIC RATE Inclusive All Taxes In Figures To be entered by the Bidder in	TOTAL AMOUNT Without Taxes In Rs. P	TOTAL AMOUNT Inclusive All Taxes In Words
2.06	<p>Sign Elements</p> <p>Sign frame</p> <p>The sign frame shall be made out of CRCA mild sheets fabricated and providing with CRCA mild steel support channel supports are to be powder coated to match Grey RAL 7046 or in color duly The inside edge of sign frame to have EPDM gasket it gets in contact with the sign panel. All powder coating shall be done</p>					
2.07	<p>Sign Panel</p> <p>providing and fixing sign panel made out of 1.6 mm thick Aluminum sheet fabricated to required size and shape, both sides powder coated to required color with screen printed graphics/ sign text as per signage in color to match in color duly approved by Engineer-in-charge and complete graphic protected with lequer coatings. (screen printing is to be done as per technical specifications and drawings and according to directions of Engineer-in-charge. For double sided signage, where screen printed graphics/ sign text are to be provided on both faces, the sign panels a described above are to be provided on each side of sign frame.</p>					
2.08	<p>Back panel:</p> <p>In single sided sign where screen printed graphics/ sign text is to be on one side, are to be provided with 0.8 mm thick CRCA mild steel back panels fabricated to required size and shape as per fabrication drawings and are to be powder coated to match Grey RAL 7046 or any other color as duly approved by Engineer-in-charge and fixing of pictogram panels in CRCA mild steel of required sizes and shape as per fabrication drawings. For double sided signage, where screen printed graphics/ sign text are to be provided on both faces and are to be powder coated to match any other color as duly approved by Engineer-in-charge.</p>					
2.09	<p>Accessories:</p> <p>providing and fixing all accessories such as spring clips, anchoring hooks, nuts, diodes, screws, hooks and slots etc. complete as per specified fabrication drawing above description generally holds good for the following signage except due modifications due to their respective finished dimensions and fixing arrangements.</p>					

Sl. No.	Item Description	Quantity	Units	BASIC RATE Inclusive All Taxes In Figures To be entered by the Bidder in	TOTAL AMOUNT Without Taxes in Rs. P	TOTAL AMOUNT Inclusive All Taxes In Words
2.10	Directional signs Providing and installing of signage as described in "1.0" above and complete as per fabrication drawing no. 1.1.3 including providing and installing following fixing arrangements as the case may be:					
2.11	Non-Illuminated Directional Sign(Face mounted): The sign frame is to be mounted on Brick/ RCC wall backing with cladded or non-cladded. Item to include CRCA mild steel sign frames of required size and shape including mounting the sign frame on the RCC/Brick wall backing by drilling holes of required dia in the RCC/brick wall and anchoring the sign frame using steel-Dash fasteners and providing and fixing all items and accessories complete as per drawing no. 1.1.4-face for following panel sizes. The mounting surface shall be required or finished as per surrounding area complete at no extra cost. This sign is to be necessarily single sided only.					
2.12	sign panel size excluding sign Depth bands.					
2.13	1500x400 40mm s	4.000	Each		0.00	INR Zero Only
2.14	Non-Illuminated Signs Providing and fixing Non-Illuminated signs including all operations from fabrication to installation all complete as per relevant drawings, technical specifications, signage schedule and to the satisfaction of the Engineer-in-charge.					
2.15	Sign Elements Sign frame The sign frame shall be made out of CRCA mild sheets fabricated and providing with CRCA mild steel support channels welded to sign frame, sign frame including channel supports are to be powder coated to match Grey RAL 7046 or in color duty The inside edge of sign frame to have EPDM gasket it gets in contact with the sign panel All powder coating shall be done					

Sl. No.	Item Description	Quantity	Units	BASIC RATE In Figures To be entered by the Bidder in	TOTAL AMOUNT Without Taxes in Rs. P	TOTAL AMOUNT Inclusive All Taxes in Words
2.16	Sign Panel providing and fixing sign panel made out of 1.6 mm thick Aluminum sheet fabricated to required size and shape, both sides powder coated to required color with screen printed graphics/ sign text as per signage in color to match in color duly approved by Engineer-in-charge and complete graphic protected with lacquer coatings, (screen printing is to be done as per technical specifications and drawings and according to directions of Engineer-in- Charge. For double sided signage, where screen printed graphic/ sign text are to be provided on both faces, the sign panels as described above are to be provided on each side of sign frame.					
2.17	Back panel In single sided sign where screen printed graphic/ sign text is to be on one side, are to be provided with 0.8 mm thick CRCA mild steel back panels fabricated to required size and shape as per fabrication drawings and are to be powder coated to match Grey /RAL 7016 or any other color as duly approved by Engineer-in-charge and fixing of pictogram panels in CRCA mild steel of required sizes and shape as per fabrication drawings. For double sided signage, where screen printed graphic/ sign text are to be provided on both faces and are to be powder coated to match any other color as duly approved by Engineer-in- Charge.					
2.18	Accessories providing and fixing all accessories such as spring clips, anchoring hooks, nuts, cleats, screws hooks and slots etc. complete as per specified fabrication drawing. Above description generally holds good for the following signage except due modifications due to their respective finished dimensions and fixing arrangements:-					
2.19	Directional signs Providing and installing of signage as described in "1.10" above and complete as per fabrication drawing not 1.1.3 including providing and installing following fixing arrangements as the case may be:					

Sl. No.	Item Description	Quantity	Units	BASIC RATE Inclusive All Taxes In Figures To be entered by the Bidder in	TOTAL AMOUNT Without Taxes in Rs. p	TOTAL AMOUNT Inclusive All Taxes In Words
2.20	Non-Illuminated Directional Sign(Face mounted) The sign frame is to be mounted on Brick/ RCC wall backing with cleaded or non-cleaded. Item to include CRCA mild steel sign frames of required size and shape including mounting the sign frame on the RCC/Brick wall backing by drilling holes of required dia in the RCC/brick wall and anchoring the sign frame using steel-Dash fasteners and providing and fixing all items and accessories complete as per drawing no. 1.1.4-Face for following panel sizes. The mounting surface shall be required or finished as per surrounding area complete at no extra cost. This sign is to be necessarily single sided only.					
2.21	sign panel size excluding sign Depth 11x15m					
2.22	1800x400 40mm s	1,000	Each		0.00	INR Zero Only
2.23	Non-Illuminated Directional sign -(Suspended)The sign frame is to be suspended from metal supporting members or concrete e.g. slab or beam, trusses or purline etc by Mild steel suspenders rods of required size and lengths including all accessories like adjuster, stoppers, sleeves, bolts etc. complete as per drawing no. sus-a, sus-b(1), sus-b(2) for following sizes. All mild steel, to be polyurethane painted, shall be Hot Dipped Galvanized after fabrication and before painting. Entire assembly of suspension system is to be polyester powder coated. Hill fasteners of specified diameters are to used where anchoring is to be done with the concrete members. The mounting surface shall be required or finished as per surrounding area complete at no extra cost. Ms Cleats made of 3mm thick SHS, as per fabrication drawings for fixing suspenders with pronal at platform level have to be provided alongwith sign of approx length of 2m or six per finalised Cleats to be welded with portal and paint to match portal color.					
2.24	1200x400 60mm	19,000	Each		0.00	INR Zero Only
2.25	1500x400 80mm	2,000	Each		0.00	INR Zero Only
2.26	1800x400 80mm	4,000	Each		0.00	INR Zero Only
2.27	2100x400 80mm	3,000	Each		0.00	INR Zero Only



Sl. No.	Item Description	Quantity	Units	BASIC RATE In Figures To be entered by the Bidder in	TOTAL AMOUNT Without Taxes In Rs. P	TOTAL AMOUNT Inclusive All Taxes In Words
2.28	Door Name Sign Providing and fixing plated type Graphics sign made out of 1.5mm thick stainless steel, fabricated to required sizes and shape, including corners and edges properly rounded and dressed. Item to include chemical etching of designated graphics/text in required color on the face side and fixing to RCC Wall surface/Wooden doors as required with the stainless steel counter sunk cross headed screws of required length and did, including providing necessary washers, PVC/Rubber spacers etc.	4,000	Each		0.00	INR Zero Only
2.29	350x200					
2.30	Five Exit Sign- (Suspended through suspenders) The sign frame is to be suspended from metal supporting members or concrete e.g. slab, beam, trusses or purlins by Mild steel suspenders made of required size and lengths including all accessories like adjuster, stoppers, sleeves, bolts etc. complete as per drawing no. sus-a, sus-b (1), sus-b(2) for following sizes. All mild steel, to be polychrome painted, shall be Hot Dipped Galvanized after fabrication and before painting. Entire assembly of suspension system is to be polyester powder coated. Hill fasteners of specified diameters are to be used where anchoring is to be done with the concrete members.					
2.31	MIS Cleats made of 3mm thick SHS, as per fabrication drawings, for fixing suspenders with portal at platform level have to be provided alongwith sign of approx length of 2m or as per finalised Cleats to be welded with portal and paint to match portal color.					
2.32	sign panel size excluding sign Depth sign bands.					
2.33	2100x400 200mm Double sided	34,000	Each		0.00	INR Zero Only
2.34	External sign providing and fixing external signs including all operations from fabrication to installation all complete as per relevant drawings, technical specifications, signage schedule and to the satisfaction of the Engineer-in-Charge.					
2.35	Totem Sign Providing and fixing Totem sign illuminated type (mentioning the station name and logo / emblem of the Metro Railway on either side) including all operations from fabrication to installation complete including all accessories, technical specifications and signage schedule.					

Sl. No.	Item Description	Quantity	Units	BASIC RATE Inclusive All Taxes In Figures To be entered by the Bidder In	TOTAL AMOUNT Without Taxes in Rs. P	TOTAL AMOUNT inclusive All Taxes In Words
2.36	It comprises of logo panel and station name panel to be made out of Aluminum sheet fabricated to be specified size shape and A curvature and powder coated as per drawing. With laser cut text & graphic as mentioned in signage schedule. Item to include providing and fixing sign frame (for supporting the panel frame) of formwork of mild steel (SMC channel made up in two parts, one on the rear side of column post other on far side of the post properly braced with MS angle tie members welded to the sign panel frame and post, providing specified number of Aluminum flats each of required size and shape to support the luminaires, providing top and bottom cover sheets in item to include powder coating all Aluminum sheets, sign frame and angles to required color, providing Mild steel SHS brackets in two parts in required metal shutter opening for control switch as shown in the drawing. Providing required fixing of brackets on columns, mounting the sign on the brackets, providing and fixing all accessories, angles, T-section gusset plates base plates etc. Item The sign shall be internally illuminated with 12 NOS W - T-3(16W) fluorescent lamps, 6 NOS, on either side (4 NOS on lower half with station name and 2 NOS of upper half showing logo) as per drawings, makes and specifications specified for electrical works. The job includes the following: Interconnecting wiring within the sign - installation of 6A SPN MCB in built-up pole box. - wiring from pole box to the sign through the pole itself. - terminating and connecting the incoming cable laid by DMRC at the pole box including supply of cable. - Making each connection with earth conductor laid along with incoming cable connecting to DMRC System. Wiring with in the sign and from pole box to sign shall be as per size and specifications mentioned in the additional specifications	10.000	Each			
2.37						
2.38						
2.39	1800X1000 mm Side-four	10.000	Each		0.00	INR Zero Only

Sl. No.	Item Description	Quantity	Units	BASIC RATE Inclusive All Taxes In Figures To be Entered by the Bidder in	TOTAL AMOUNT Without Taxes in Rs. P	TOTAL AMOUNT Inclusive All Taxes In Words
2.40	Illuminated Picto Panel Providing and fixing CRCA mild steel Picto-Panel powder coated to match blue with laser cut graphics and Picto gram and to be illuminated through luminare as specified. Item to include providing and fixing opal white poly carbonate sheet of required illuminated Title band Title band is to be provided with mild steel panel powder coated to match blue with laser graphic and is to be lit inside through luminare as specified. Item to include providing and fixing Opal white poly carbonate sheet of required size and fixing it to title band panel. Non-illuminated information Panels Providing and fixing non-illuminated information panels made out of aluminum sheet and fabricated to required size on alpine powder coated to match blue or as approved by Engineer-in-Charge with screen printed graphic as per signage schedule. Item also includes providing 6mm thick clear toughened glass and fixing it to front of information panel as per drawing. Post Providing and fixing SFS mild steel post as per Fabrication Dwg no-5.1.3-Post, the sign frame and sign panels for Non-illuminated Identification Band, Illuminated Picto Panel, Illuminated Title Band and non-illuminated information panels etc. shall be fixed as per drawing and as directed by and to the satisfaction of engineer in-charge complete as per drawing.					
2.41	As per Fabrication dwg no 5.1.3-Face mounted (1200x1800)	1,000 Nos			0.00	INR Zero Only

Sl. No.	Item Description	Quantity	Units	BASIC RATE Inclusive All Taxes in Figures To be entered by the Bidder in	TOTAL AMOUNT Without Taxes in Rs. P	TOTAL AMOUNT Inclusive All Taxes in Words
2.42	Route Map Sign at Platform Providing and fixing Route Map sign at platform complete include sign panel made out of Aluminum sheet fabricated to required size and shape, both sides powder coated to required colour with screen printed graphics/sign text as per signage schedule in colour duly approved by Engineer-in-Charge Sign Frame The sign frame shall be made out of CRCA mild steel sheets fabricated and provided with CRCA mild steel support channels welded to sign to frame. Sign frame are to be powder coated to match Grey RAL 7046 or in color duly approved by Engineer-in-Charge Sign Panel Providing and fixing sign panel made out of Aluminum sheet fabricated to required size and shape, both sides powder coated to required color with screen printed graphics/sign text as per signage schedule in color duly approved by Engineer-in-Charge and complete graphic screen printing is to be done as per technical specifications and drawings and according to directions of Engineer-in-Charge.					
2.43	Back panel Sign to be providing with CRCA mild steel back panels fabricated to required size and shape as per fabrication drawings and are to be powder coated to match Grey RAL 7046 or any other color as duly approved by Engineer-in-Charge Horizontal Box Section Providing and fixing 3mm thk. RHS mild steel horizontal box section with adjustable box section finished with PU paint as per Fabrication Drg no-1.2.3a & b, shall be fixed as per drg and as directed by and to the satisfaction of engineer incharge complete as per drawing.	9,000	Nos			
2.44	Sign panel size excluding 3400x500, Sign Depth=40mm Sign boards=single side				0.00	INR Zero Only



Sl. No.	Item Description	Quantity	Units	BASIC RATE Inclusive All Taxes In Figures To be entered by the Bidder In	TOTAL AMOUNT Without Taxes in Rs.	TOTAL AMOUNT Inclusive All Taxes In Words
2.45	Platform name sign with information panels providing and fixing platform name sign with information panels including all operations from fabrication to installation all complete as per relevant drawing, technical specifications, signage schedule and to the satisfaction of the Engineer-in-Charge. Non illuminated sign - Frame to required sizes and shape Sign frame to be powder coated to match Grey RAL 7046 or in color duly approved by Engineer-in-Charge. All powder coating shall be done on all internal as well as external surfaces. Sign- Panels providing and fixing sign panel made out of 1.6 mm thick aluminum sheet fabricated to required size and shape finished with powder coating of approved size and shape finished with powder coating of approved color, item to include screen printed graphic/text as per signage schedule and drawing on the front of sign panel.					
2.46	Back Panels Sign are to be provided with 0.8mm thick CRCA mild steel back panel and back panel is to be powder coated to match Grey RAL 7046 or any other colour as duly approved by Engineer-in-Charge. Above description generally holds good for the following signage unless otherwise specified: Providing and installing of sign complete as per fabrication drawing nos. 1.2.3a & 1.2.3b The sign comprises of logo sign as described in 1.2 with horizontal box section is to be fixed to support brackets which are welded to existing steel portals. Item to include all operation from fabrication to installation as per drawing mounted on MS box section. Item to include all operation from fabrication to installation as per drawing.					
2.47	As per fabrication drawings no 1.2.3a & 1.2.3b	18,000 Nos				
2.48	Statutory Signs Providing and fixing statutory sign complete including all accessories, item to include plated type graphic signs made out of aluminum sheet fabricated to required size and shape including corners and edges properly rounded and dressed punching necessary holes of required dia, pure Polyester powder.					
					0.00	INR Zero Only

Sl. No.	Item Description	Quantity	Units	BASIC RATE inclusive All Taxes In Figures To be entered by the Bidder in	TOTAL AMOUNT Without Taxes in Rs. P	TOTAL AMOUNT Inclusive All Taxes In Words
2.49	Providing and fixing plated type graphic signs made out of Aluminium sheet fabricated to required size and shape including corners and edges properly rounded and dressed punching necessary holes of required dia, pure Polyester powder coating on both sides and all edges in required color screen printing of designated graphic/text in required color on the face side (screen printing to be done as per specifications and in accordance with the sign schedule and directions of Engineer-in-Charge) and protected with lacquer coating including fixing to RCC/Brick wall backing by drilling holes of required dia. in the RCC/Brick wall counter sunk cross headed screws of required length and dia including providing necessary washers, PVC/Rubber spacers etc. complete as per sign schedule and directions of the Engineer-in-Charge which shall be final conclusive and binding.					
2.50	Sign panel size excluding bands sign Depth					
2.51	150x200 single sided 2mm	36,000	Nos		0.00	INR Zero Only
2.52	200x150 single sided 2mm	3,000	Nos		0.00	INR Zero Only
2.53	200x200 single sided 2mm	40,000	Nos		0.00	INR Zero Only
2.54	300x300 single sided 2mm	5,000	Nos		0.00	INR Zero Only
3.00	Part E: Structural repair and waterproofing works at Metro Stations of JMRC Phase 1A					
3.01	Providing and fixing double scaffolding system (cup lock type) on the exterior side, up to seven story height made with 40 mm dia M.S. tube 1.5 m centre to centre, horizontal & vertical tubes joining with cup & lock system with M.S. tubes, M.S. tube challoos, M.S. clamps and JWS staircase system in the scaffolding for working platform etc. and maintaining it in a serviceable condition for the required duration as approved and reworking it there after. The scaffolding system shall be stiffened with brisings, runners, connection with the building etc. wherever required for inspection of work at required locations with essential safety features for the workers etc. complete as per directions and approval of Engineer-in-Charge. The elevational area of the scaffolding shall be measured for payment purpose. This payment will be made once irrespective of duration of scaffolding. Note: - This item to be used for maintenance work judiciously. Necessary deduction for scaffolding in the existing item to be done.	340,000	Sqm		0.00	INR Zero Only



Sl. No.	Item Description	Quantity	Units	BASIC RATE In Figures To be entered by the Bidder In	TOTAL AMOUNT Without Taxes In Rs. P	TOTAL AMOUNT In Words Inclusive All Taxes
3.02	Providing and inserting 12mm dia galvanised steel injection nipple in honey comb area and along crack line including drilling of holes of required diameter (20mm to 30mm) up to depth from 30mm to 80mm as required spacing and making the hole & crack dust free by blowing compressed air, sealing the distance between injection nipple with adhesive chemical of approved make and allow it to cure complete as per direction of Engineer-In-Charge.	265.000	Each			0.00 INR Zero Only
3.03	Providing and injecting approved grout in proportion recommended by the manufacturer into cracks/honey-comb area of concrete/masonry by suitable grout pump at required pressure including cutting of nipples after curing etc. complete as per directions of Engineer-In-Charge. (The payment shall be made on the basis of actual weight of approved grout injected.) Epoxy injection grout in concrete/RCC work of approved make.	1325.000	Kg		0.00	INR Zero Only
3.04	Providing and applying crystalline mortar by mixing in the ratio of 4.5: 1 (4.5 parts crystalline mortar : 1 part water) for the treatment of faulty construction joints, cracks, tie rod holes and spalled & honeycombed surface of RCC underground structures like basement, water tanks, bridge deck etc. to ensure water tightness. The crystalline mortar shall conform to the EN 1504-3 having compressive strength Class R4 745 MPa and adhesive bond strength Class R3 71.5 MPa. The work shall be carried out as complete as per specification and the direction of the engineer-in-charge. The product performance shall carry guarantee for 10 years against any leakage. Filling/sealing cracks and faulty construction joints, routed out (min 10mm U-shape groove size 25x25mm and then primed the area with integral crystalline slurry @0.05kg/running metre and while the surface is tacky, filled the groove upto surface with crystalline mortar @1.50kg/running metre. Once crystalline mortar is touch dry, then finally applied two coats of integral crystalline slurry @0.03kg/running metre per coat.	50.000	Metre			0.00 INR Zero Only

Sl. No.	Item Description	Quantity	Units	BASIC RATE Inclusive All Taxes In Figures To be entered by the Bidder in	TOTAL AMOUNT Without Taxes in Rs. P	TOTAL AMOUNT Inclusive All Taxes In Words
4.00	Part G: Painting of platform Roof structure (Steel PEB Structure) of mainline stations of Jhupur Metro Phase 1A from Mansarovar to Sindhi camp Metro Station (Total 08 Elevated Stations)					
4.01	Cleaning the surfaces with detergent, wire brush, tools (inaccessible area) and making dust free. The work shall be carried out as per direction of Engineer in Charge and include all labour, materials, tools, plants, ladder, scaffolding, spider, safety belts etc all complete (Surface preparation to achieve S12).	56248.000	Sqm		0.00	INR Zero Only
4.02	Removing of old paint, rust with help of power tool and preparing the surface to various standards (ASA 3.0) before application of primer. The rate will include all tools, plants, labour and other consumables and incidental charges. Nothing shall be paid extra. Except NBSR no 1, 3, 4, 5 and 6. The surface which are not accessible with the help of power tool shall be prepared with wire brush.	14084.000	Sqm		0.00	INR Zero Only
4.03	Covering the flooring with tarpoline to avoid any stain marks at floors on daily basis including labor charges for spreading and rolling back daily (The dust collected should be disposed off to the specified places)	25400.000	Sqm		0.00	INR Zero Only

Sl. No.	Item Description	Quantity	Units	BASIC RATE inclusive All Taxes in Figures To be entered by the Bidder in Rs. P	TOTAL AMOUNT Without Taxes in Rs. P	TOTAL AMOUNT inclusive All Taxes in Words
4.04	Providing and fixing the spider safety net made of polypropylene rope in double lesh having thread size 6 mm X 12 mm with grid 100 mm X 100 mm upto the height of 15 metres at the platform of shed with necessary scaffolding, ladder, machine etc. with all lead, lift, ascent, descent and transportation etc. as per direction of Engineer-in-charge. The spider safety net provided shall be retained in position at site continuously including shifting the spider net from one location to another location as many times as required during the execution of the entire work till its completion. Rate includes its maintenance for damages with additional materials, all highly skilled and semi skilled labour, equipments required to execute the job. The spider net shall not be removed without prior approval of Engineer in charge. Work will be carried out strictly in non operational hours as per direction of Engineer-in-charge.	22400.000	Sqm		0.00	INR Zero Only
4.05	Applying surface tolerant epoxy coating in two coats with epoxy based primer with minimum DFT of 200 microns at all locations wherever required and volume of solids not less than 75%. Paint is to be applied with spray painting, in place where its inaccessible it may be applied with brush (item to be used where surface is having scaling.)	14054.000	Sqm		0.00	INR Zero Only
4.06	Application of finishing coat epoxy polyurethane system of approved quality brand of UV resistant coat at all locations and colour to achieve smooth & even surface with minimum volume of solids 57% and of 75 microns thickness of surfaces.	55248.000	Sqm		0.00	INR Zero Only
5.00	Part H: Miscellaneous Repair Work of Buildings					
5.01	Stone work, plain in copings, cornices, sills, courses and plinth courses, upto 75 mm thick in Cement mortar 1:5 (1: cement : 6 coarse sand) including pointing with white cement mortar 1:2 (1: white cement : 2 fine dust) with an admixture of pigment matching the stone shade. Red sand stone	11.000	Cum		0.00	INR Zero Only

Sl. No.	Item Description	Quantity	Units	BASIC RATE Inclusive All Taxes In Figures To be entered by the Bidder in	TOTAL AMOUNT Without Taxes in Rs. P	TOTAL AMOUNT Inclusive All Taxes In Words
5.02	Supplying and fixing rolling shutters of approved make, made of 80 x 0.8mm color coated G.I. Laths interlocked together through their entire length and jointed together at the end by end locks mounted on specially designed pipe shaft with brackets of M.S. side guides of G.I. and arrangements for inside and outside locking with push and pull operation complete including cost of ring hooks, providing and fixing necessary 45.0 cm. long wire springs grade No-02 including dismantling of existing rolling shutter as per the directions of Engineer-In-Charge.	500,000	KG			0.00 INR Zero Only
5.03	Colour Coated G.I. Top Cover 0.5mm thick for rolling shutters as per instructions of Engineer-In-Charge.	6,000	RM		0.00	INR Zero Only
5.04	Providing and laying polished Marble stone/Sandstone work of size as specified below, of approved colour/pattern with 8 mm thick blue pottery tile inlay fixed inside 10 mm deep rebate in marble, at all levels for wall lining/columns (veneer work) by mechanical arrangement with S.S. Clamp/brackets, Anchor bolts, 5 mm vertical S.S. or approved make. Inserts as per drawings and specifications. The cost for making necessary grooves in the stone to accommodate the vertical inserts, grooves all-around stone pieces, making 10 mm deep rebate for tile inlay, chamfering of corner edges and polishing are included. Payment for Blue pottery tile shall be made separately.					
5.05	Banswara White Marble size 1900x600x35mm minimum thick	52,000	Sqm		0.00	INR Zero Only
5.06	Providing and fixing 8 mm thick blue pottery tile hand made with ground quartz stone powder of shade and surface pattern as approved by Engineer-in-charge, and of size 100x100mm with grout or equivalent approved adhesive inside 10mm deep rebate in marble wall surfaces.	150,000	Each		0.00	INR Zero Only
Total In Figures					0.00	INR Zero Only
Quoted Rate in Figures					0.00000	Zero Only
Quoted Rate in Words			Select		INR Zero Only	



Percentage BoQ: Rajasthan PWD-BSR-2022 Item City Circle Jaipur.

Tender Inviting Authority:

Name of Work: Removing of Dry Sandstone Cladding, doing Plaster on removed surface and Painting Work on exterior wall face of Civil Lines Metro Station, fixing of downtake pipe work from viaduct to ground level, Construction of boundary wall at NMT metro station and other miscellaneous repair works from MSOR to BICP of Jaipur Metro.

Contract No: 103/JMRC/O&S/Civil/Works/2023-24

Name of the Bidder/ Bidding Firm / Company :

PRICE SCHEDULE

(This BOQ template must not be modified/replaced by the bidder and the same should be updated after filling the relevant columns, else the bidder is liable to be rejected for this tender. Bidders are allowed to enter the Bidder Name and Values only)

NUMBER # Sl. No.	TEXT # Item Description	NUMBER # Quantity	TEXT # Units	NUMBER # Estimated Rate Inclusive Taxes Rs. P	NUMBER # TOTAL AMOUNT Without Taxes Rs. P	TEXT # TOTAL AMOUNT inclusive taxes In Words
1.00	Part A: Miscellaneous Civil Works like	4	5	6	53	55
1.00	leakage treatment (RC Gutter and Track Slab Joint) at metro stations MSOR-SICP					
1.01	CHAPTER B-3: CONCRETE WORK					
1.02	3.2: Providing and laying cement concrete including curing, compaction etc. complete in retaining walls, retum walls, walls (any thickness) including attached piasters, columns, piers, abutments, pillars, posts, stairs, buttresses, string offering courses, parapets, coping, bed blocks, anchor blocks, plain window sills, fillets, levelling courses etc up to floor level excluding the cost of centering and shuttering.					
1.03	3.2.2: M15 grade Nominal Mix 1: 2: 4 (1 cement, 2 coarse sand : 4 graded stone aggregate 20mm nominal size).	50.000 Cum		5112.00	255600.00	INR Two Lakh Fifty Five Thousand Six Hundred Only
1.04	CHAPTER : B-17: ADDITIONAL MISCELLANEOUS ITEMS					
1.05	17.52: Providing and applying treatment of plaster and masonry works with premixed, ready mix, two polymer based mortar & conforming to ASTM C 1600 upto 15 mm with 15 mm width by mopping V- Groove with following property - (i) Curing Free, compressive strength 15 MPa Min/lt 2 hours, Quick Setting and with bond strength of 4 MPa within 24 hours with all substrates.	550.000 Rmt		195.00	107250.00	INR One Lakh Seven Thousand Two Hundred & Fifty Only

Sl. No.	Item Description	Quantity	Units	Estimated Rate Inclusive taxes in Rs. P	TOTAL AMOUNT Without Taxes in Rs. P	TOTAL AMOUNT Inclusive taxes In Words
2.00	Part B: Removing of Loose Dry Sandstone Cladding and replacement with Plaster and Paint Work on exterior wall face of Civil Lines Metro Station, of Jaipur Metro.					
2.01	CHAPTER : G-4.1 : CARRIAGE OF MATERIALS					
2.02	NOTE: 1 Rates are for net quantities after deduction of voids. 2 Part of Km beyond 1 Km. will be treated as under : 1.499 = 1.00 Km. ; 1.500 Km. = 2.00 Km. 3 The rates are inclusive of loading and unloading. 4 The rates are inclusive of stacking. If stacking is not required, no deduction is to be done.					
2.03	4.7 (b) : Cement, Stone blocks placed and other heavy materials (For 5Km)	325.000	MT	68.00	31850.00	INR Thirty One Thousand Eight Hundred & Fifty Only
2.04	4.7 (b): Add for each 1 Km beyond 5 Km (upto 10 Km.) @RS08/RM	325.000	MT	40.00	13000.00	INR Thirteen Thousand Only
2.05	CHAPTER : B-12 FINISHING WORK.					
2.06	Note : 1 The rates are for complete work including racking of joints, curing, grinding, mixing and finishing T & P and scaffolding material and cost of material with all lead and lift. 2 The rates cover protection and cleaning such things, requiring protection and cleaning such places and thing of all droppings and splashes of mortar etc. 3 The Rate for external plaster are for height up to 10 m from ground level unless otherwise stated. 4 Cement mortar is to be made by mechanical mixer only.					
2.07	CEMENT PLASTER					
2.08	12.1: Plaster on new surface on wall in cement sand mortar 1:3 including racking of joints etc. complete fine finish.					
2.09	12.1.1: 25 mm thick	4500.000	Sqm	242.00	1089000.00	INR Ten Lakh Eighty Nine Thousand Only
2.10	12.22: Providing and applying with cement based putty over plastered surface to prepare the surface even and smooth finish					
2.11	12.22.1: New Plastered surface (lined or more coats)	4500.000	Sqm	84.00	378000.00	INR Three Lakh Seventy Eight Thousand Only
2.12	INTERIOR FINISHING					

Sl. No.	Item Description	Quantity	Units	Estimated Rate Inclusive taxes in Rs. P	TOTAL AMOUNT Without Taxes in Rs. P	TOTAL AMOUNT Inclusive taxes In Words
2.13	12.37: Dispersing with oil bound washable distemper of approved brand and manufacture to give an even shade including scaffolding.					
2.14	12.37.1: New work (two or more coats) over and including scraping and priming coat with cement primer.	2000.000	Sqm	75.00	150000.00	INR One Lakh Fifty Thousand Only
2.15	EXTERIOR FINISHING					
2.16	12.44: Finishing walls with textured exterior paint of required shades per approved colour complete as per manufacturers specifications including primer coat and protecting coating including scaffolding and safety provision.					
2.17	12.44.4: Trowel Finish av. thickness 2000 to 2500 microns.	4500.000	Sqm	475.00	2137500.00	INR Twenty One Lakh Twenty Eight Thousand Five Hundred Only
2.18	CHAPTER : B-13 REPAIRS TO BUILDING					
2.19	13.22: Providing and fixing double scaffolding system on the exterior side, upto five story made with 4" wooden member 1.5 m c/horizontal and vertical direction joining with rasi, clamps, chafies. The scaffolding system shall be stiffened with bracing, runner, connection of building if necessary with all essential safety features for the workmen etc complete as per direction of EI. The level area of the scaffolding shall be measured for payment. The payment will be made on respective of duration of scaffolding. Note : This item to be used for maintenance work only.	4500.000	Sqm	162.00	729000.00	INR Seven Lakh Twenty Nine Thousand Only
2.20	CHAPTER : B-14 DISMANTLING & DEMOLISHING WORK					
2.21	Note : All items of demolition & dismantling of building shall be conform to IS 4130 for handling, IS 7989 for storage and IS 3036 for scaffolding.					
2.22	14.17: Dismantling steel work in single sections including dismantling and stacking within 50 meters lead in.					
2.23	14.17.2: Channels, angles, I-ees & flats.	6750.000	Kg	1.00	6750.00	INR Six Thousand Seven Hundred & Fifty Only
2.24	14.4: Dismantling precast concrete or stone slabs in wall partitions etc. including stacking within 50 meter lead.					
2.25	14.40.1: Thickness up to 40mm.					
2.26	CHAPTER : B-15 ALUMINIUM & PVC WORK	4500.000	Sqm	77.00	346500.00	INR Three Lakh Forty Six Thousand Five Hundred Only

Sl. No.	Item Description	Quantity	Units	Estimated Rate inclusive taxes in Rs. P	TOTAL AMOUNT Without Taxes in Rs. P	TOTAL AMOUNT inclusive Taxes in Words
2.27	16.55: Providing and Fixing Aluminium composite panel approved make 3mm thick with 0.8mm thick skin & PVDI-coated approved shade for wall panelling. Main framing work to be done using 50mmx25mmx1.6mm tubular section approved make. Stainless steel screw to be used to fix the ACP panel to be fixed to the main frame with industrial adhesive and panel groove to be sealed with weather proof silicone sealant suitable for glass/aluminium etc. complete in all respect as approved by Engineer-in-charge.	40.000	Sqm	2594.00	103760.00	INR One Lakh Three Thousand Seven Hundred & Sixty Only
3.00	Part D:- CONSTRUCTION OF BOUNDARY WALL IN PARKING AREAS AT ENTRY-01 & ENTRY-02 AT NEW AATISH MARKET METRO STATION					
3.01	CHAPTER: G-4.1: CARRIAGE OF MATERIALS					
3.02	NOTE: 1 Rates are for net quantities after deduction of voids 2 Part of Km beyond 1 Km. will be treated as under : 1.499 = 1.00 Km. ; 1.500 Km. = 2.00 Km 3 The rates are inclusive of loading and unloading 4 The rates are inclusive of stacking, if stacking is not required, no deduction is to be done.					
3.03	4.1: Earth, Sand, Lime, Mortum manupor sludge (For 5 Km)	416.750	Cum	125.00	52093.75	INR Fifty Two Thousand & Ninety Three and Paise Seventy Five Only
3.04	4.2: Building Rubbish Stone metal (Grind ballast etc.) (For 5 Km)	837.500	Cum	125.00	104687.50	INR Ten Thousand Four Hundred & Sixty Eight and Paise Seventy Five Only
3.05	CHAPTER B-1 EARTH WORK					
3.06	1.6: Earth work in excavation by mechanical means (Hydraulic excavator / manual means over areas (exceeding 30cm in depth, 1.5m in width as well as 10 sqm on plan) including disposal of excavated earth, load upto 50m and lift upto 1.5 m, disposed earth to be levelled and neatly dressed ; All kinds of soil	712.500	Cum	175.00	124687.50	INR One Lakh Twenty Four Thousand Six Hundred & Eighty Seven and Paise Fifty Only
3.07	1.25: Filling available excavated earth (excluding rock) in trenches, plinth/side of foundation etc. in layers not exceeding 20 cm. in depth, each building each disposed layer by ramming and wetting including feed up to 50 meter length with all kit	265.000	Cum	64.00	16960.00	INR Sixteen Thousand Nine Hundred & Sixty Only
3.08	CHAPTER B-3 CONCRETE WORK					
3.09	CEMENT CONCRETE (CAST-IN-SITU)					

Sr. No.	Item Description	Quantity	Units	Estimated Rate Inclusive Taxes in Rs. P	TOTAL AMOUNT Without Taxes in Rs. P	TOTAL AMOUNT Inclusive Taxes In Words
3.10	3.1: Providing and laying in position cement concrete including curing, compaction etc. complete in specified grade excluding the cost of centering and shuttering. - All work up to plinth level.					
3.11	3.1: M20 grade Nominal Mix 1:1.5:3 (1 cement : 1.5 coarse sand : 3 graded stone aggregate 20mm nominal size)	4.000	Cum	4815.00	19660.00	INR. Nineteen Thousand Six Hundred & Sixty Only
3.12	3.1.2: M15 grade Nominal Mix 1:2:4 (1 cement : 2 coarse sand : 4 graded stone aggregate 20mm nominal size)	179.980	Cum	4824.00	832227.52	INR. Eight Lakh Thirty Two Thousand Two Hundred & Twenty Seven and Paise Fifty Two Only
3.13	CHAPTER B-4: REINFORCED CONCRETE WORK					
3.14	4.5: Providing and laying in position Ready mix concrete manufactured in fully automatic batching plant and transported to site in transit mixer for having continuous agitated mixer, manufactured as per approved mix design of specified grade of RCC work including pumping of R.M.C. from transit mixer to site of laying, excluding the cost of centering, shuttering and reinforcement with all lead and lift including cost of admixtures in recommended portion as per IS 9103 to accelerated retard setting of concrete. Improve workability without impairing strength and durability as per direction of Engineer in charge. All works upto floor. V floor M20 grade Design Mix by using cement as per code provision instead of M-20 grade design mix.	373.800	Cum	6089.00	2276250.87	INR. Twenty Two Lakh Seventy Six Thousand Two Hundred & Fifty and Paise Eighty Seven Only
3.15	4.6.2: Providing M-30 grade concrete by using cement as per code provision instead of M-20 grade design mix.	875.430	Cum	130.00	51952.37	INR. Fifty One Thousand Nine Hundred & Sixty Two and Paise Thirty Seven Only
3.16	FORM WORK					
3.17	4.5: Centering and Shuttering with plywood or steel sheets including strutting, propping bracing both ways and removal of formwork for foundation, footings, slab beam, wall, bases of columns etc.	676.000	Sum.	157.00	106132.00	INR. One Lakh Six Thousand One Hundred & Thirty Two Only
3.18	4.1: Centering & shuttering with plywood or steel sheets including strutting, propping bracing both ways with steel props and removal of formwork upto floor level for:					
3.19	4.10.1: Walls (any thickness) including attached plasters, buttresses, piers and string course.	2386.000	Sqm	289.00	690132.00	INR. Six Lakh Ninety Thousand One Hundred & Thirty Two Only
3.20	STEEL REINFORCEMENT					

Sl. No.	Item Description	Quantity	Units	Estimated Rate inclusive taxes in Rs. P	TOTAL AMOUNT Without Taxes in Rs. P	TOTAL AMOUNT inclusive taxes in Words
3.21	4.13: Providing and fabricating reinforcement for R.C.C. work including straightening, cutting, bending, placing in position and binding (including cost of binding wire) all complete up to floor-fine level. (Original producers' who manufacture billet directly from iron ores and roll the billets to produce steel conforming to IS:1786)	45907.710	Kg	77.00	3544893.67	INR. Thirty Five Lakh Thirty Four Thousand Eight Hundred & Ninety Three and Paise Sixty Seven Only
3.22	4.13.3: Thermo-mechanically Treated bars (Conforming to relevant IS code)					
3.23	CHAPTER : B-9: STEEL & FENCING WORKS					
3.24	9.8: Providing and fixing steel gate, grating, and grills made of angles, tees, square bars, flats or black pipe with hotblast and fittings complete as per design and drawing including cutting, welding and fabrication with painting coat of red oxide	480.000	Kg	96.00	44160.00	INR. Forty Four Thousand One Hundred & Sixty Only
3.25	9.8.1: Extra if square rectangular hollow tubular sections are used or grill made by flats only	480.000	Kg	9.60	4416.00	INR. Four Thousand Four Hundred & Sixteen Only
3.26	9.37: Providing and fixing concrete coil fencing with required dia 610 mm (having 16 nos. round per 6 metre length) up to an height of wall with existing angle iron "Y" shaped placed 2.4 m or 3.00 m apart and with 9 horizontal R.B.T. stud tied with GI staples and GI clips to retain horizontal including necessary bolts or GI barbed wire tied to angle iron all complete as per direction of Engineer in Charge with reinforced barbed tape (R.B.T.) Spring core (2.5 mm thick) wire of high tensile strength of 185 kg/cm ² mm with tape (0.52 mm thick) and weight 43.478 g/metre (Coat of MS angle, CC block shall be paid extra)	400.000	Mtr.	266.00	106400.00	INR. One Lakh Six Thousand Four Hundred Only
3.27	CHAPTER : B-12 FINISHING WORK					
3.28	12.46: Painting with synthetic enamel paint of approved brand and manufacture to give an even shade :					
3.29	12.46.1: Two or more coats on new work	40.000	Sqm	69.00	2760.00	INR. Two Thousand Seven Hundred & Sixty Only
3.30	CHAPTER : B-14 DISMANTLING & DEMOLISHING WORK					
3.31	14.7: Demolishing brick work manually by mechanical means including stacking of serviceable material and disposal of unworkable material within 50 metres lead in any direction of Engineer in Charge					
3.32	14.7.3: In cement mortar	65.000	Cum	588.00	34976.00	INR. Thirty Four Thousand Nine Hundred & Seventy Only

Sl. No.	Item Description	Quantity	Units	Estimated Rate Inclusive taxes in Rs. P	TOTAL AMOUNT Without Taxes in Rs. P	TOTAL AMOUNT Inclusive taxes in Words
3.33	14.9: Demolishing stone rubble masonry manually by mechanical means including stocking of serviceable material and disposal of unserviceable material within 50 metres lead as per direction of Engineer-in-charge.					
3.34	14.9.2: In cement mortar.	80.000	Cum	641.00	51280.00	INR Fifty One Thousand Two Hundred & Eighty Only
4.00	Part E: Structural repair and waterproofing works at Metro stations of MRC Phase 1A					
4.01	INPUTS (BASIC RATES OF MACHINERY)					
4.02	13: Machine for rubbing of floors with driver & car	10.000	Day	1000.00	10000.00	INR Ten Thousand Only
4.03	40: Air compressor 250 cfm with two leads for pneumatic cutters/ hammers.	20.000	Day	1750.00	34600.00	INR Thirty Four Thousand Six Hundred Only
4.04	114: Bulbar *	40.000	Day	500.00	20000.00	INR Twenty Thousand Only
4.05	130: Misty	40.000	Day	700.00	28000.00	INR Twenty Eight Thousand Only
4.06	CHAPTER B-3 CONCRETE WORK					
4.07	3.1.4: M10 grade Nominal Mix: 1: 3: 6 (1 cement : 3 coarse sand : 6 graded stone aggregate 20mm nominal size)	10.000	Cum	3647.00	36470.00	INR Thirty Eight Thousand Four Hundred & Seventy Only
4.08	CHAPTER B-9 STEEL AND FENCING WORKS					
4.09	9.8: Providing and fixing steel gate, grating, and grills made of angles, tees, square bars, flats, or black pipe with holed and fittings complete as per design and drawing including cutting welding and fabrication with grinding coat of red oxide	100.000	Kg	96.00	9600.00	INR Nine Thousand Six Hundred Only
4.10	CHAPTER B-11 FLOORING WORK					
4.11	11.35: Providing and laying of skirting 60 mm wide having both side laminations with moulding in upper side with matching of floor tiling with nails and screws & level complete in all respect as per direction of EI	15.000	Rm	979.00	14685.00	INR Fourteen Thousand Six Hundred & Eighty Five Only
4.12	CHAPTER B-12 FINISHING WORK					
4.13	12.1.2: Plaster on new surface on wall in cement sand mortar 1:3 including racking of joints etc. complete fine finish : 20mm thick	44.000	Sqm	211.00	9284.00	INR Nine Thousand Two Hundred & Eighty Four Only
4.14	12.43.1: Painting exterior surface of Wall with 100% acrylic exterior paint of approved brand (all) manufacture to give an even shade with two or more coats including preparation of base wall, sand papering, primer, putty, etc. complete in all respect including scaffolding and safety provision new work.	44.000	Sqm	123.00	5412.00	INR Five Thousand Four Hundred & Twelve Only
4.15	CHAPTER B-13 REPAIRS TO BUILDING					
4.16	13.21: Add extra for minor polishing, oiling, mable work, Kala stone flooring work where ever required to give high gloss finish complete.	81.000	Sqm	121.00	9801.00	INR Nine Thousand Eight Hundred & One Only

SL No.	Item Description	Quantity	Units	Estimated Rate Inclusive Taxes Rs. P	TOTAL AMOUNT Without Taxes In Rs. P	TOTAL AMOUNT Inclusive Taxes In Words
4.17	13.28: Repair to damaged RCC slabs, beams and columns etc. for strengthening with cement mortar 1:2 in following steps: (i) Chipping loose and cracked concrete to required depth, cleaning the exposed surface of steel and concrete with wire brush and sand papering, cleaning of concrete surface with water as necessary and getting dried (ii) Applying Epoxy primer on the exposed steel bars (iii) Applying Epoxy hardener and resin mix (as per manufacturer's specification) on concrete and steel bars with brush (iv) Spreading dry cement mortar 1:2 mix over epoxy treated wet surface and allow it to dry for one day (v) Plastering the surface with cement sand mortar 1:3 upto depth of 30mm complete (vi) Cure the plastered surface for 15 days. All work including scaffolding etc. complete in all respect.	52.000	Sqm	1568.00	81553.00	INR Eighty One Thousand Five Hundred & Thirty Six Only
5.00	Part F: Estimate for the works of Providing and fixing of Drainage pipes from track slab to Crash barrier along the piers of Viaduct from P1A-P156 including Double Deck Corridor, Art Gallery as well as Station Platform Works, MSOP to CDPF					
5.01	CHAPTER B-15: Finishing Work					
5.02	12.22: Providing and applying white cement based putty over plastered surface to prepare the surface even and smooth complete	12500.000	Sqm	84.00	1050000.00	INR Ten Lakh Fifty Thousand Only
5.03	12.22.1: New Plastered Surface (three or more coats)	25000.000	Sqm	48.00	1150000.00	INR Eleven Lakh Fifty Thousand Only
5.04	12.22.2: Old Plastered Surface (two or more coats)					
5.05	12.37: Dispersing with oil bound washable distemper of approved brand and manufacture to give an even shade including all scaffolding	12500.000	Sqm	75.00	937500.00	INR Nine Lakh Thirty Seven Thousand Five Hundred Only
5.07	12.43: Painting exterior surfaces of Wall with 100% acrylic exterior paint of approved brand and manufacture to give an even shade with two pigments coats including preparation of three coats with sand papering, primer putty etc. complete in all respect including scaffolding and safety provision					
5.08	12.43.1: New Work	12500.000	Sqm	123.00	1537500.00	INR Fifteen Lakh Thirty Seven Thousand Five Hundred Only
5.09	12.43.2: Old Work	25000.000	Sqm	50.00	1250000.00	INR Twelve Lakh Fifty Thousand Only

Sl. No.	Item Description	Quantity	Units	Estimated Rate inclusive taxes in Rs. P	TOTAL AMOUNT Without Taxes in Rs. P	TOTAL AMOUNT inclusive taxes in Words
5.10	12.46: Painting with synthetic enamel paint of approved brand and manufacture to give an even shade.					
5.11	12.46.1: Two or more coats on new work	425.000	Sqm	59.00	25075.00	INR Twenty Nine Thousand Three Hundred & Twenty Five Only
5.12	12.46.2: One or more coats on old work.	8500.000	Sqm	34.00	289000.00	INR Two Lakh Eighty Nine Thousand Only
5.14	CHAPTER B-13:- Repairs to Buildings 13.1: Repairs to plaster of thickness 12mm to 20mm in patches of area 2.5 sq. metres and under including cutting the patch in proper shape, raking out the joints and preparing and plastering the surface of the walls complete including disposal of rubbish to the dumping ground within 50 m lead. With cement mortar 1:4 (1 cement : 4 coarse sand)	12500.000	Sqm	235.00	2937500.00	INR Twenty Nine Lakh Thirty Seven Thousand Five Hundred Only
5.15	13.34: Making of hole in R.C.C. slab/wall/beams and masonry wall (width up to 450 mm) by core cutting machine complete as per direction of E.I.					
5.16	13.34.2: Diameter above 150mm	50.000	Nos	1663.00	83150.00	INR Eighty Three Thousand One Hundred & Fifty Only
5.17	CHAPTER S3:- Drainage/Disposal Work					
5.18	3.16: P&F rigid PVC Pipes (IS:4985 mark) class III (4 Kg./Cm2.) approved quality make including joining the pipe with solvent cement rubber ring and lubricant.					
5.19	3.16.3: 110 mm dia	437.430	Mtr	282.00	123355.26	INR One Lakh Twenty Three Thousand Three Hundred & Fifty Five and Paise Twenty Six Only
5.20	3.16.4: 160 mm dia	2406.170	Mtr	463.00	1113593.71	INR Eleven Lakh Thirteen Thousand Five Hundred & Ninety Three and Paise Seventy One Only
5.21	3.17: P&F rigid PVC pipe fittings (IS: 4985 mark) of approved quality make including joining the pipe with solvent cement rubber ring and lubricant:					
5.22	3.17.8: Bend 45	129.000	Each	128.00	16512.00	INR Sixteen Thousand Five Hundred & Twelve Only
5.23	(ii): 110 mm dia	121.000	Each	143.00	8803.00	INR Eighty Eight Thousand Eight Hundred & Three Only
5.24	(iii): 160 mm dia	172.000	Each	161.00	27692.00	INR Twenty Seven Thousand Six Hundred & Ninety Two Only
5.25	3.17.9: Bend 87.5					
5.26	(i): 110 mm dia					
5.27	(ii): 160 mm dia	369.000	Each	177.00	70623.00	INR Seventy Thousand Six Hundred & Twenty Three Only
5.28	3.17.10: Door Bend (Top Side)					
5.29	(ii): 110 mm dia	43.000	Each	154.00	6622.00	INR Six Thousand Six Hundred & Twenty Two Only
5.30	(iii): 160 mm dia	207.000	Each	172.00	35604.00	INR Thirty Five Thousand Six Hundred & Four Only
5.31	3.17.15: Pipe Gully					
5.32	(ii): 110 mm dia	86.000	Each	36.00	3096.00	INR Three Thousand & Ninety Six Only
5.33	(iii): 160 mm dia	1246.000	Each	53.00	66038.00	INR Sixty Six Thousand & Thirty Eight Only

Sl. No.	Item Description	Quantity	Units	Estimated Rate inclusive taxes in Rs. P	TOTAL AMOUNT Without Taxes in Rs. P	TOTAL AMOUNT inclusive taxes in Words
6.00	Part H: Miscellaneous Repair Work of Buildings					
6.01	CHAPTER : B - 7:- MARBLE, GRANITE AND TILE WORKS					
6.02	7.12: Providing and fixing 1st quality standard white, grey, worry,lume red brown, light green, light blue and other light shades glazed tiles conforming to IS : 13755 & IS :15622 of size 200mm x 300mm in walls, floors, steps, pillars etc. laid on bed of neat cement slurry finished with flush painting in the white cement mixed with pigment to match the shade of the tile complete (excluding the cost of cement plaster on wall and pillar).	1040.000	Sqm	674.00	700958.00	NR: Seven Lakh Nine Hundred & Sixty Only
6.03	7.13: Providing and fixing 1st quality MAT finished ceramic shade 300x300mm conforming to IS : 13755 and IS : 15622 colour such as white, grey, worry, lume red brown, light green, light blue and other light shades in floors, steps, pillars etc. laid on a bed of neat cement slurry finished with flush painting in the white cement mixed with pigment to match the shade of the tile complete (including the cost of cement plaster on wall and pillar).	240.000	Sqm	748.00	179520.00	INR One Lakh Seventy Nine Thousand Five Hundred & Twenty Only
6.04	7.18: Extra for using size above 200x300mm in glazed tiles and/or using 400mm x 400mm MAT finished tiles in place of 300mm x 300mm size (10%)	1250.000	Sqm	74.80	93744.00	INR Ninety Five Thousand Seven Hundred & Forty Four Only
6.05	CHAPTER : B-10 ROOFING					

Sl. No.	Item Description	Quantity	Units	Estimated Rate Inclusive taxes in Rs. P	TOTAL AMOUNT Without Taxes in Rs. P	TOTAL AMOUNT inclusive taxes in Words
6.06	10.3: Providing and fixing calcium silicate board false ceiling at all heights including providing and fixing of frame work made of special sections powder pressed from M.S. sheet and galvanised in accordance with zinc coating of grade 350 as per IS : 277 and consisting of angle cleats of size 25mm wide x 1.6mm thick with flanges of 22mm and 37mm at 1200mm centre to centre one flange fixed to the ceiling with dash fastener 12.5mm dia-10mm long with 6mm dia bolts to the angle hangers of 25x25x0.55mm of required length. And other end of angle hanger being fixed with nut and bolts to G.I. channels 45x15x0.3mm running at the rate of 1200mm centre to centre to which the ceiling section flanges of 28mm thick bottom wedge of 50mm with tapered 0.5mm centre to centre shall be fixed in a direction perpendicular to G.I. channel with connecting clips made out of 2.5mm dia-230mm long G.I. wire at every 1200mm including fixing the calcium silicate board with ceiling section and perimeter channels 0.5mm thick 27mm high having flanges of 20mm and 30mm long, the perimeter of ceiling fixed to wall/partition with the help of rawl plugs at 450mm centre to centre with 25mm long drive-all screws @ 230mm interval including jointing and fixing to a flush finish of tapered and square edges of the board with recommended filler, jointing tapes, finisher and two	320.040	Sqm	1025.00	328000.00	INR Three Lakh Twenty Eight Thousand Only
6.07	10.30.2: 6 mm thick					
6.08	CHAPTER : B-13 REPAIRS TO BUILDING					

Sl. No.	Item Description	Quantity	Units	Estimated Rate Inclusive taxes in Rs. P	TOTAL AMOUNT Without Taxes in Rs. P	TOTAL AMOUNT Inclusive taxes in Words
6.09	13.29: Repair to damaged RCC slabs, beams and columns etc for strengthening with cement mortar 1:2 in following steps: - (i) Chipping loose and cracked concrete to required depth, cleaning the exposed surface of steel and concrete with wire brush and sand papering, cleaning of concrete surface with water as necessary and getting dried. (ii) Applying Epoxy primer on the exposed steel bars. (iii) Applying Epoxy hardener and resin mix (as per manufacturer's specification) on concrete and steel bars with brush. (iv) Spreading dry cement mortar 1:2 mix over epoxy treated wet surface and allow it to dry for one day. (v) Plastering the surface with cement sand mortar 1:3 upto depth of 30mm complete. (vi) Cure the plastered surface for 15 days. All work including scaffolding etc. complete in all respect.	200.000	Sqm	1569.00	313600.00	INR Three Lakh Thirteen Thousand Six Hundred Only
6.10	13.34: Making of hole in R.C.C. slab/wall/beams and masonry wall (width up to 450 mm) by core cutting machine complete as per direction of EI					
6.11	13.34.1: From diameter 100mm to 150mm	400.000	Nos.	1107.00	442800.00	INR Four Lakh Forty Two Thousand Eight Hundred Only
6.12	CHAPTER : 9-14 DISMANTLING & DEMOLISHING WORK					
6.13	Note : All items of demolition & dismantling of building shall be conform to IS 4130 for handling, IS 7989 for storage and IS 3696 for scaffolding.					
6.14	14.23: Dismantling like work in floors and roofs laid in cement mortar including stacking of salvageable material and disposal of unserviceable material within 50 meter lead.					
6.15	14.23.1: For thickness of tiles 10mm to 25mm.	1200.000	Sqm	20.00	25000.00	INR Twenty Five Thousand Six Hundred Only
Total in Figures					26462130.40	INR Two Crore Sixty Four Lakh Sixty Two Thousand One Hundred & Ninety and Paise Forty Only
Quoted Rate in Figures			Select		0.00	INR Zero Only
Quoted Rate in Words					INR Zero Only	

Percentage BoQ: RUIDP ISOR 2023

Tender Inviting Authority:

Name of Work: Removing of Dry Sandstone Cladding, doing Plaster on removed surface and Painting Work on exterior wall face of Civil Lines Metro Station, fixing of low voltage pipe work from viaduct to ground level, Construction of boundary wall at NAMT metro station and other miscellaneous repair works from ISOR to BICP of Jaipur Metro.

Contract No: 78/JMRCO&S/Civil/Works/2023-24

Name of the
Bidder/ Bidding
Firm /
Company :

PRICE SCHEDULE

(This BOQ template must not be modified/replaced by the bidder and the same should be uploaded after filling the relevant columns, also the bidder is liable to be rejected for this tender. Bidders are allowed to enter the Bidder Name and Values only.)

NUMBER #	TEXT #	NUMBER #	TEXT #	NUMBER #	NUMBER #	NUMBER #	TEXT #	NUMBER #	NUMBER #	NUMBER #	TEXT #
Sl. No.	Item Description	Quantity	Units	Estimated Rate Inclusive taxes	Without Taxes	In P	Rs.	In P	Rs.	TOTAL AMOUNT In Words	TOTAL AMOUNT inclusive taxes
1.00	2	4	5	6	6	6	6	6	6	55	55
1.00	Part F: Estimate for the works of Providing and fixing of Drainage pipes from track slab to Crash barrier along the piers of Viaduct from P14-P19c including Double Deck Corridor, Art Gallery as well as Siltation Painting Works ISOR to CDPE										
1.01	RUIDP ISOR 2023 Items.										
1.02	33.48: Dispersing with oil bound washable distemper of approved brand and manufacture to give an even shade.										
1.03	33.48.1: Old work (one or more coats)	112500.00	Sqm	45.70						5141250.00	INR Fifty One Lakh Forty One Thousand Two Hundred & Fifty Only
Total in Figures										5141250.00	INR Fifty One Lakh Forty One Thousand Two Hundred & Fifty Only
Quoted Rate in Figures										0.00	INR Zero Only
Quoted Rate in Words										INR Zero Only	

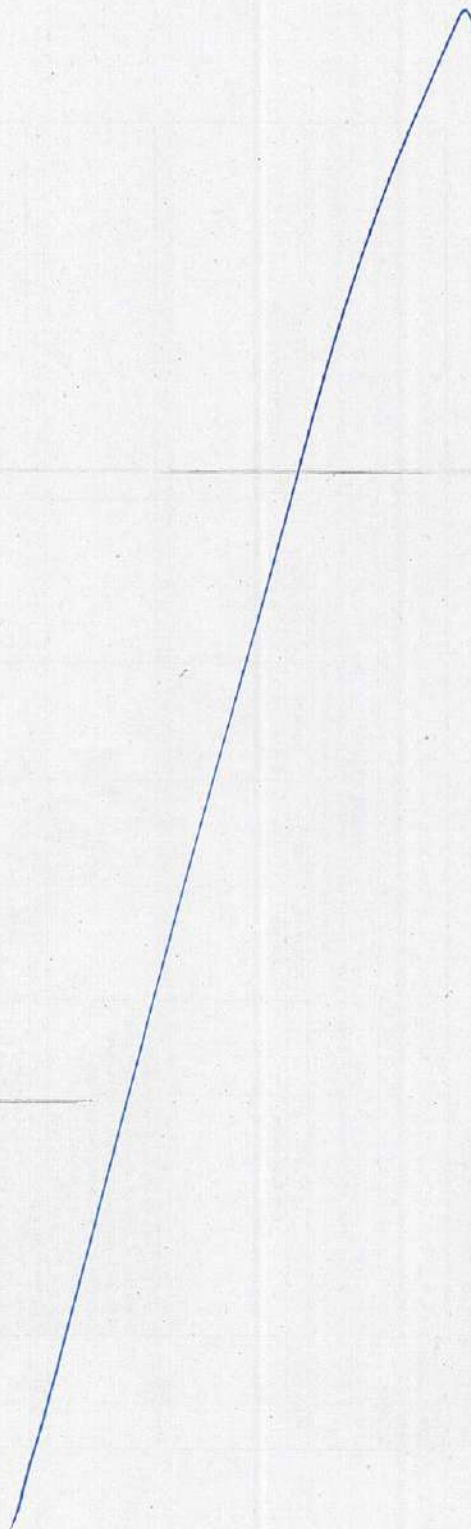

SIGNAGE FABRICATION DRAW

PACKA
MANSAROVARS
NEW AATISH MARKET S
VIVEK VIHAR S
SHYAM NAGAR S
RAM NAGAR S
CIVIL LINES S



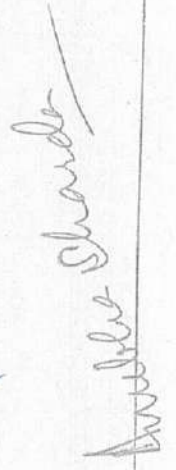



What's New?

Standard panel class	panel nu
Cap height	cap
As per	As per
Artwork	Artwork

Exploited women

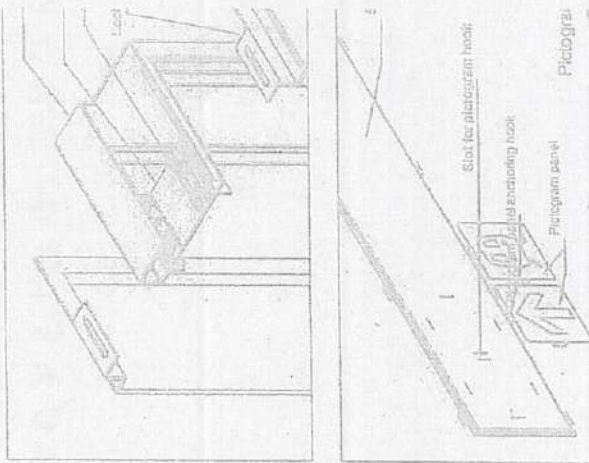
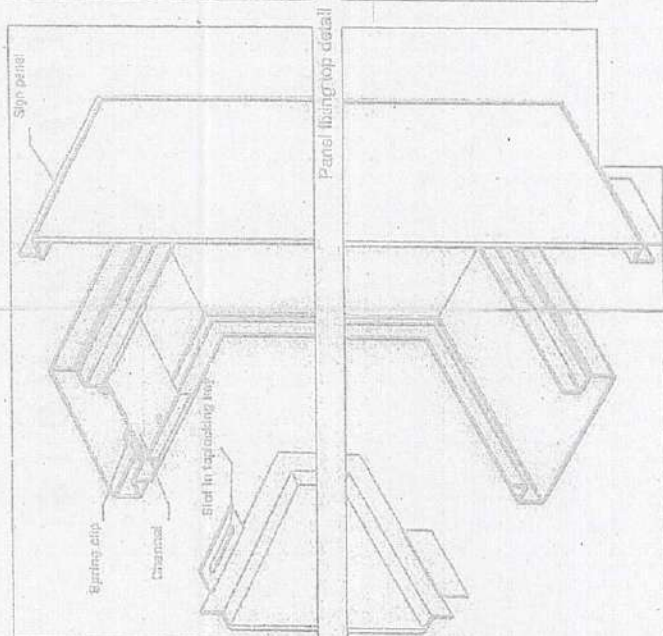
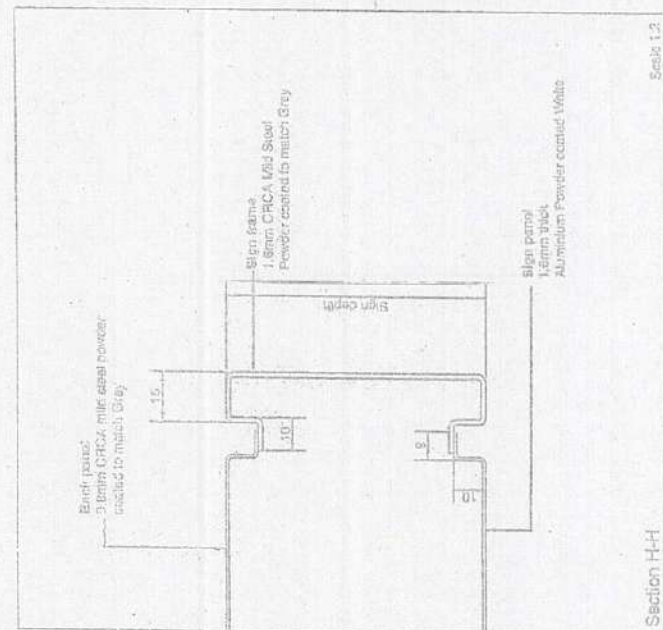
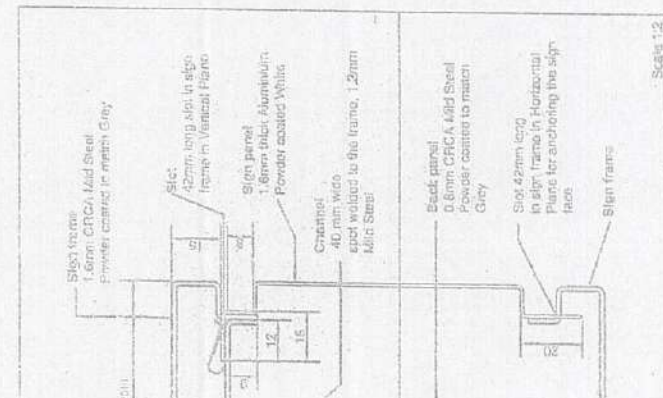

2nd

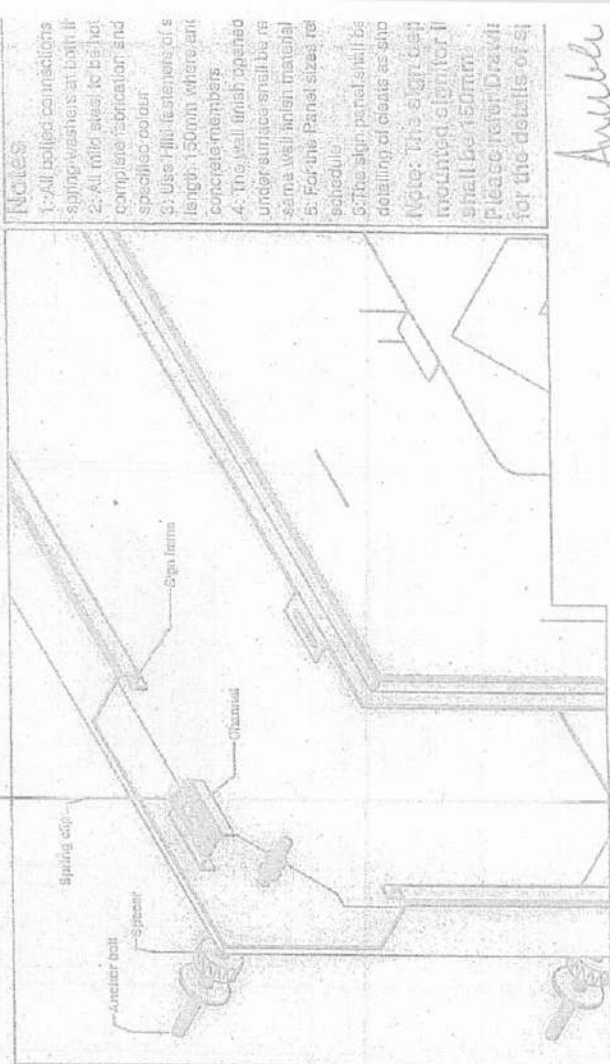

10/10/1941

Aruba

Scale 12

Detail-1

Scale 12

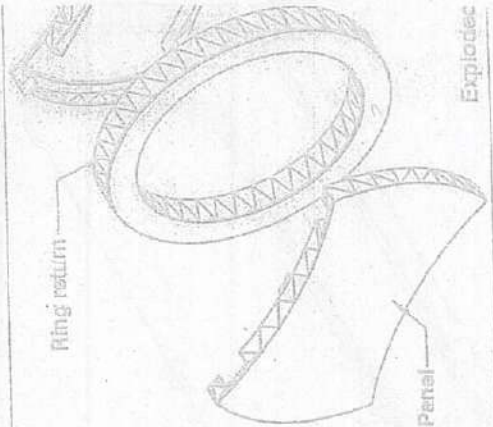
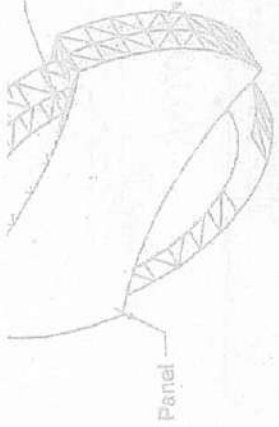

Explosion

Handwritten signatures and notes:
 10/2/12
 10/2/12

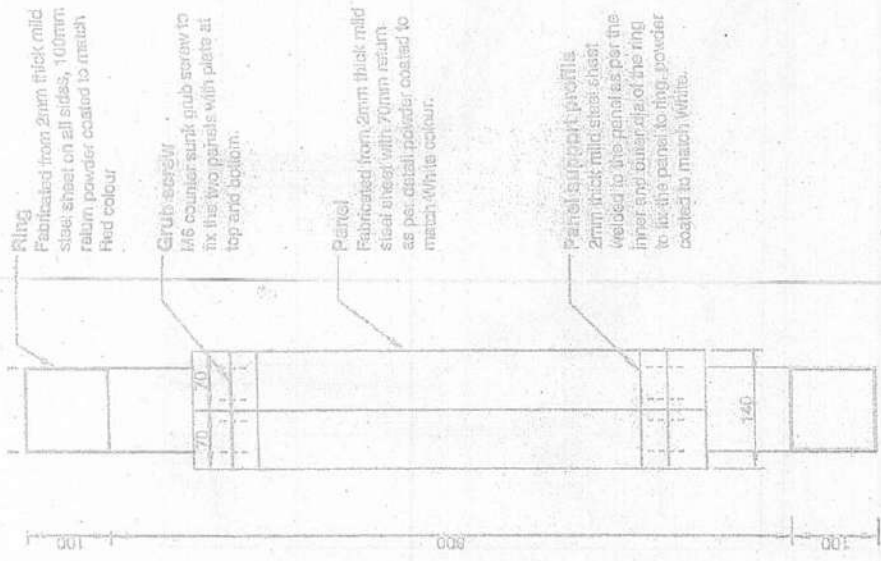

Scale 1:20

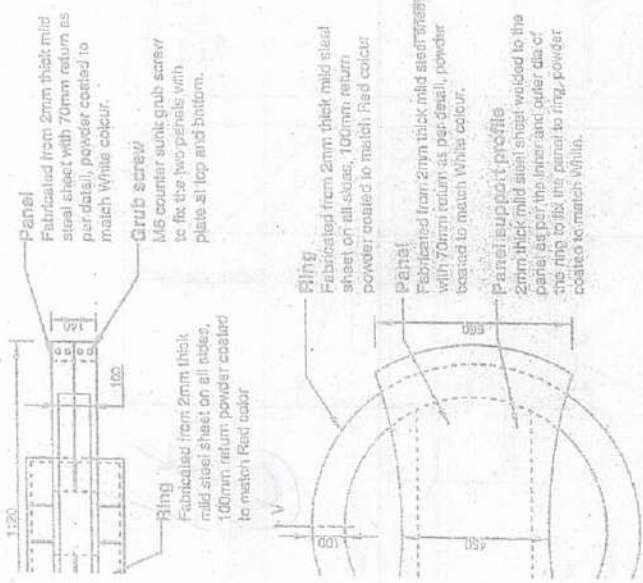

Handwritten signature:

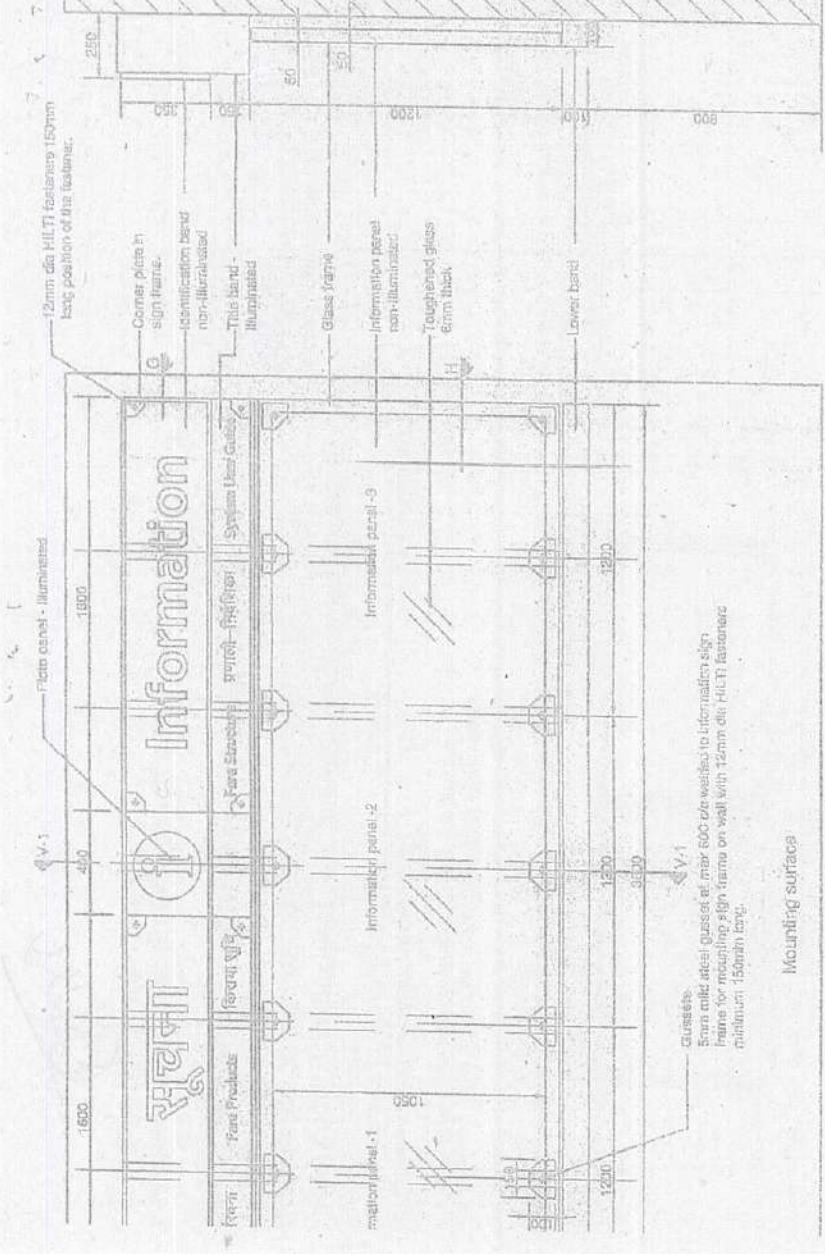

Side elevation

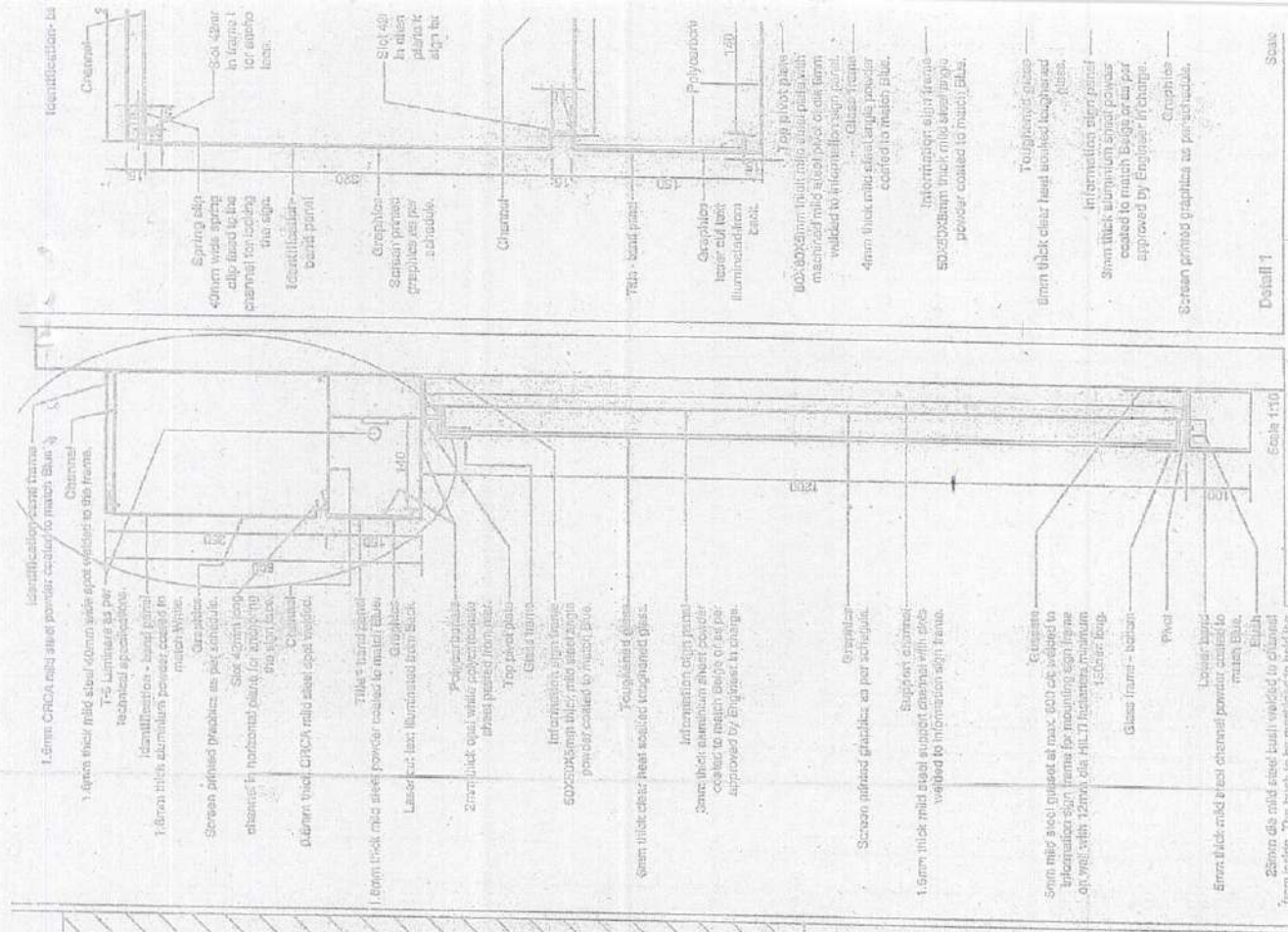
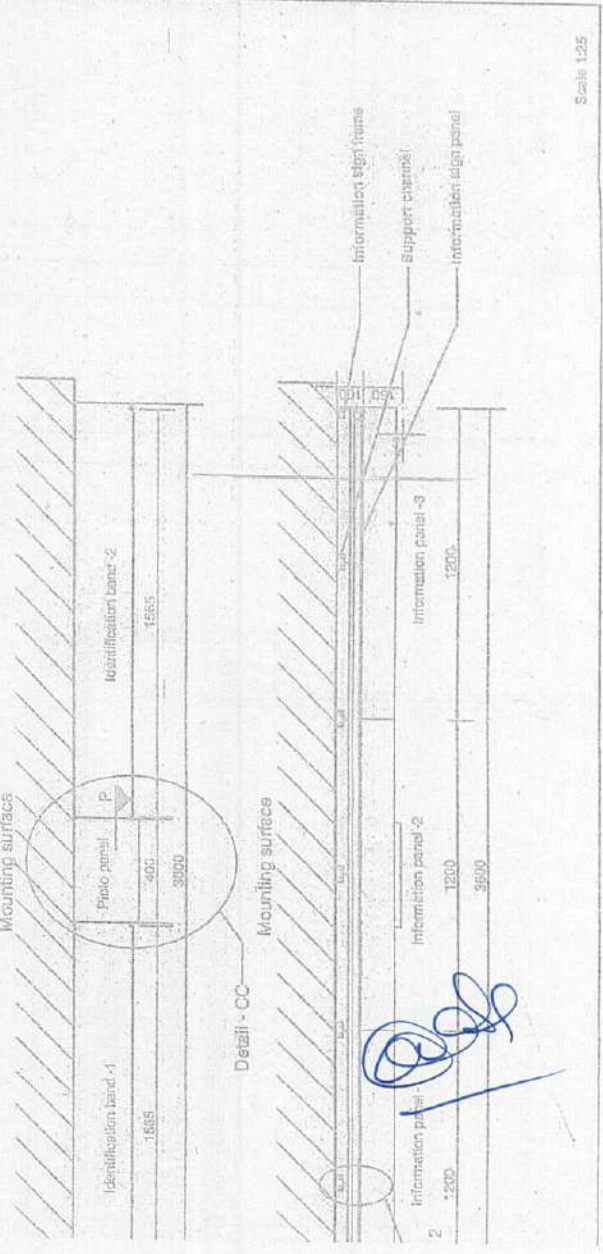

Section V-V

Scale 1:25

Detail 1

Scale

Handwritten signature: *Kumble*

Handwritten initials: *SP*

Handwritten note: *12mm dia HILTI fasteners 150mm base position of the fasteners.*

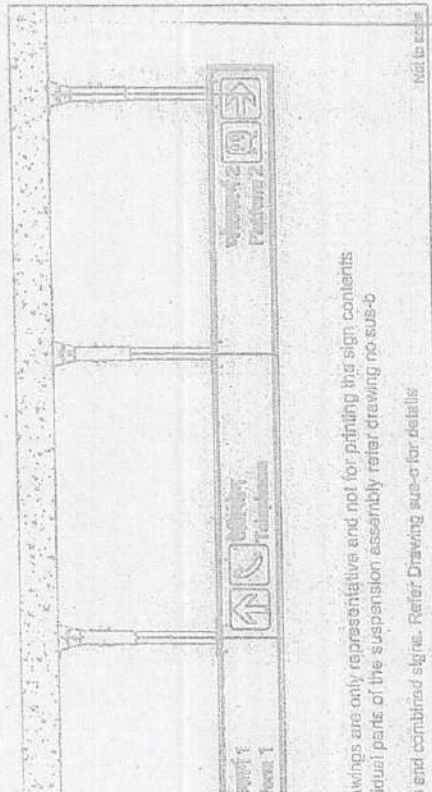
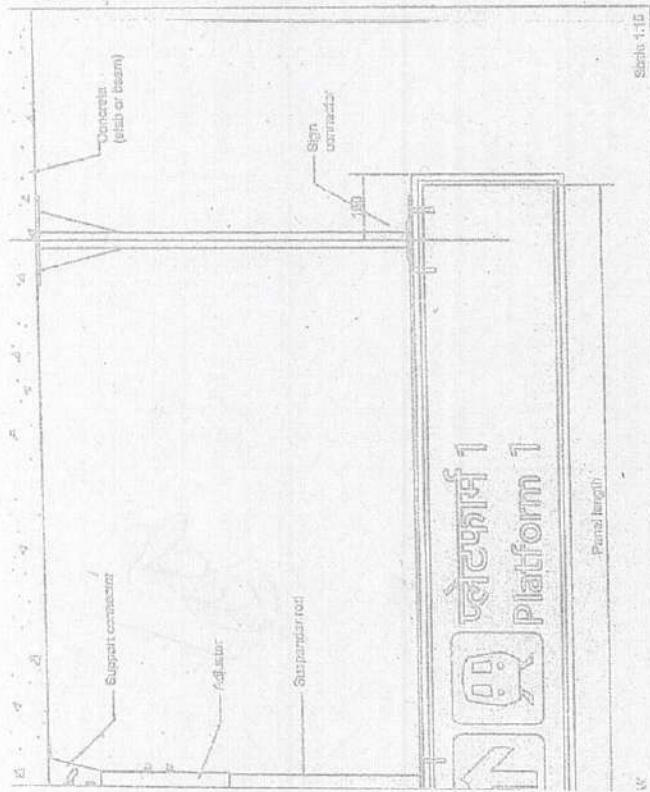

Wings are only representative and not for printing the sign contents
Individual parts of the suspension assembly refer drawing no sus-b
and combined sign. Refer Drawing sus-c for details

If steel beam or truss members suitable fixing arrangement is
provided by the contractor using the Drawing number "Sus-b" to
conditions
content of structural members at site to be taken by the

on/fixing arrangement has to be approved from the employers
before fabrication is done

Signature

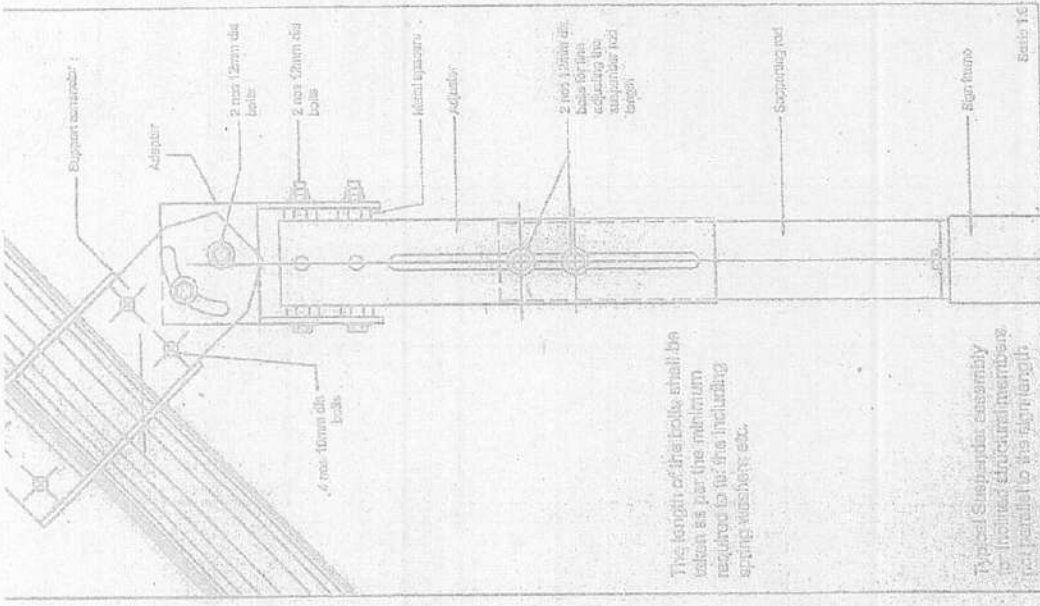
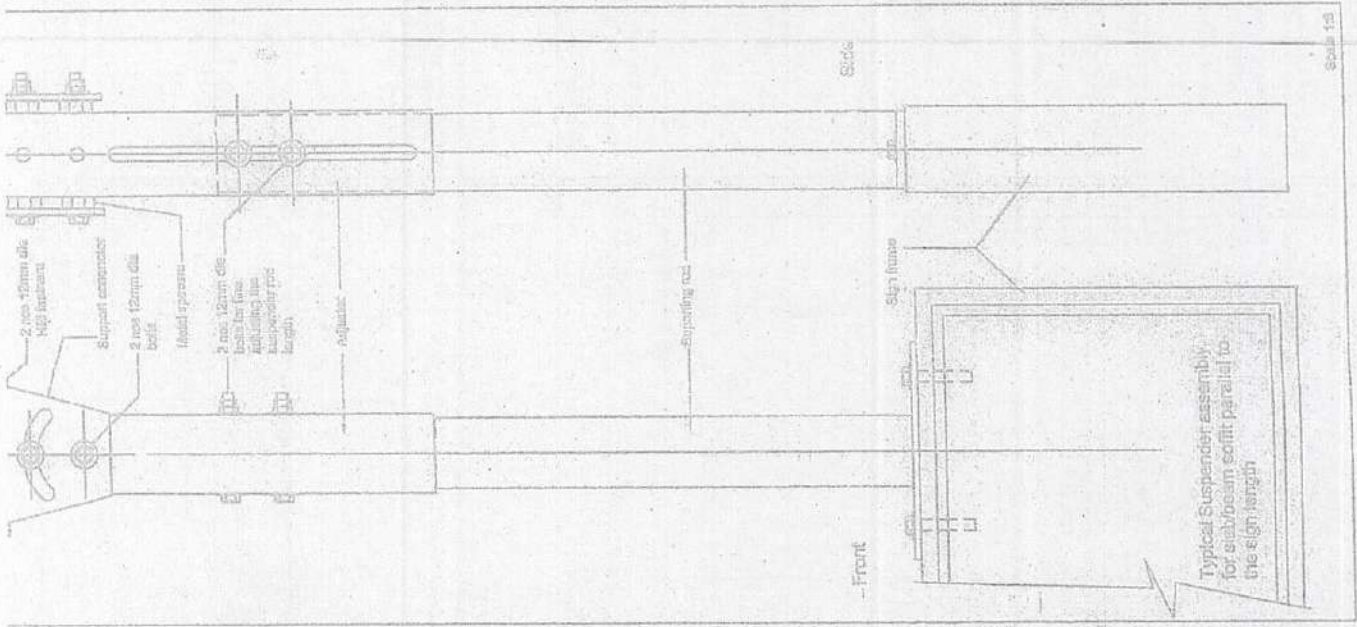

The length of the truss shall be
taken as per the minimum
required to fit the including
spring washers etc.

Typical Suspender assembly
to inclined structural members
not parallel to the sign length

Notes

1. All welded connections to be provided with fillet spring weather at both the, nut and b:
2. The entire assembly of the suspension system to be painted powder coated.
3. The Direction of the bolts facing the adjuster to the support connector shall be always a
4. For anchoring in the concrete surface use Hill fasteners as specified in the drawing.
5. All S washers to be provided for riding the adjuster to the support connector
6. All the welded connections to be provided with split pins

Signature

Signature

Signature

76.10.2018

2.5.2

2.5.2

SIGNAGE FABRICATION DRA

PACK

RAILWAY METRO
SINDHI CAMP
CHANDPOLE

[Handwritten signature]

[Handwritten signature]

[Handwritten signature]

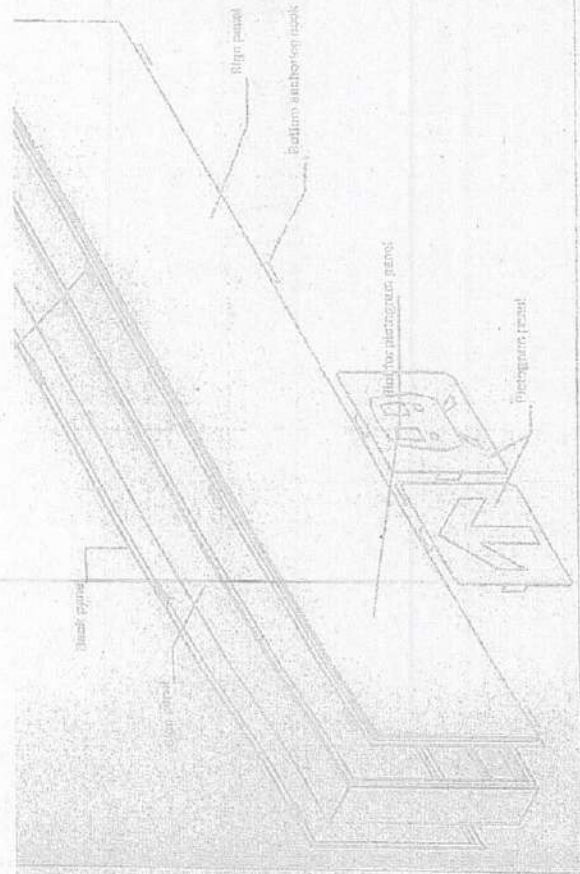

Exploded view

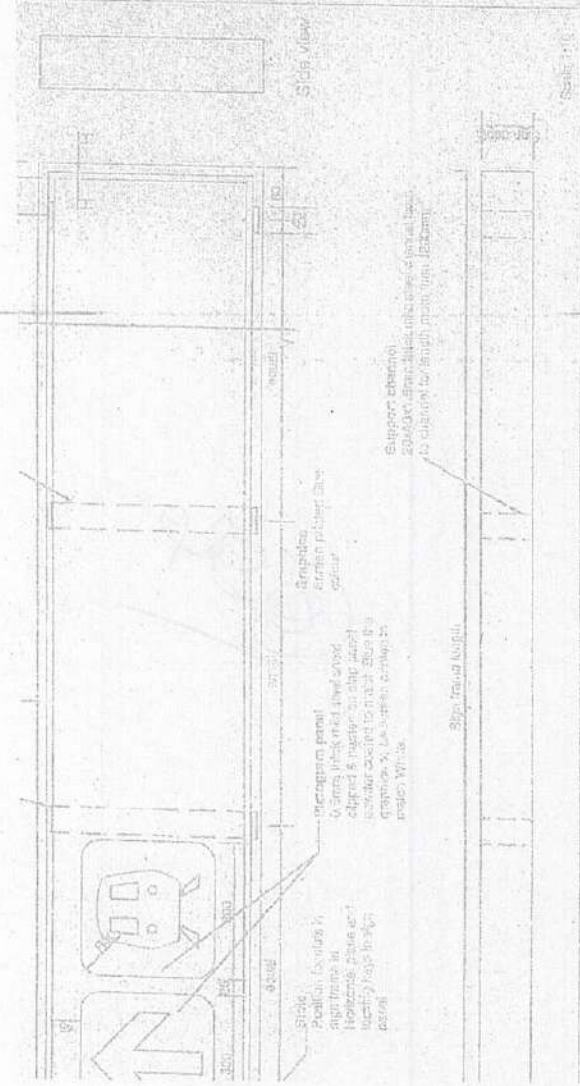

Side view

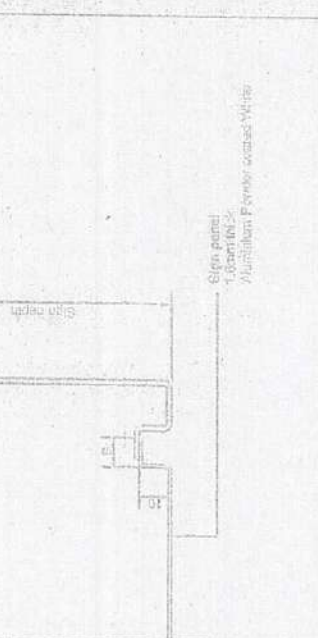
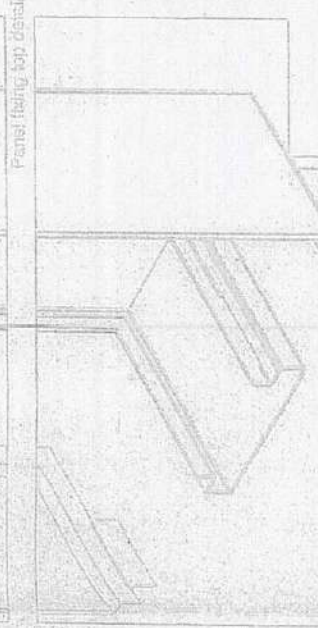
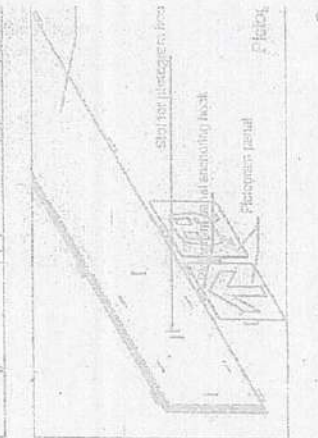
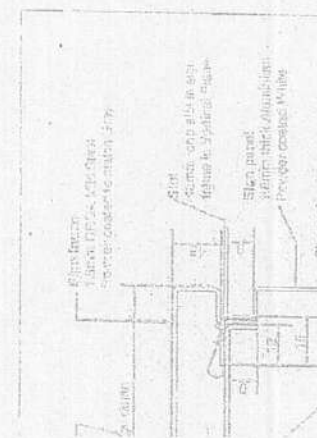
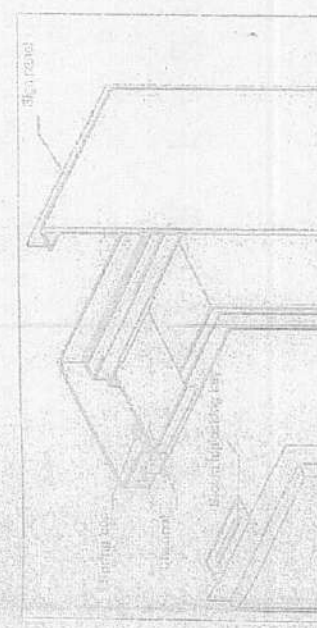
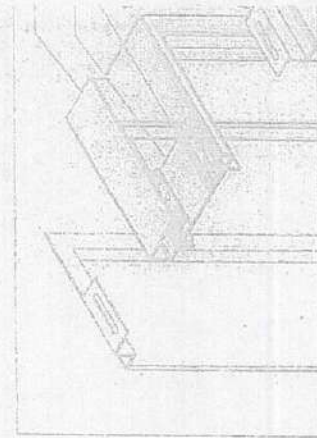

agad *Aravind*

DELHI METRO RAIL COF

DELHI METRO RAIL COF

DELHI METRO RAIL COF



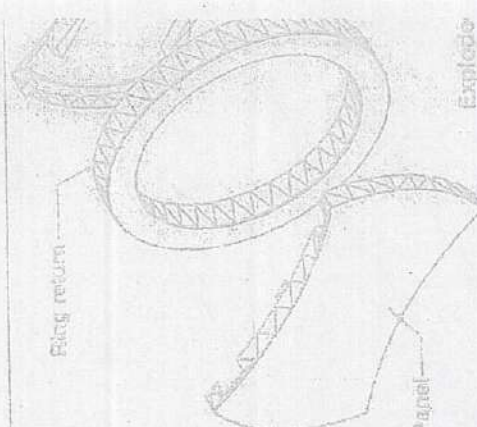

Amelb

pride

00030

Scale 1-20



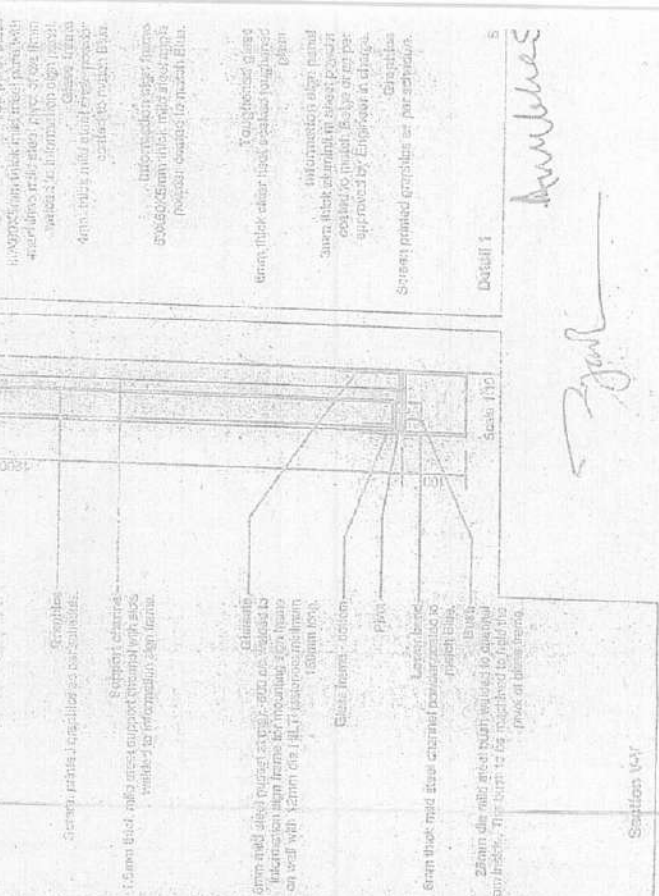
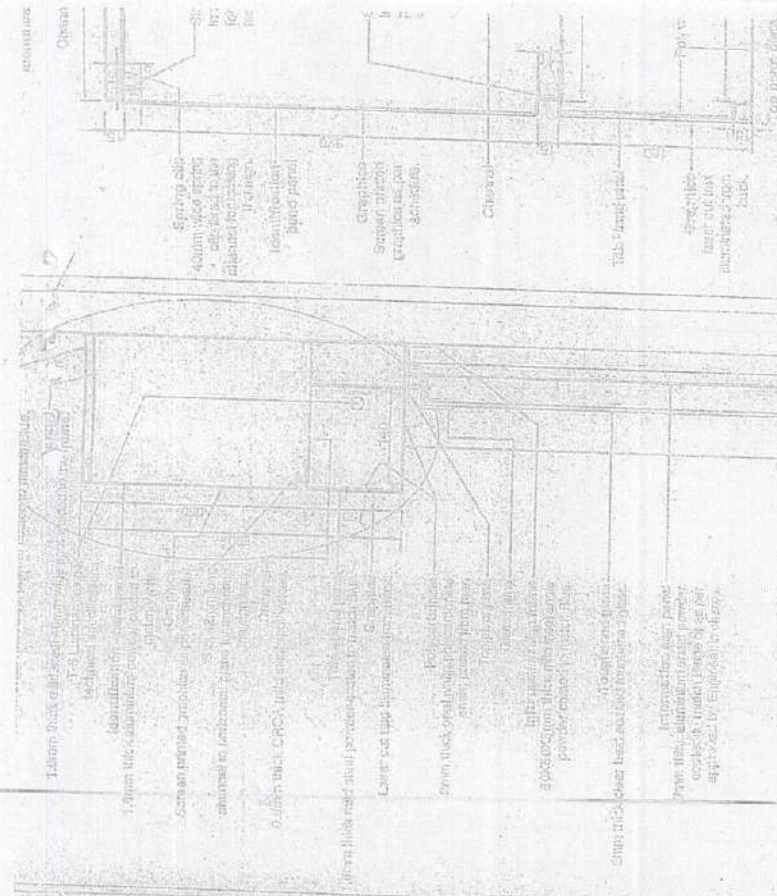
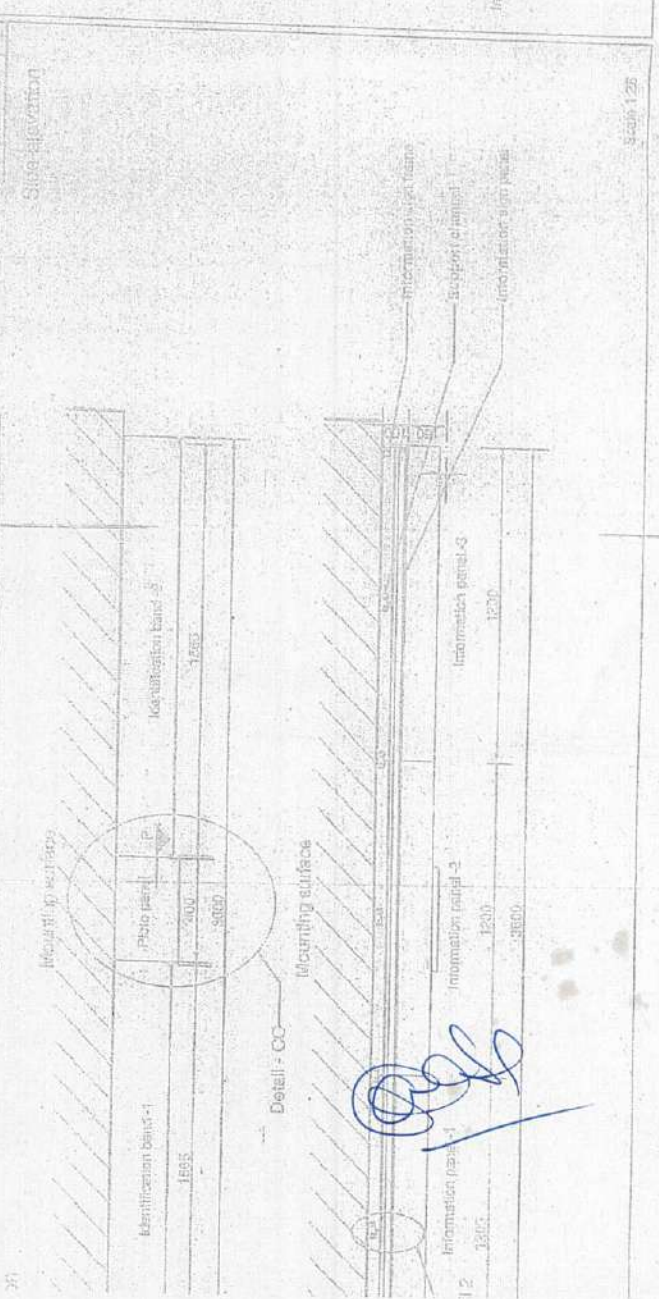
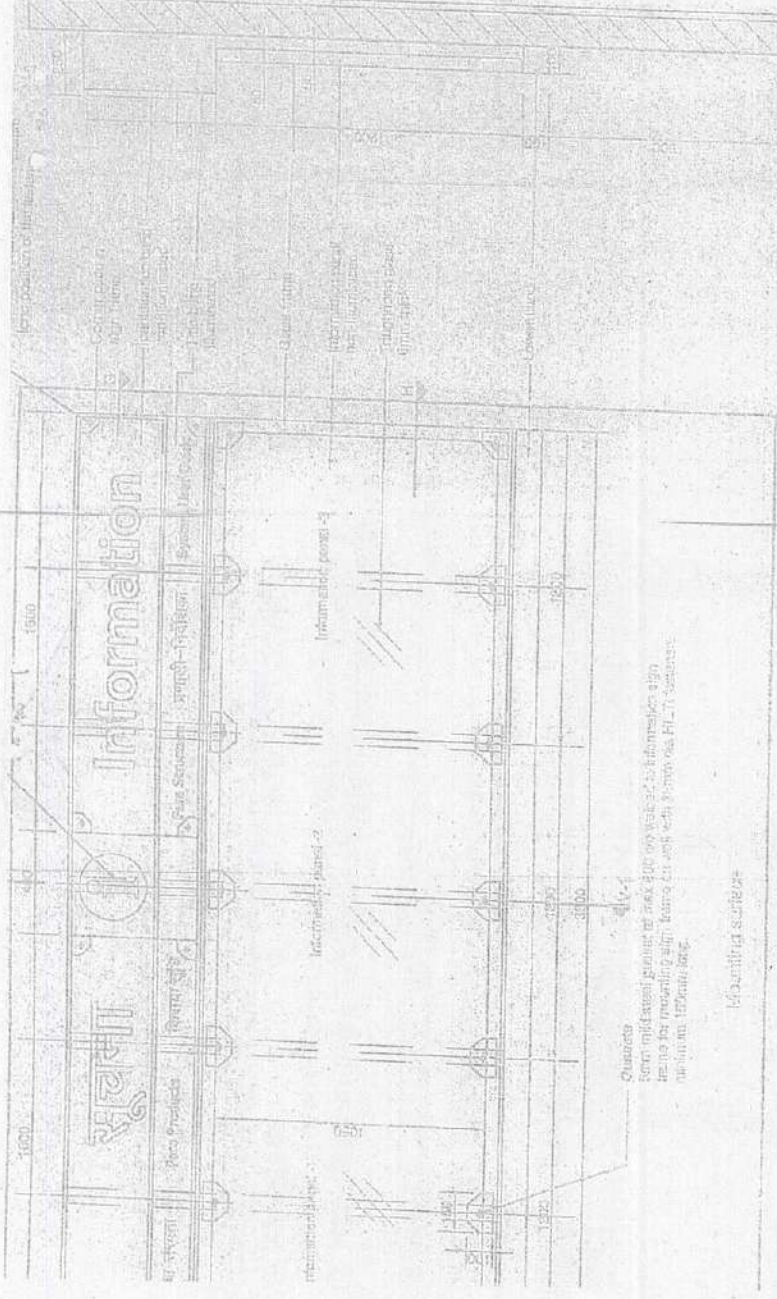

Handwritten signature

are not combined alone. Refer Drawing sheet for details



Amibae

—

100